

ORDER OF ASSEMBLY

STEP 1 : Assembly of the longitudinal girder (NWC-VBS-FAB-4041) and assembly of the cantilever outrigger box (NWC-VBS-FAB-4042)

STEP 2 : Assembly of the girder and outrigger box without bottom flange

STEP 3 : Milling the bottom of the plate after welding girder and outrigger box

STEP 4 : Welding of the lower plate of the bottom flange

STEP 5 : 2 cases possible
 -> CASE 1 : No milling of the lower plate of the bottom flange
 -> CASE 2 : Milling of the lower plate of the bottom flange

STEP 6 : Welding of the bottom flanges cross girder + close the outrigger box

REFER TO DRAWINGS

NWC-VBS-FAB-4040 : Anchorage console TR03 + TR03A - Construction - General view
 NWC-VBS-FAB-4041 : Anchorage console TR03 + TR03A - Construction - Longitudinal girder
 NWC-VBS-FAB-4042 : Anchorage console TR03 + TR03A - Construction - Cantilever outrigger box
 NWC-VBS-FAB-4043 : Anchorage console TR03 + TR03A - Lifting lugs
 NWC-VBS-FAB-4051 : Anchorage console TR03 + TR03A - Pieces 1/2
 NWC-VBS-FAB-4052 : Anchorage console TR03 + TR03A - Pieces 2/2

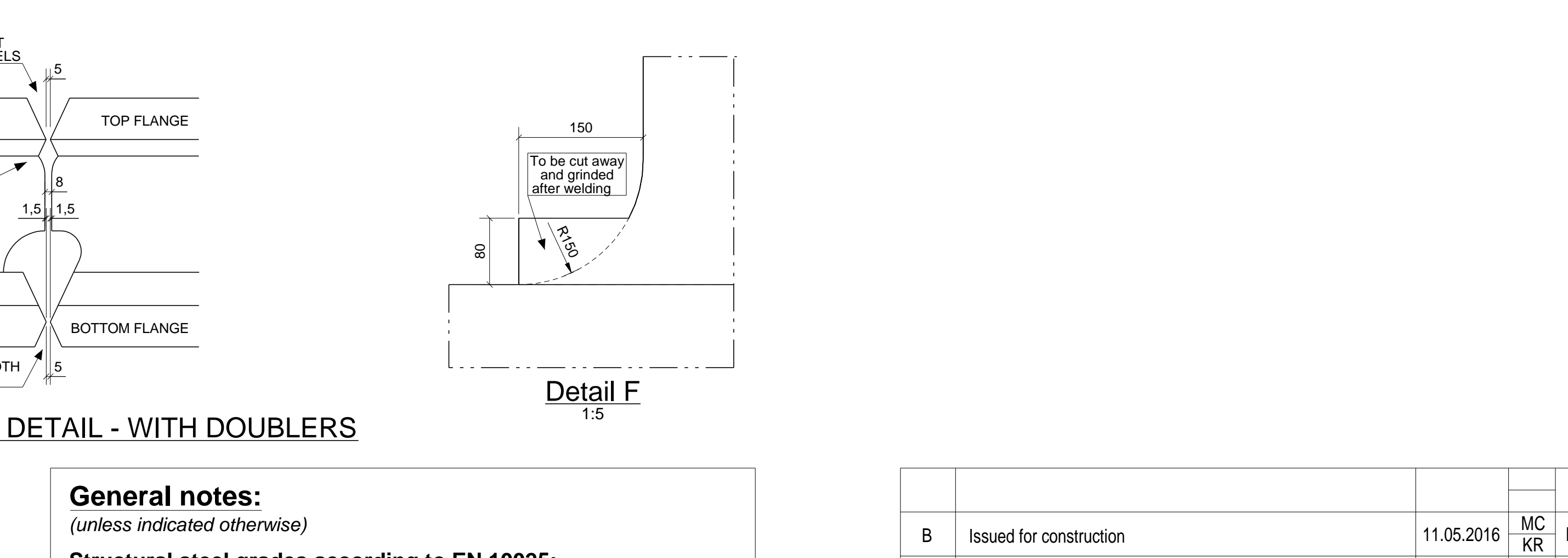
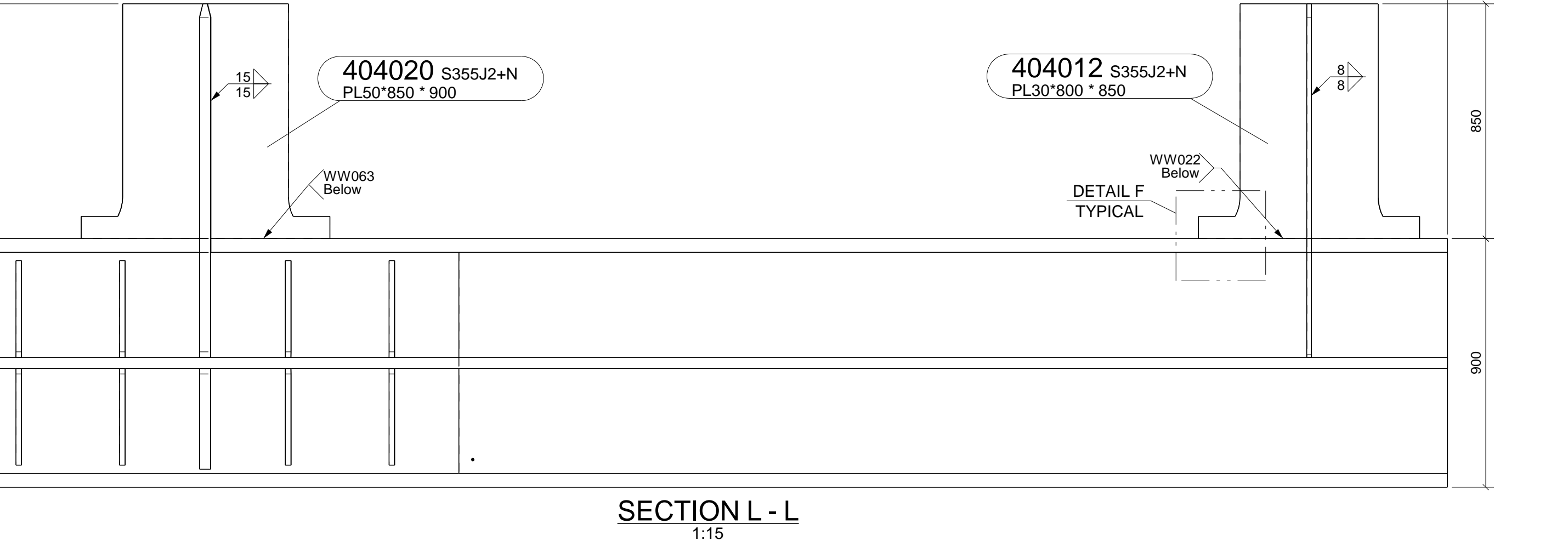
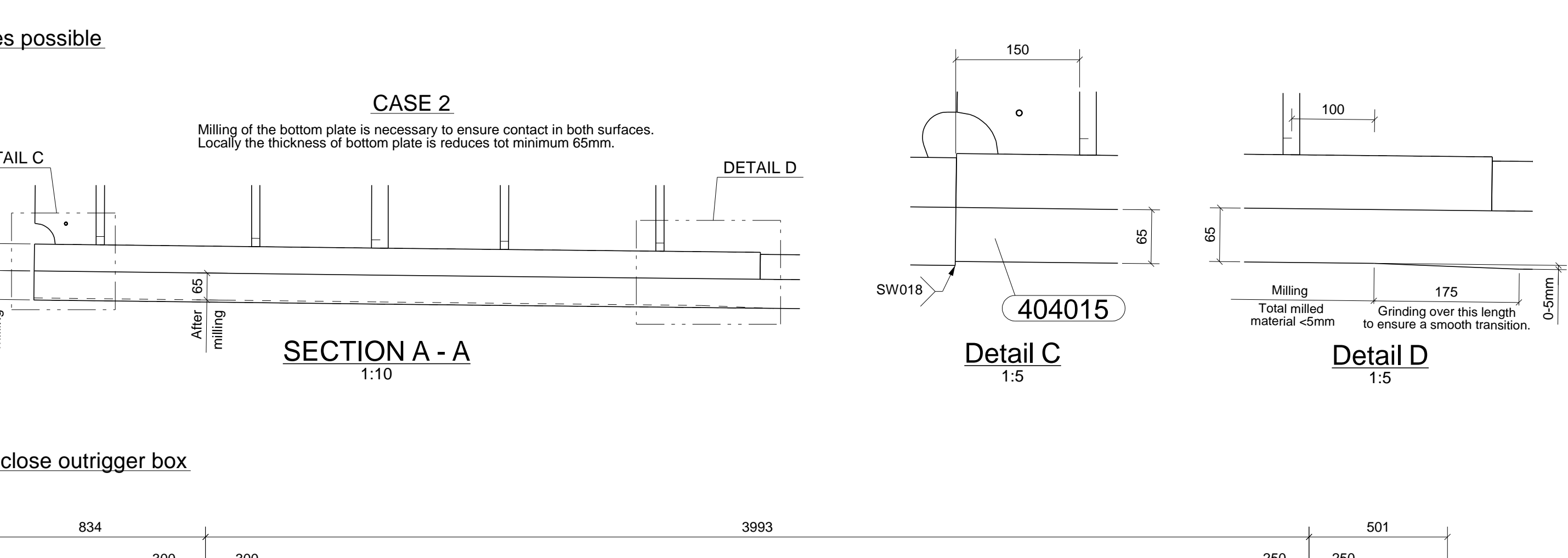
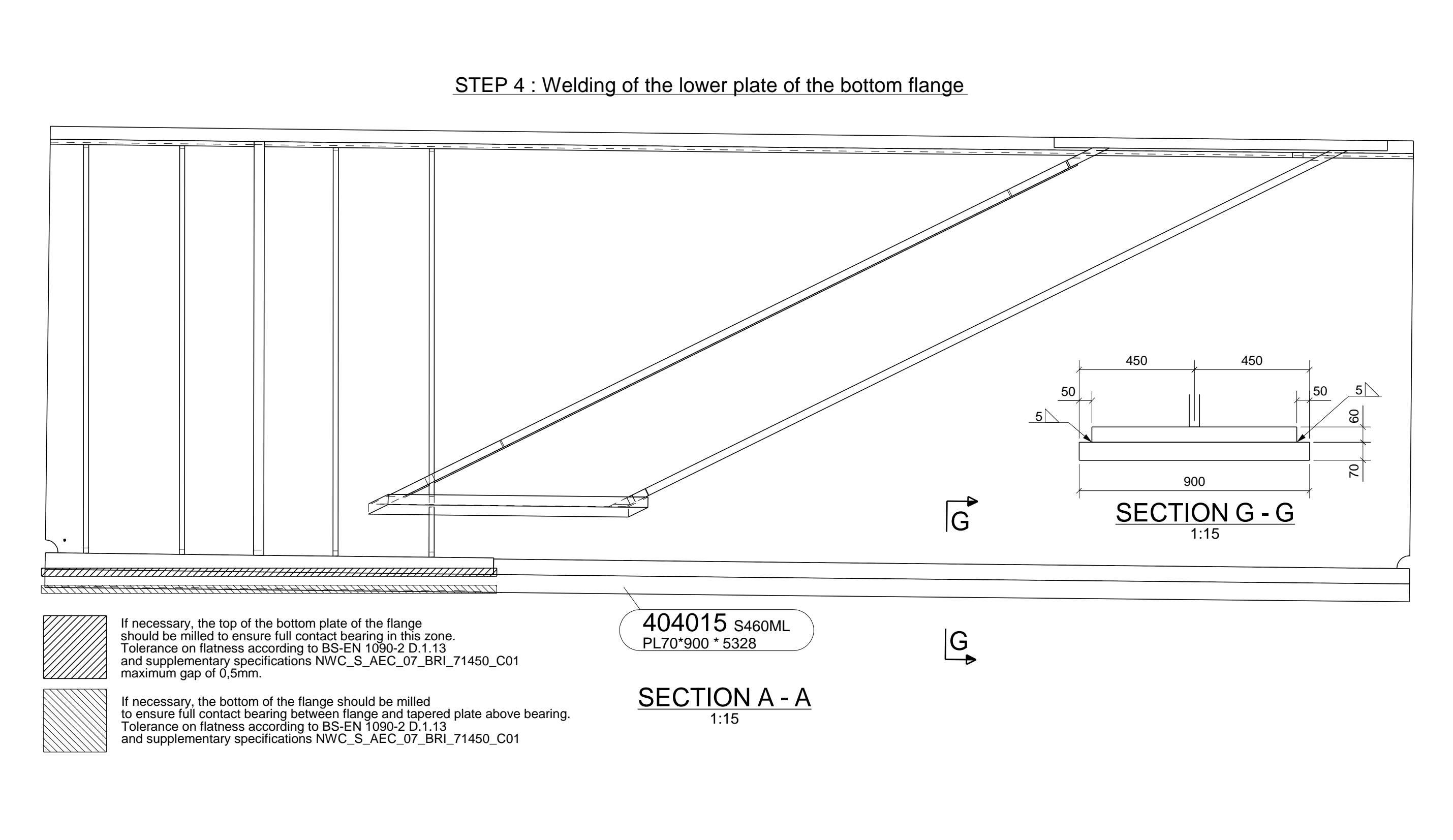
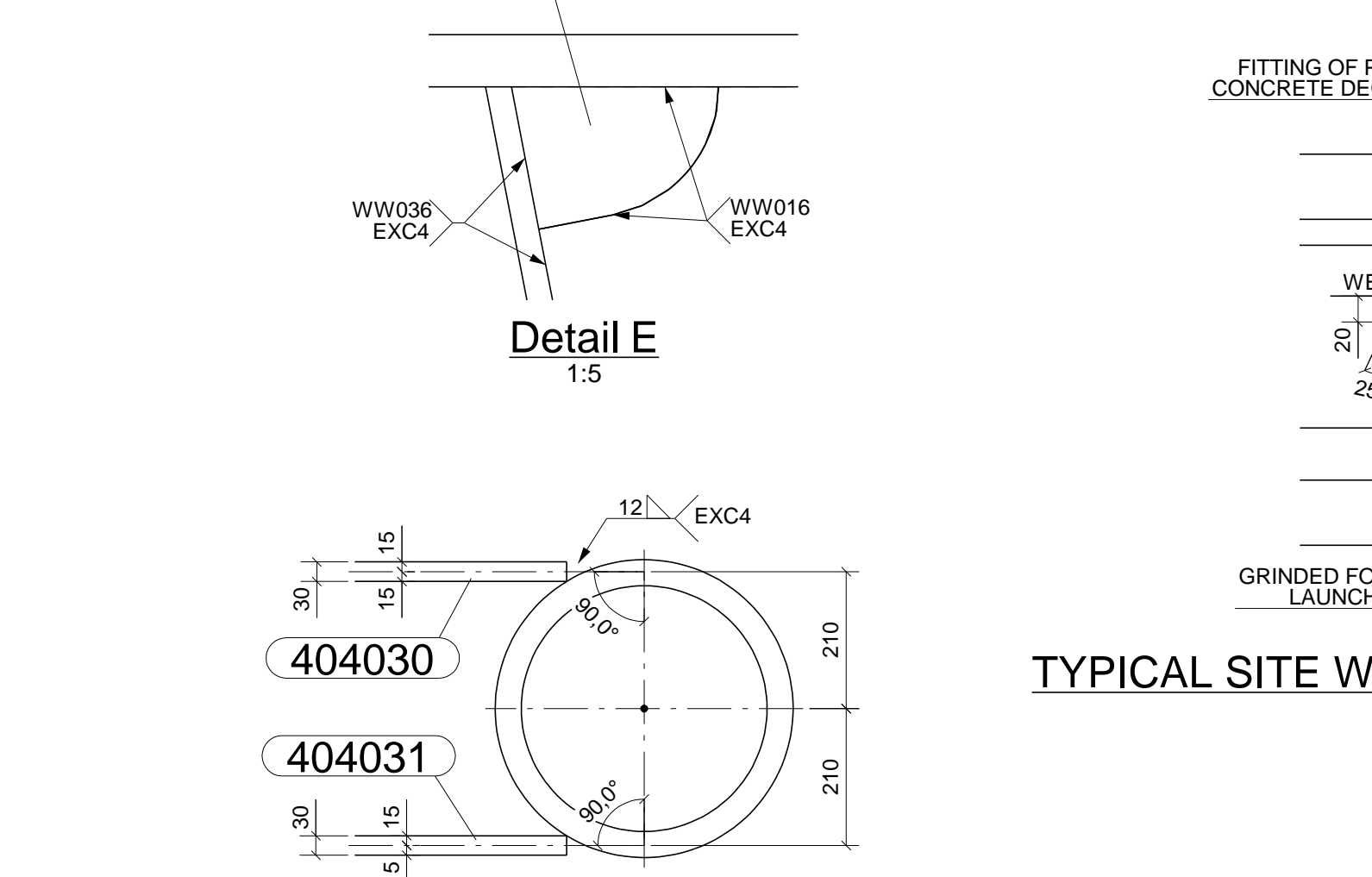
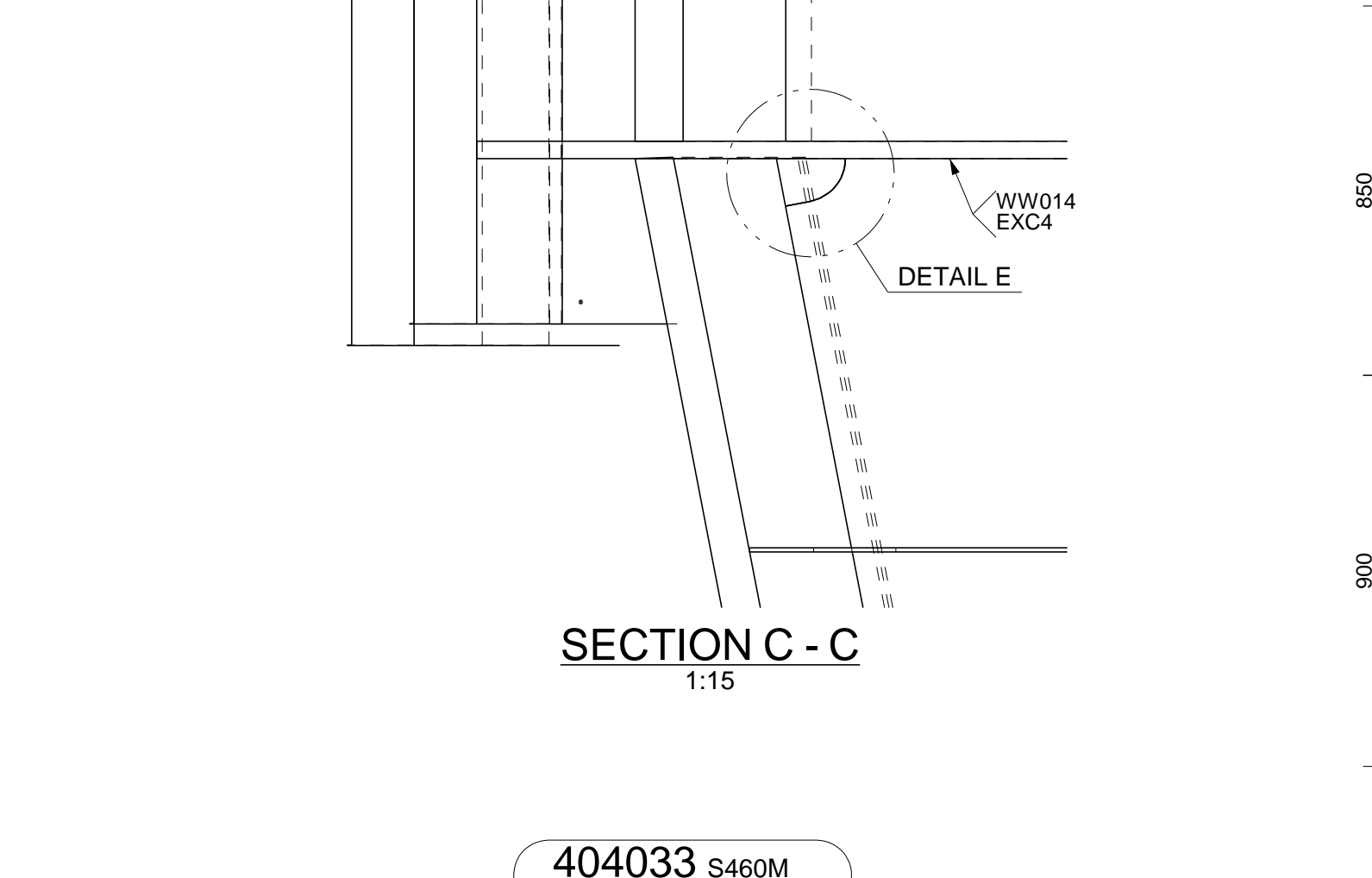
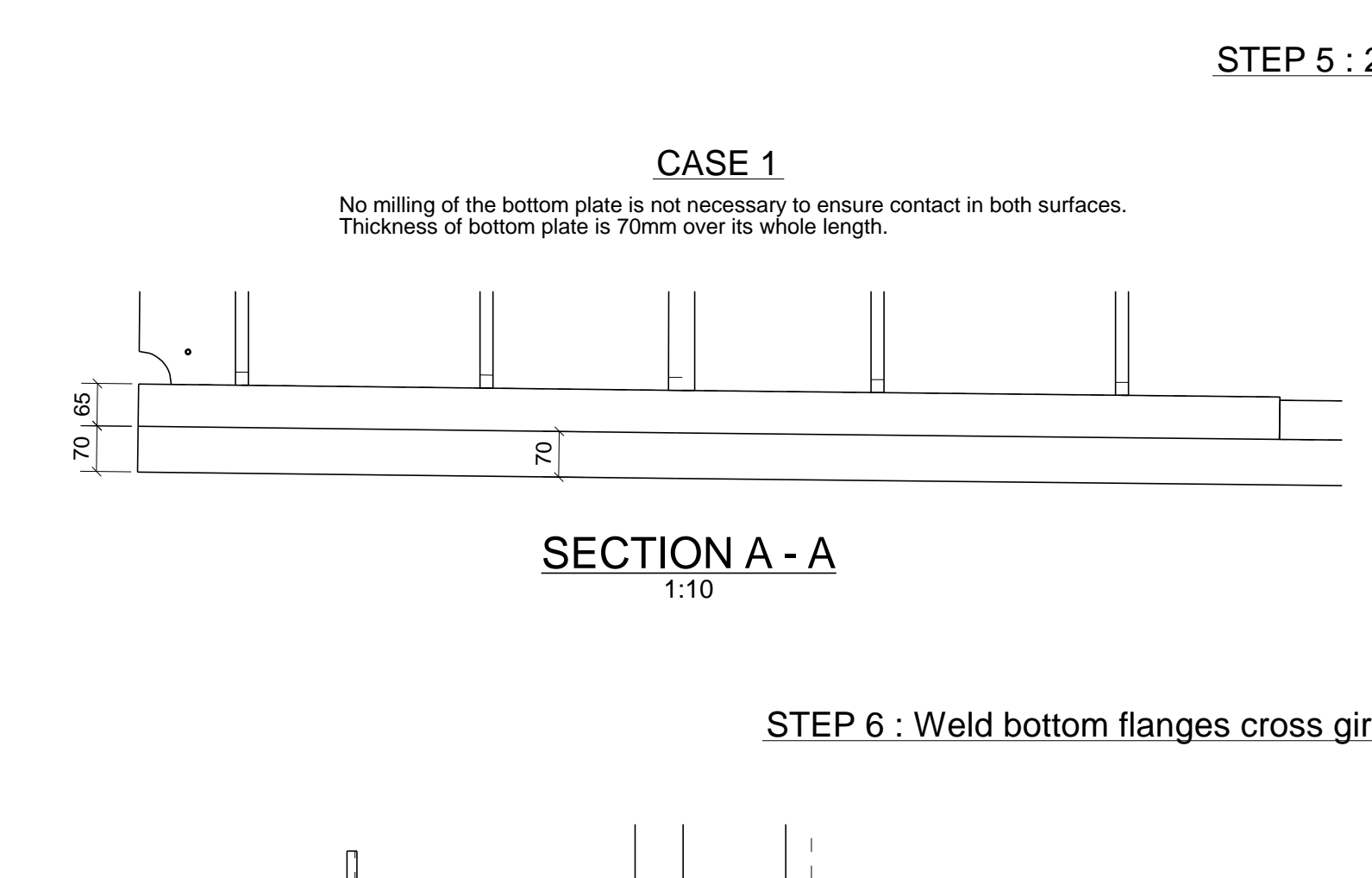
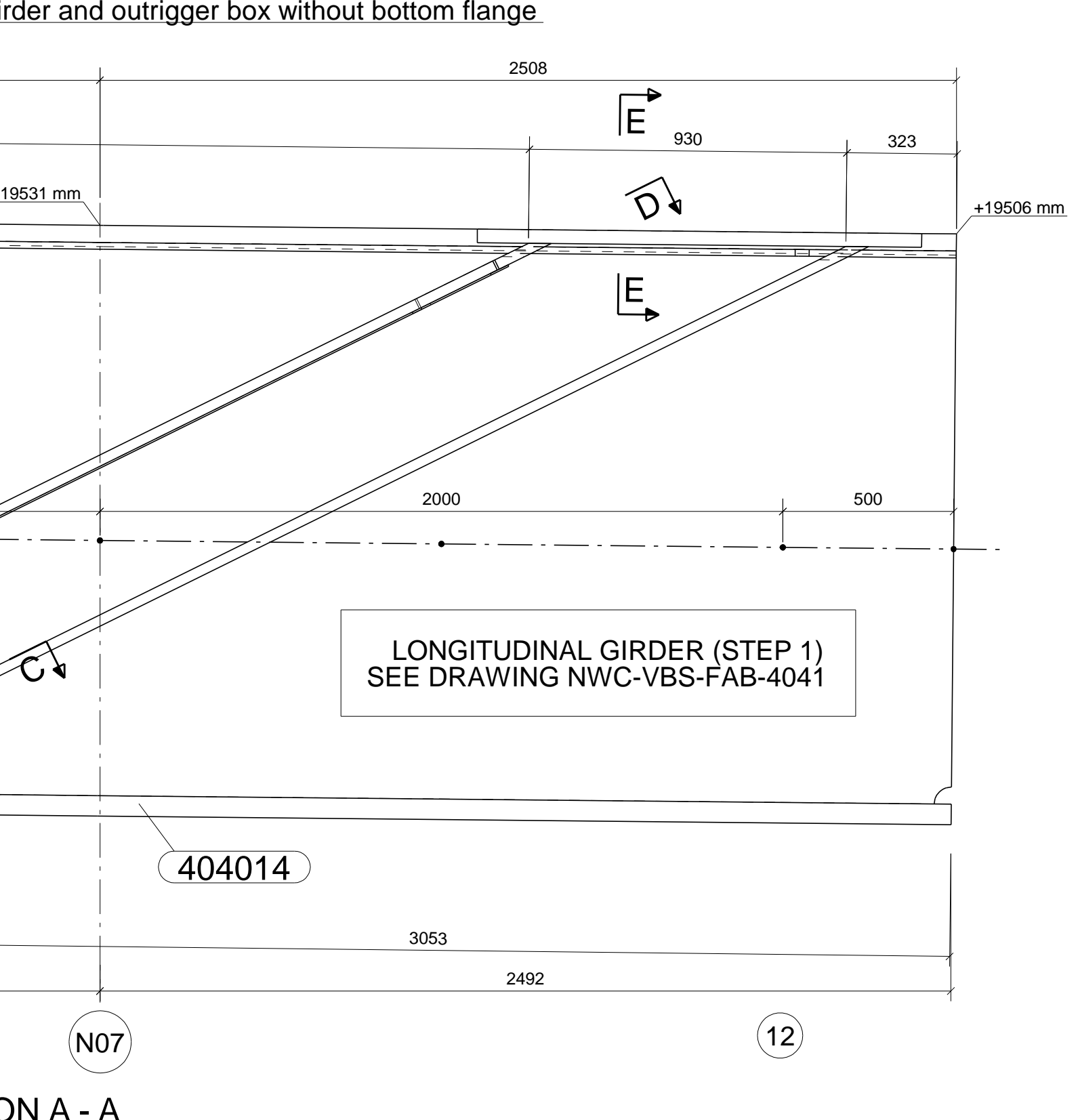
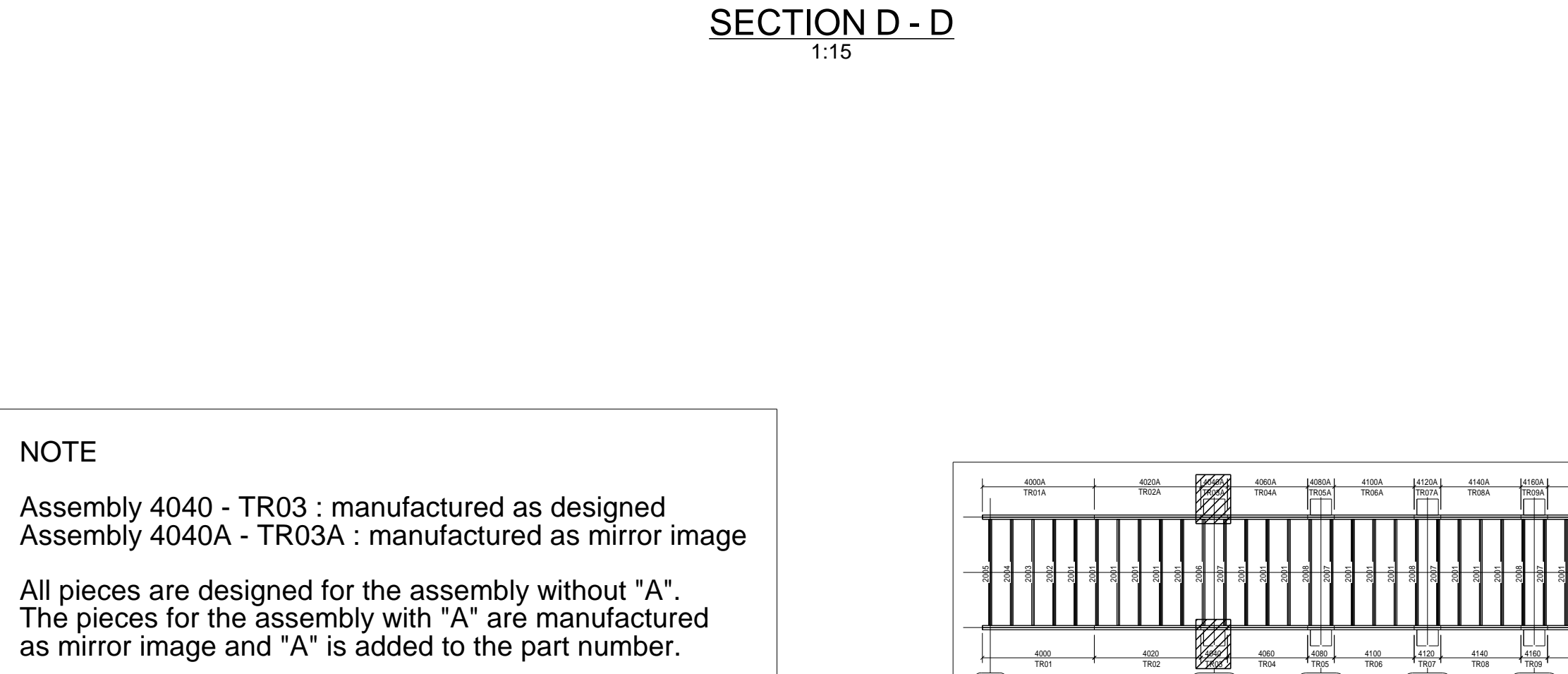
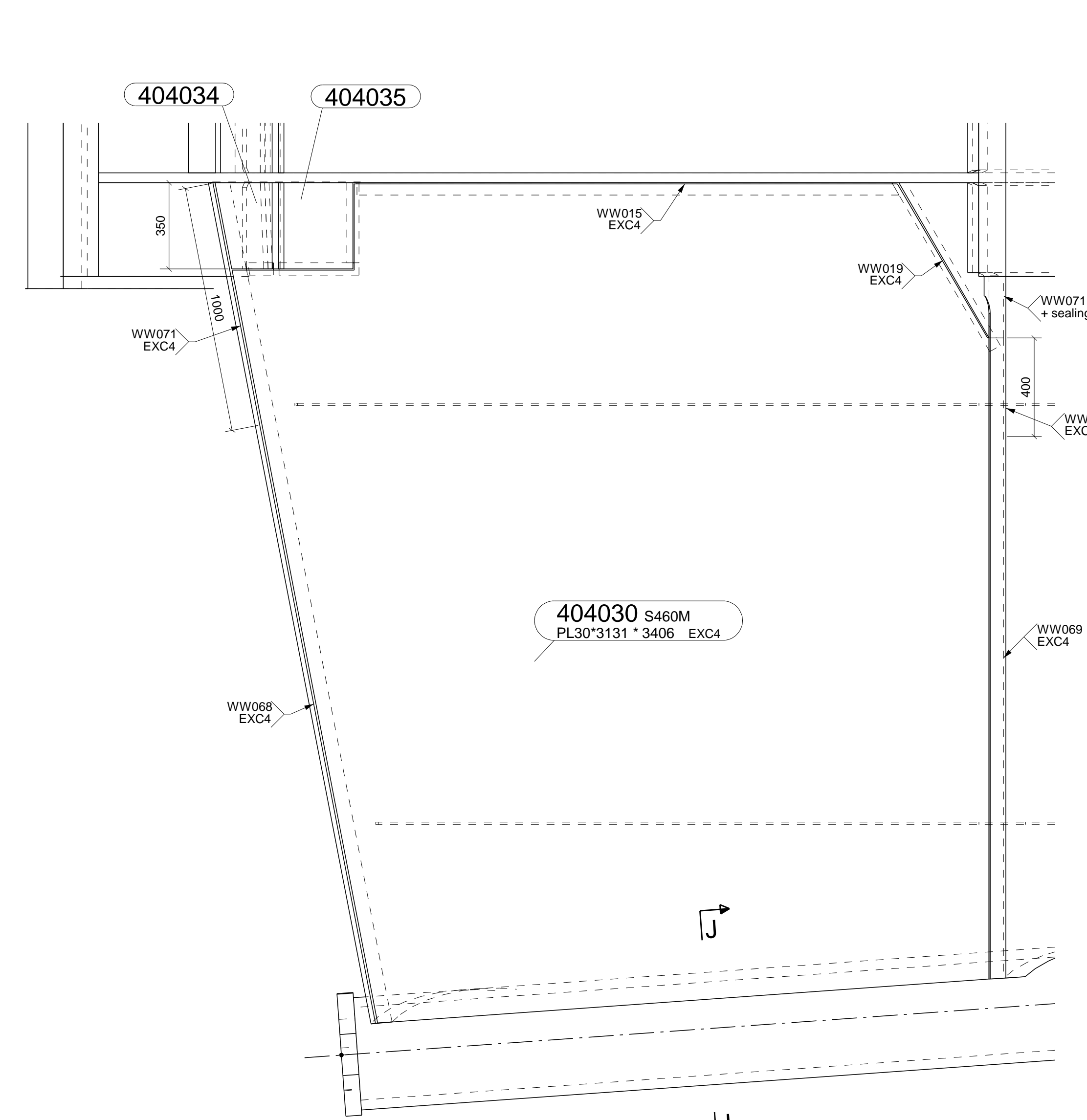
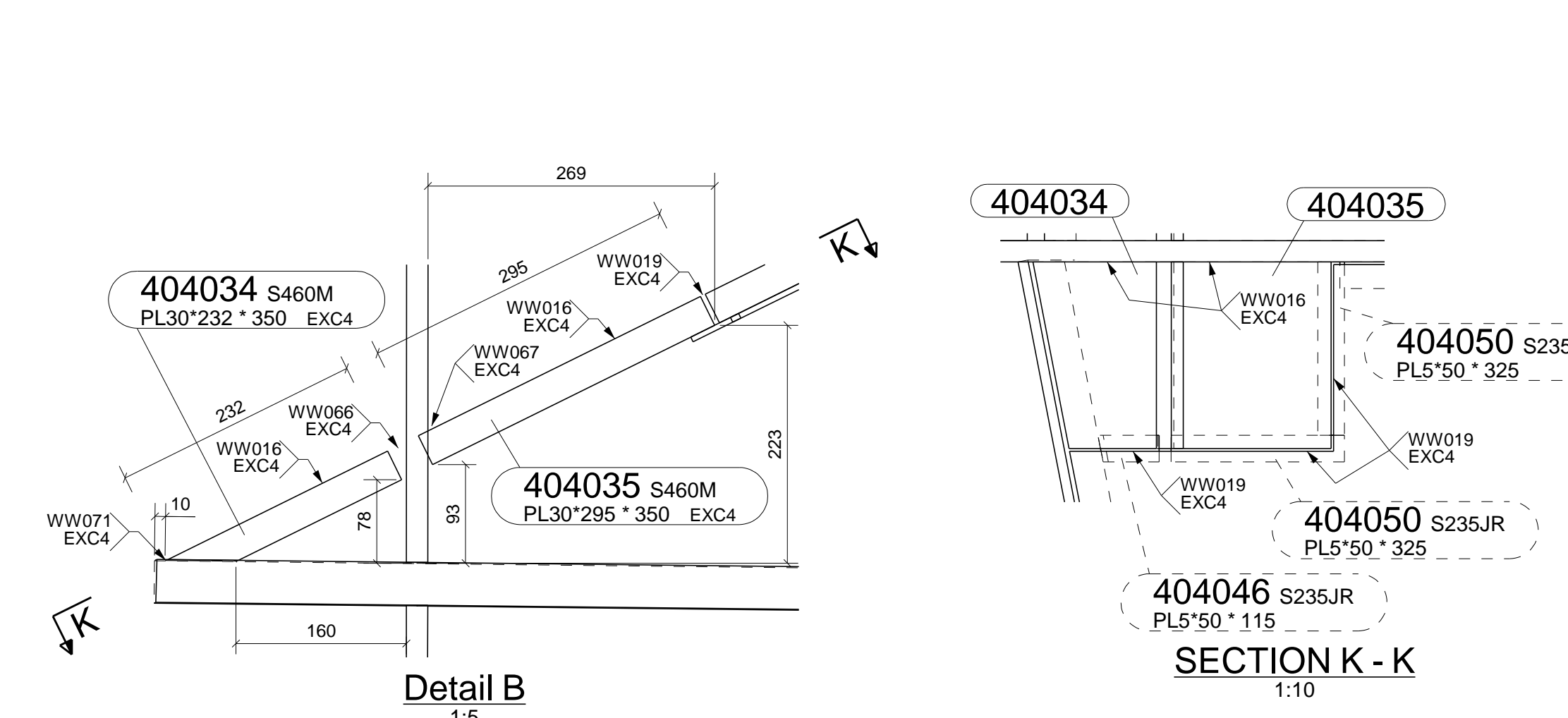
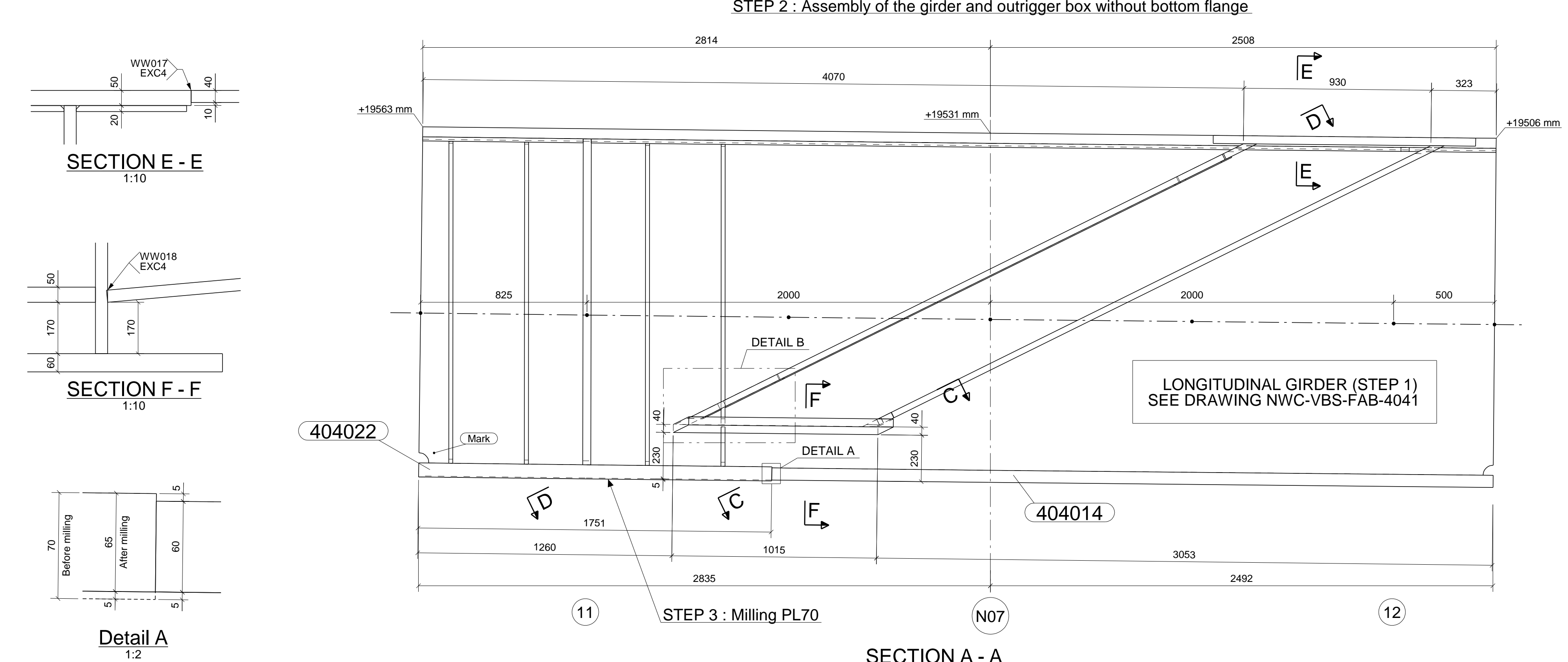

General notes:
 (unless indicated otherwise)

Structural steel grades according to EN 10025:

Pylon steelwork:
 For plate thickness t, for pylon and pylon cross beam outer plates:
 t<25mm S355J2+N; 25<t<30mm S355K2+N; t>30mm S355ML
 For plate thickness t, for all other non-cold formed pylon plates:
 t<35mm S355J2+N; 35<t<45mm S355K2+N; t>45mm S355ML
 For trapezoidal stiffeners: S355J0+C

Deck steelwork:
 For plate thickness t, for main girder plates and anchorage console plates:
 t<30mm S460M; t>30mm S460ML
 For plate thickness t, for cross girder plates:
 t<40mm S355J2+N; t>40mm S355M
 For all stiffeners: S355J2+N

Z-quality: see indication on drawing
 Shear studs: S235J2+N+C450 (diameter and length: see indication on drawing)

Welding:
 All outside welds shall form a continuous seal
 All weld sizes: number indicates throat size (a=...)

Execution class:
 EXC3 according to BS EN 1090-2
 EXC4 according to BS EN 1090-2 for cable anchorage consoles, bearing arrangements and pylon base connection (as indicated on drawing)

NOTE

Assembly 4040 - TR03 : manufactured as designed
 Assembly 4040A - TR03A : manufactured as mirror image

All pieces are designed for the assembly without "A".
 The pieces for the assembly with "A" are manufactured as mirror image and "A" is added to the part number.

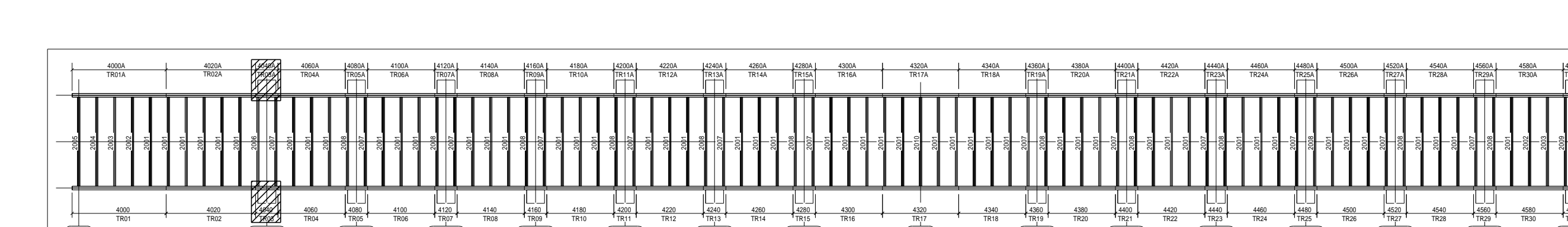

B	Issued for construction	11.05.2016	MC KR	LDP
A	First issue - For review	18.02.2016	MC KR	LDP
Rev	Description	Date	By	APP
			Chk	
Client : Sunderland City Council				
Design Joint Venture: BURHAPPOLD ENGINEERING		explorations architecture		Contractor Joint Venture: STRASKY, HUNTY AND PARTNERS LTD
Project Title: Sunderland Strategic Transport Corridor NEW WEAR CROSSING				
Drawing Title: ANCHORAGE CONSOLE TR03 + TR03A CONSTRUCTION - GENERAL VIEW				
Drawn:	MC	Checked:	KR	
Design:	DJV	Approved:	LDP	
Date:	18.02.2016	Scale (at A0):	1:15	
Drawing No.:	NWC-VBS-FAB-4040			Rev: B