

TYPICAL DETAIL OF LIFTING LUG
1:5

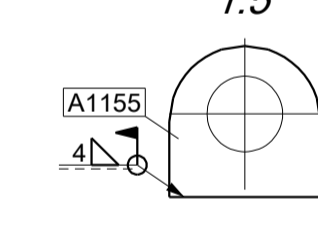

LIFTING LUGS TO WELD ON SIDE AS REQUIRED
 ASSEMBLY BOLT
 ISO 4017 (25CrMo4) - STANDARD OF BOLT
 VSK (1.4541) - STANDARD OF WASHER UNDER NUT
 ISO 4032 (25CrMo4) - STANDARD OF NUT
 ISO 4014 (25CrMo4) - STANDARD OF BOLT
 ISO 7089 (25CrMo4) - STANDARD OF WASHER
 ISO 4032 (25CrMo4) - STANDARD OF NUT

REVISION	DATE	DESCRIPTION	DESIGNED BY	APPROVED BY
B	09.05.2018	REVISION LISEGA	KUBINA	
A	03.05.2018	FIRST ISSUE	KUBINA	

drawing state:	state:	example:
----------------	--------	----------

OWNER: Termoelektrarna Šoštanj d.o.o. Cesta Lole Ribarja 18 3325, Šoštanj Slovenija	GENERAL CONTRACTOR: SteelPro 4 s.r.o. ulice Lipovská 1177/24 790 01, Jeseník Czech Republic	SUBCONTRACTOR: SteelPro 4 s.r.o. ulice Lipovská 1177/24 790 01, Jeseník Czech Republic
--	--	---

SCALE 1:5 1:10 1:20	DESIGNED BY KUBINA	PROJECT No. 117063	SERIAL No. 5.3.11
CHECKED BY	APPROVED BY	SIZE (No./A) A1 (8)	DATE 03.05.2018
PROJECT Reduction of Nitrogen Oxides of Unit 5 at Termoelektrarna Šoštanj		FILE NAME SUHA-SP4-C0-DW-5.3.11-8 (05).dwg SUHA-SP4-C0-DW-5.3.11-8.pdf	TYPE OF DOCUMENTATION Workshop drawings
PART 5 - Air ducts and steel supporting structures		DRAWING No. GENERAL CONTRACTOR 5UHA-SP4-C0-DW-3301	
TITLE 5.1 Boiler house Unit 5 - SWA - Ducts and supporting steel structures		REVISION B	
DRAWING No. SUBCONTRACTOR 1802-OK-DW-014		SHEET 05 of 05	