

ONE - FRAME - 1F1

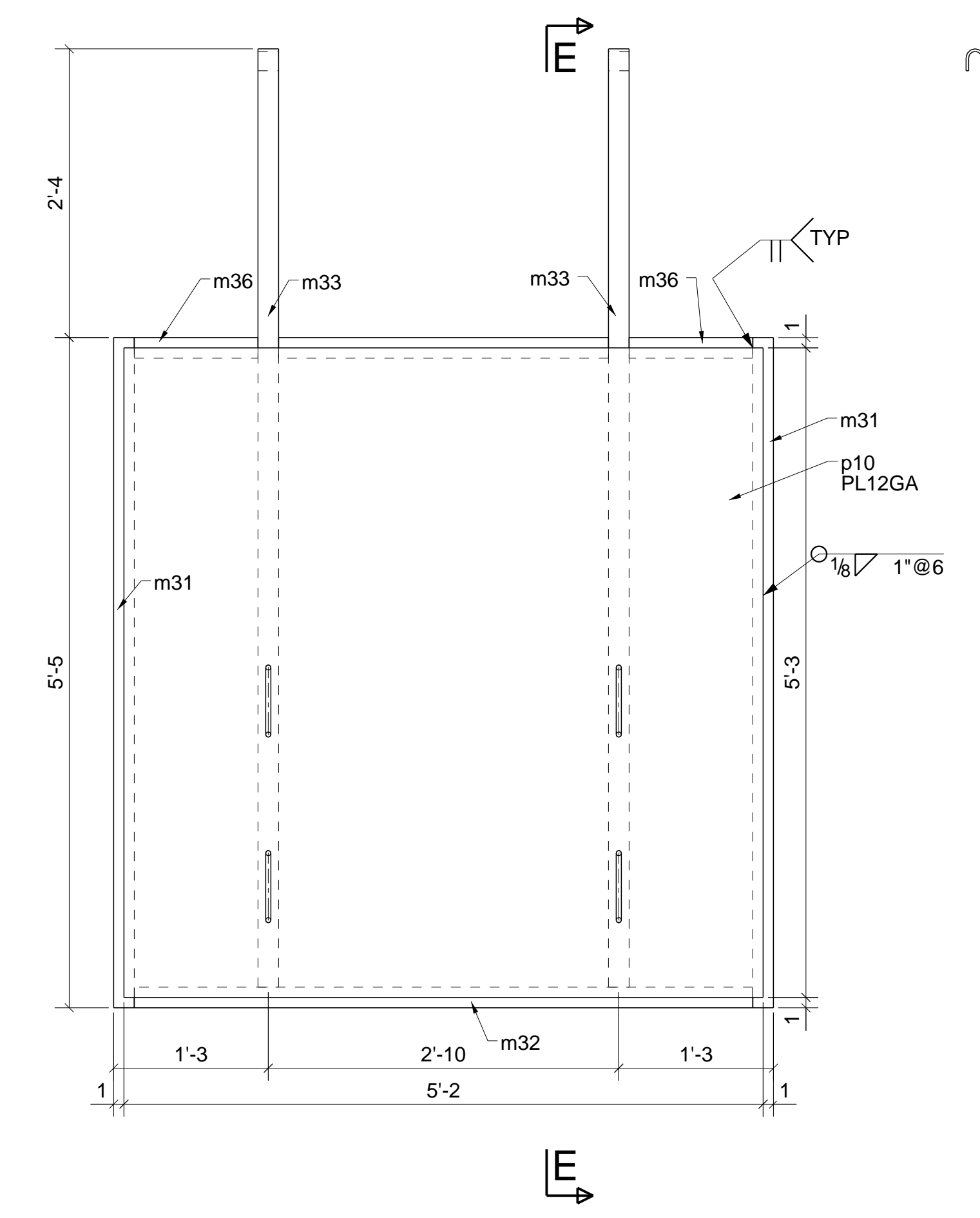

ONE - FRAME - 1F2

BILL OF MATERIAL					
MARK	QTY	DESCRIPTION	LENGTH	WEIGHT	REMARKS
1F1	1	FRAME			GALV.
1F1	1	HSS4X4X3/8	6'-7"	107	A992
a2	1	L3X3X1/4	1'-11"	9	A36
m30	2	RB1/2"	0'-10 9/16"	1	A36
p11	2	FL1/4"X2 3/4"	0'-9 1/2"	4	A36
p13	2	FL3/4"X4 3/4"	0'-9"	16	A36
p35	2	FL1/4"X1 3/4"	0'-3 1/2"	1	A36
ts1	1	HSS4X4X3/8	6'-7"	107	A992
ts3	1	HSS4X4X3/8	5'-3 1/2"	86	A992
ts4	1	HSS6X4X3/8	4'-7 1/2"	97	A992
ts5	2	HSS4X4X3/8	0'-6 3/4"	18	A992
ts6	2	HSS4X4X3/8	10'-6 3/4"	344	A992
ts7	1	HSS4X4X3/8	1'-3 1/2"	21	A992
ts8	4	HSS4X4X3/8	2'-2"	141	A992
ts9	1	HSS4X4X3/8	0'-6"	8	A992
ts10	1	HSS4X4X3/8	1'-7 1/2"	26	A992
ts11	1	HSS4X4X3/8	0'-10"	14	A992
ts12	1	HSS4X2X1/4	0'-3"	2	A992
ts13	2	HSS4X2X1/4	2'-11"	48	A992
ts14	1	HSS4X2X1/4	0'-7"	5	A992
ts15	1	HSS4X2X1/4	0'-5"	3	A992
ts16	1	HSS4X2X1/4	0'-9"	6	A992
1F2	1	FRAME			GALV.
1F2	1	FL1/4"X2"	2'-8"	5	A36
m31	2	FL1/4"X2"	5'-5"	16	A36
m32	1	FL1/4"X2"	5'-0"	9	A36
m33	2	FL1/4"X2"	7'-9 3/8"	27	A36
m36	2	FL1/4"X2"	1'-0"	3	A36
m37	4	RB1/2"	0'-9 9/16"	2	A36
p10	1	PL12GA		0	
TOTAL WEIGHT THIS DRAWING				1131	

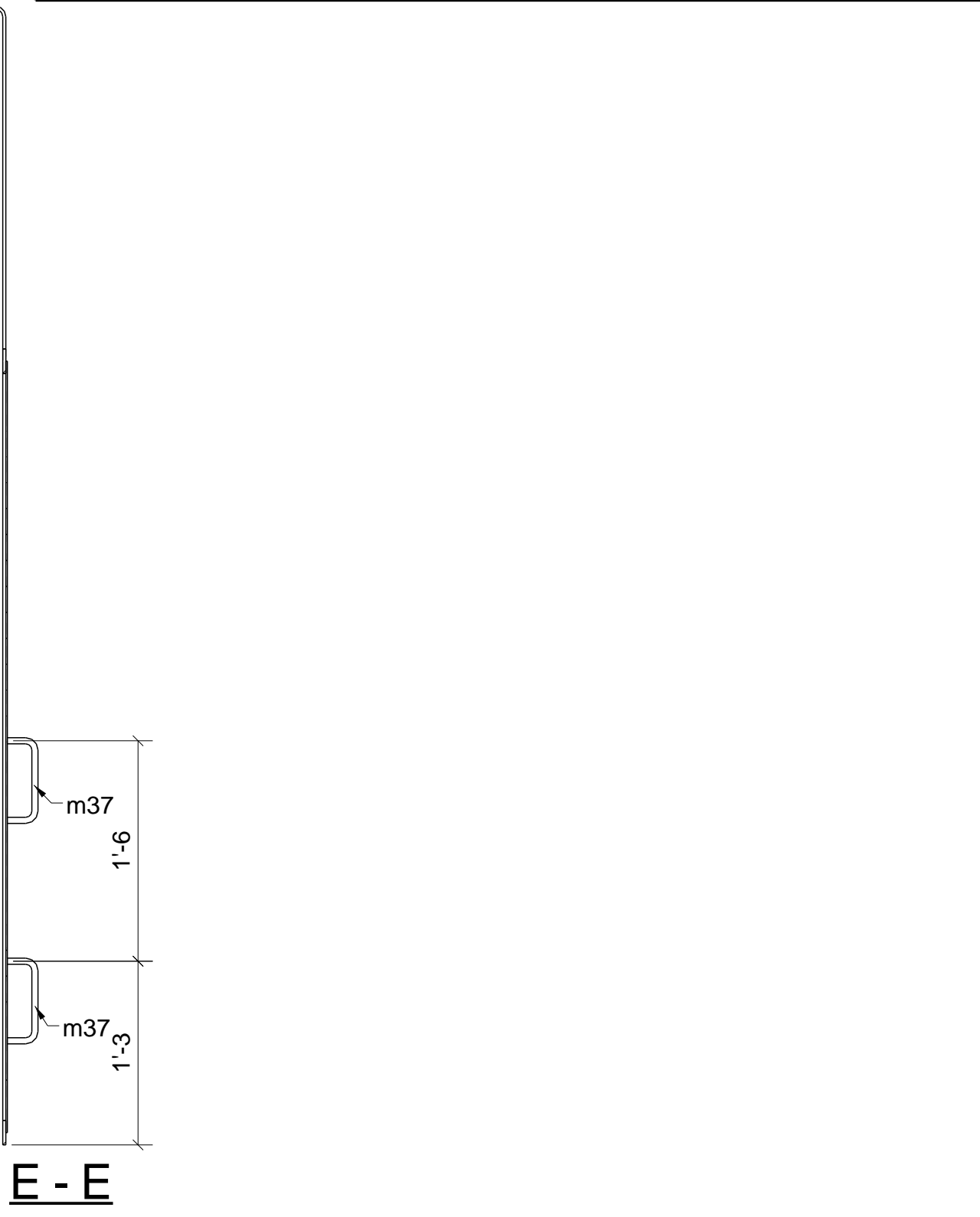

ALL WIDE FLANGES & WT SECTIONS ASTM A993 U.N.O.
 ALL CHANNELS, ANGLES ASTM A36 U.N.O.
 ALL PLATES ASTM A572 GR 50 U.N.O.
 ALL TUBING ASTM A500 GRADE B U.N.O.
 ALL HOLES 13/16" U.N.O.
 ALL WELDS 1/4" FILLET CONT. U.N.O.
 ALL STEEL SHALL BE HOT-DIPPED GALVANIZED U.N.O.

WAITE
 SPECIALTY MACHINE
 1160 INDUSTRIAL WAY
 LONGVIEW, WASHINGTON 98632
 (360) 636-0827 FAX (360) 636-4521

PROJECT	PM10 Hood Access Platform	JOB No.	8950
COMPANY		APPROVED	
DRAWN BY	WKB	CHECKED BY	RW
DATE	08/20/2019	DATE	08/20/2019
DRG No.		REV	1
			0