

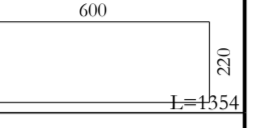

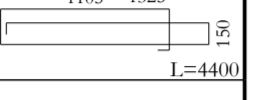

WAPENINGSBORDEREL				SLOT	
Nummer	#	Ø	Plooi vorm	Ø8	108mm
(B72)	4	Ø20	9095	Ø10	135mm
(B78)	4	Ø12	9095	Ø12	162mm
(B79)	3	Ø20	6490	Ø16	216mm
(B92)	3	Ø12	8845		
(B93)	2	Ø16	6490		
(B94)	4	Ø12	6490		
(B95)	2	Ø12	2125		
(B170)	2	Ø12	3000		
(B40)	2	Ø12			
(B80)	44	Ø8			
(B89)	19	Ø8			
(B90)	4	Ø8			
(B91)	4	Ø16			
(B97)	4	Ø12			
(B168)	2	Ø8			
(B169)	2	Ø20			
(B171)	2	Ø20			
<b>Totaal:</b>				<b>403kg (staven)</b>	

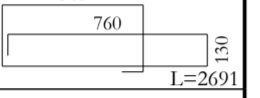

TOEBEHORENLIJST		
HTA 38/17 - 150mm		16
Boutanker M24	200 mm	1
TSE Ø20/M24	700 mm	1
Eindeloze lus 6,3T		4
IB 66/72		1
K80/50/3		1
ST100		1
ST101		2

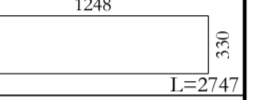
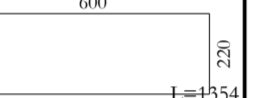
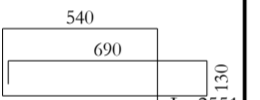
MATERIAAL EIGENSCHAPPEN	
Wapening:	BE500TS/BE500ES
Sterkteklasse beton:	C50/60
Omgevingsklasse:	EE2
Betondekking:	30mm

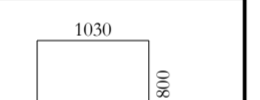
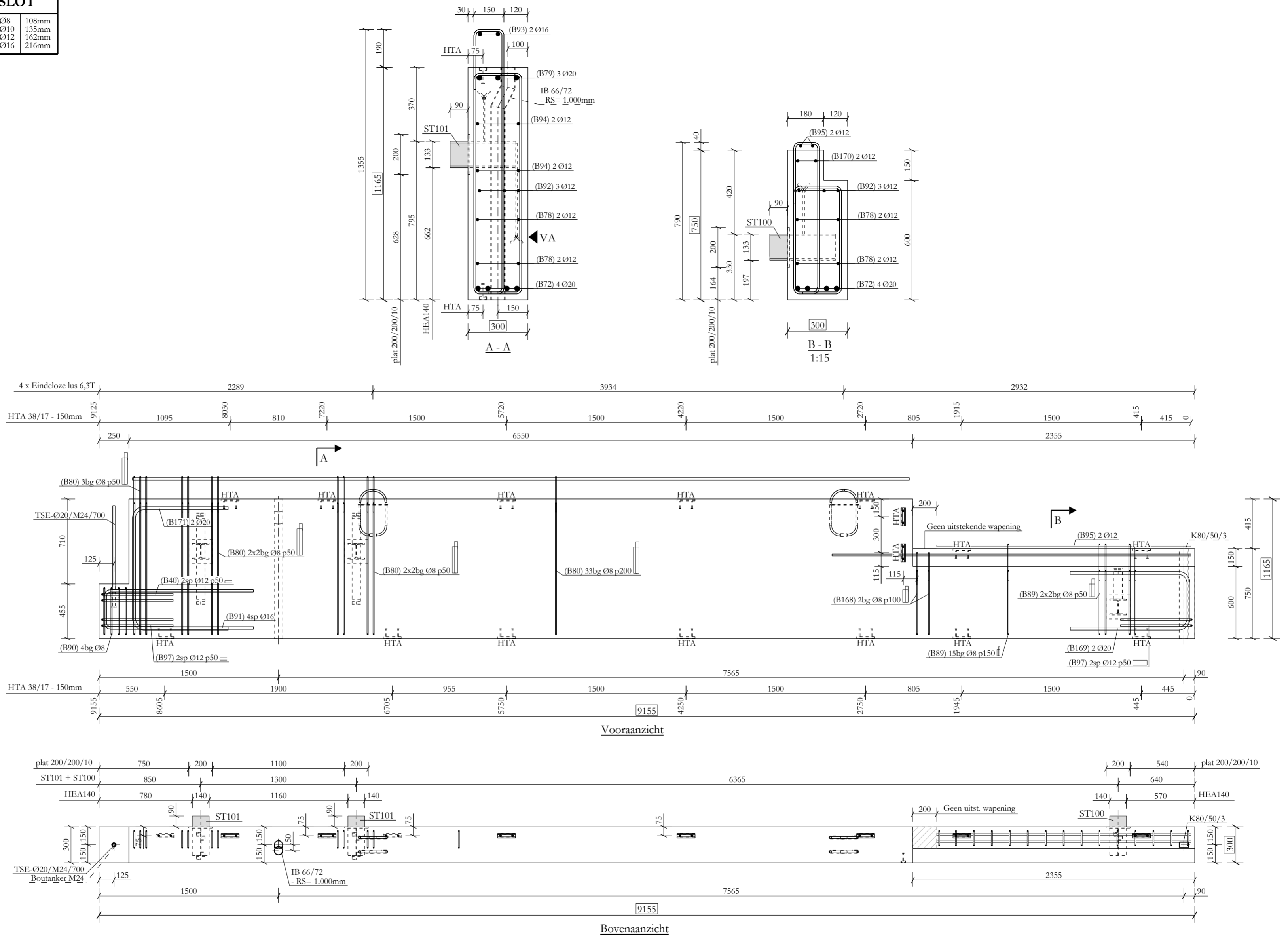
<b>SF22-0279-BO</b>
SPORTCOMPLEX NIEUWPOORT
8620 NIEUWPOORT

## STADSBADER

**N.V. STADSBADER S.A.**  
Kanaalstraat 1, B-8530 Harelbeke  
info@stadsbader.com - www.stadbader.com

DATUM:	02/03/23	STUK:	VB108
GETEKEND:	VD	AANTAL:	1
VOLUME:	2.81 m <sup>3</sup>	INDEX:	
GEWICHT:	7.09 ton	DATUM INDEX:	