

section B - B
1:100

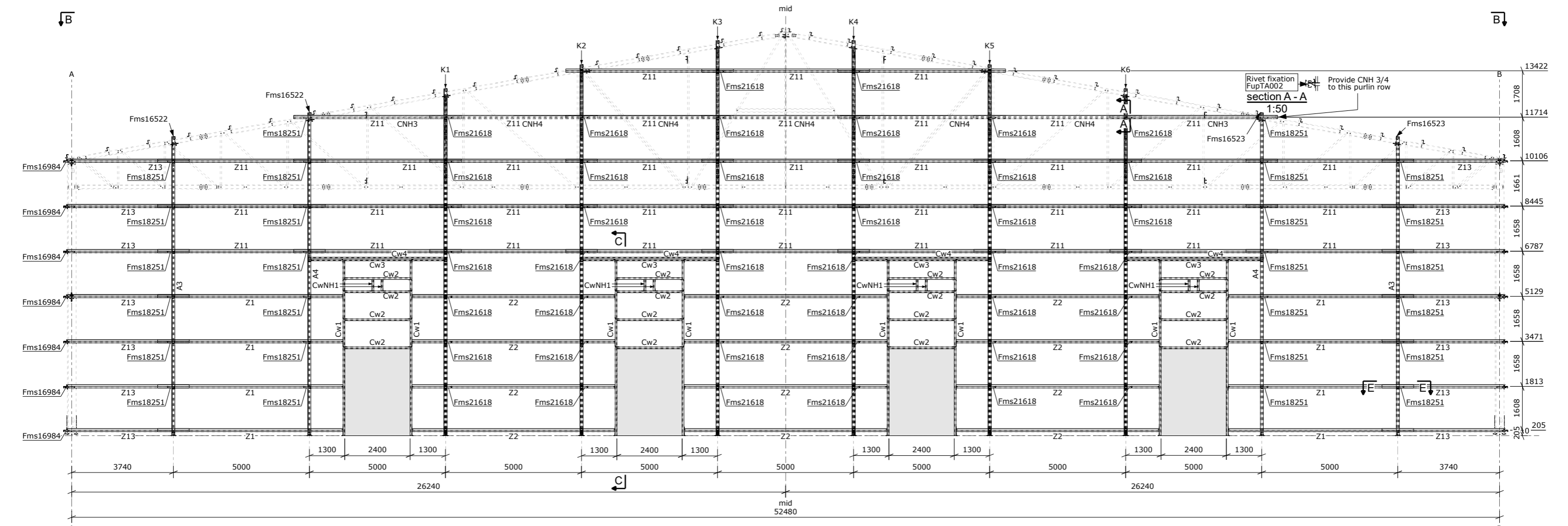

section A - A
1:50

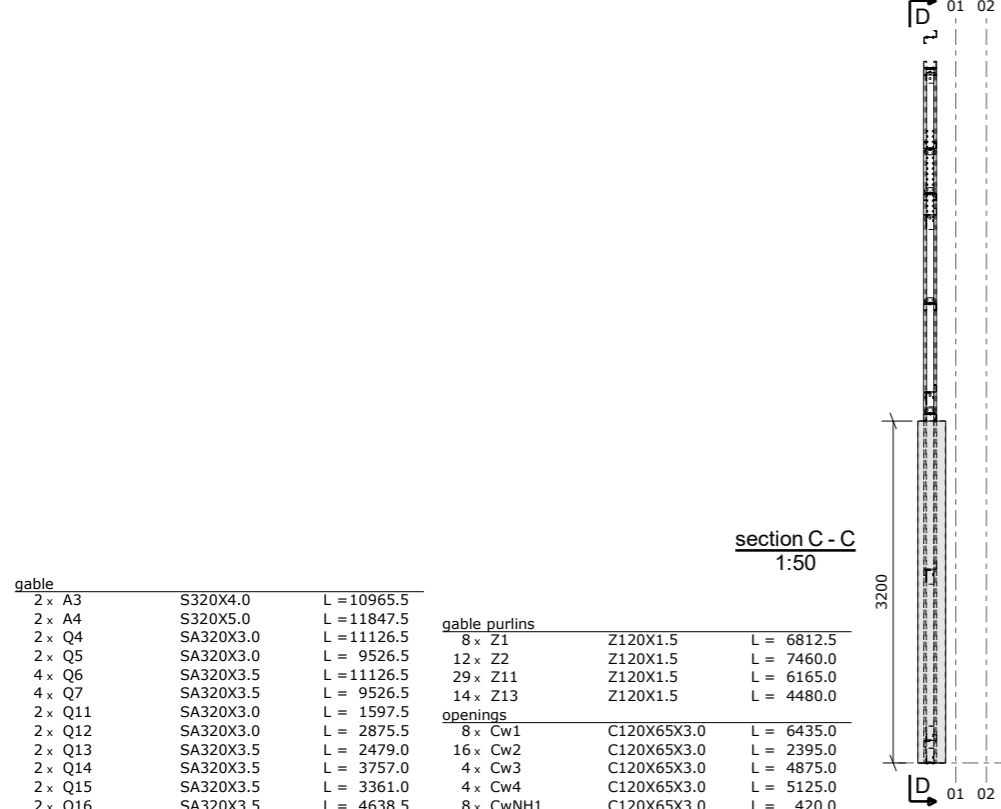

section C - C
1:50

gable			gable purlins			openings		
2 x A3	S320X4.0	L = 10965.5	8 x Z1	Z120X1.5	L = 6812.5	8 x Cw1	C120X65X3.0	L = 6435.0
2 x A4	S320X5.0	L = 11847.5	12 x Z2	Z120X1.5	L = 7460.0	16 x Cw2	C120X65X3.0	L = 2395.0
2 x Q4	SA320X3.0	L = 11126.5	29 x Z11	Z120X1.5	L = 6165.0	4 x Cw3	C120X65X3.0	L = 4875.0
2 x Q5	SA320X3.0	L = 9526.5	14 x Z13	Z120X1.5	L = 4480.0	4 x Cw4	C120X65X3.0	L = 5125.0
4 x Q6	SA320X3.5	L = 11126.5				8 x CwNH1	C120X65X3.0	L = 420.0
4 x Q7	SA320X3.5	L = 9526.5						
2 x Q11	SA320X3.0	L = 1597.5						
2 x Q12	SA320X3.0	L = 2875.5						
2 x Q13	SA320X3.5	L = 2479.0						
2 x Q14	SA320X3.5	L = 3757.0						
2 x Q15	SA320X3.5	L = 3361.0						
2 x Q16	SA320X3.5	L = 4638.5						

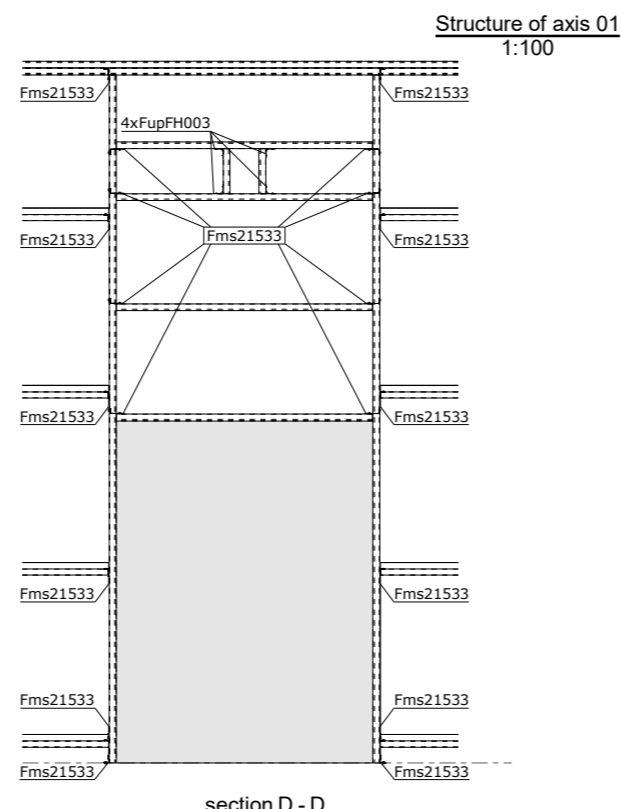

Structure of axis 01
1:100

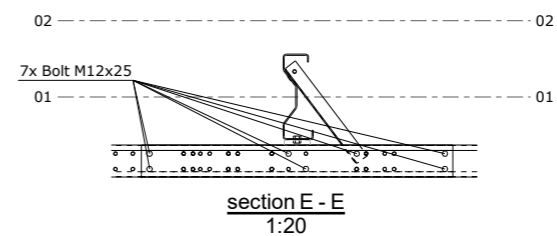

section E - E
1:20

FRISO MAT
BUILDING DREAMS IN STEEL SINCE 1978

N.V./S.A.
Stokerijstraat 79
B-2110 WIJNEGEM (ANTWERP)
tel: +32 3 353 33 99
fax: +32 3 353 32 52
e-mail: info@frisomat.be

client:	SUNDEEP 4 - COTE D IVOIRE BONOUA	FRISOHALL FC_TR_10°			
width:	52.80 m	height:	10.20 m	length:	225.00 m
type:	528/102	project:	ax2300555	order:	EX 065-23
scale:	1:20, 1:50, 1:100	date:	17.10.2023	05.1 Structure of axis 01 ***	