

PLAN VIEW - +22,300 TOS
1:50
PRO TZUŽIDLO CHS60°3,0 POUŽIT ŠROUBY:
2 x M16x5
S20M17 6,8

PLAN VIEW - +22,300 TOS
1:50

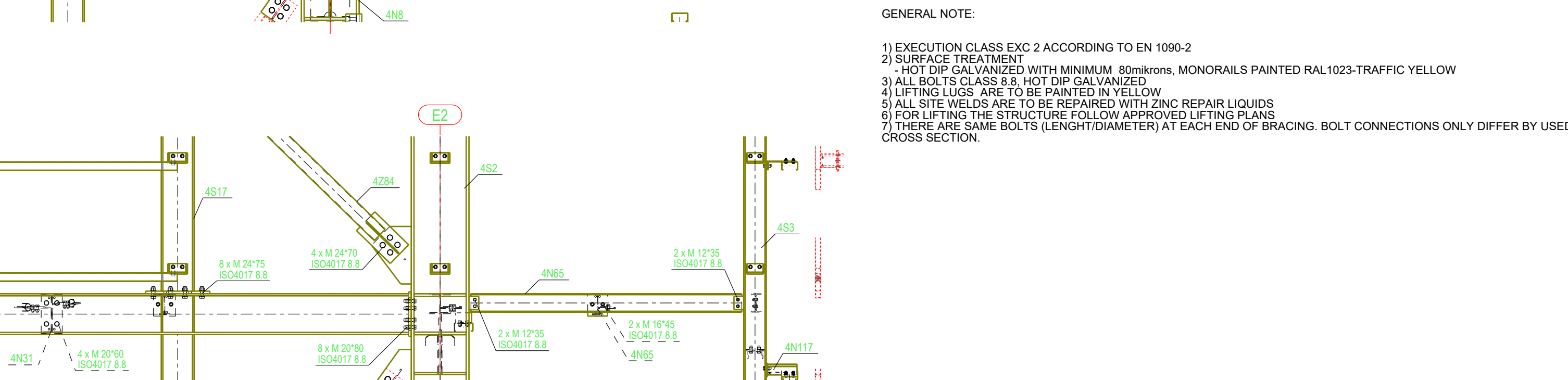
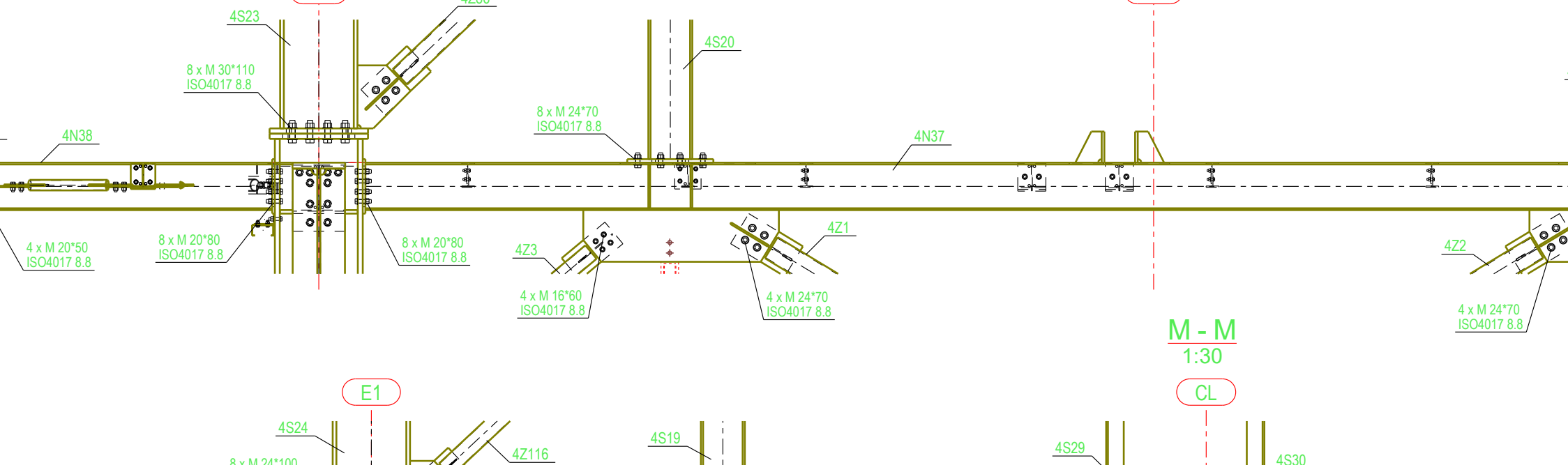
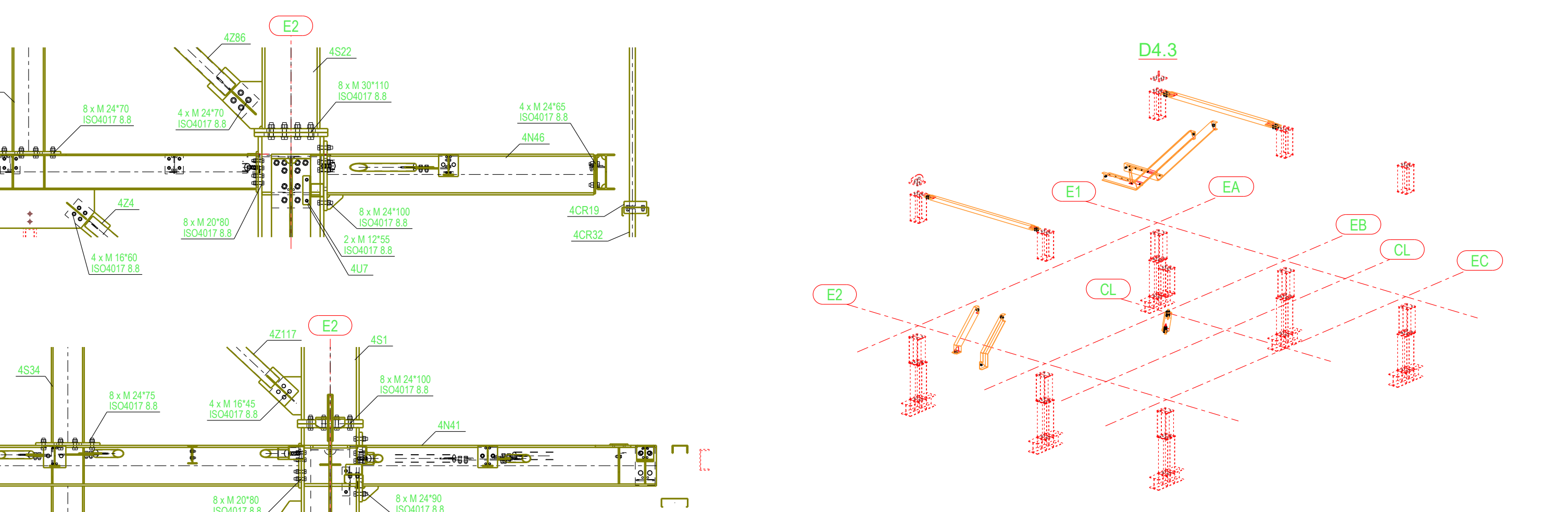
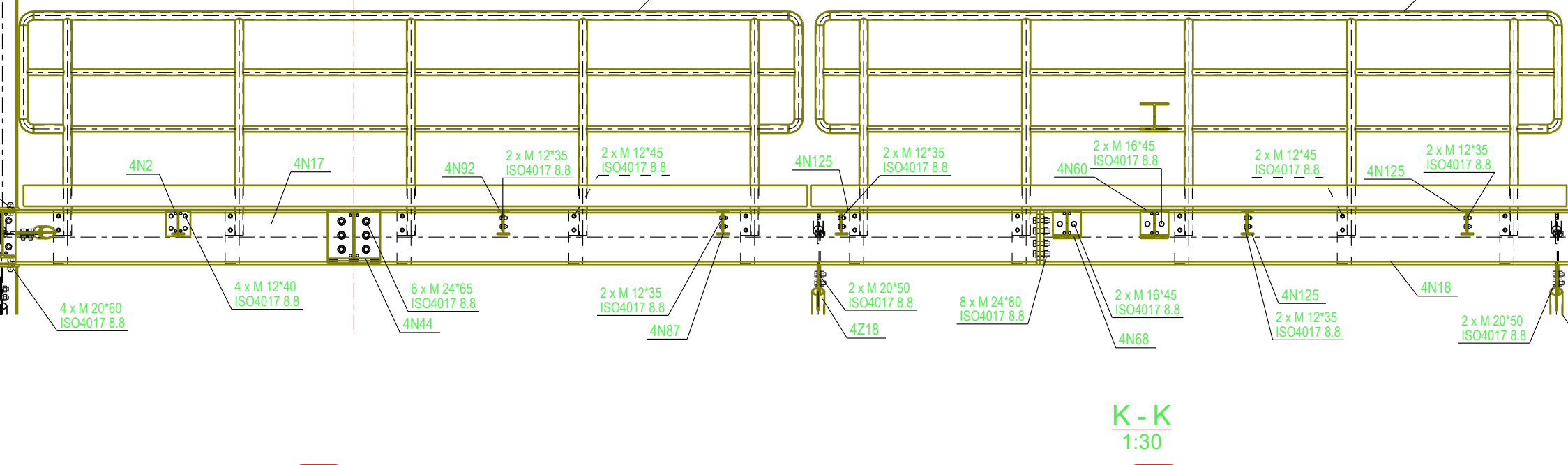
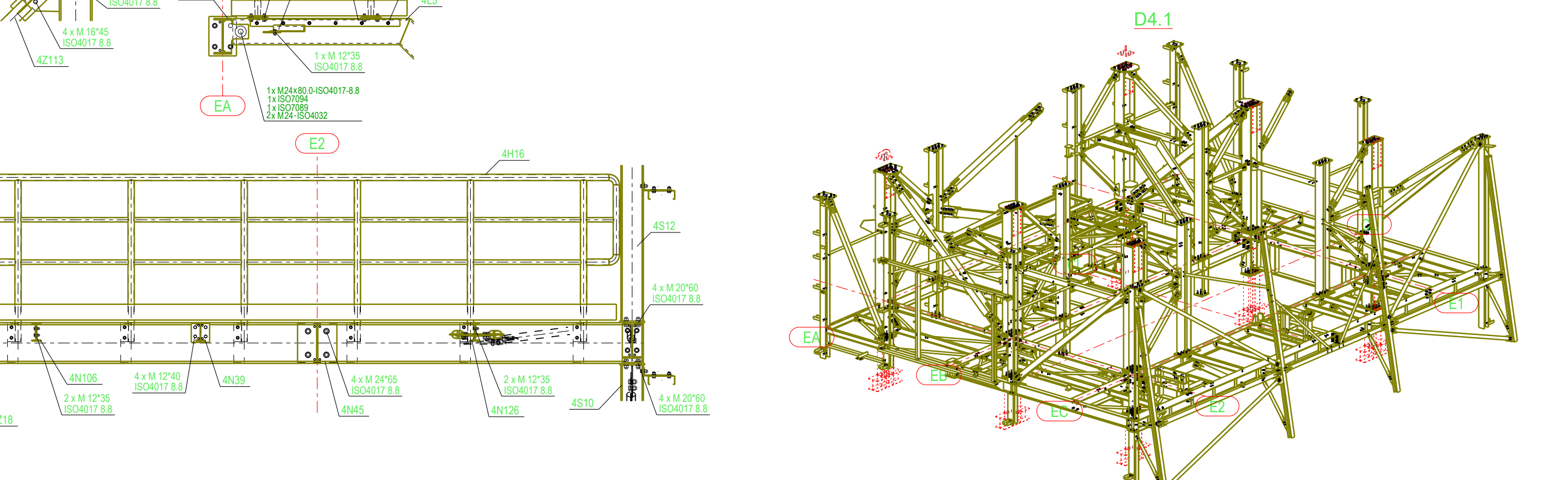
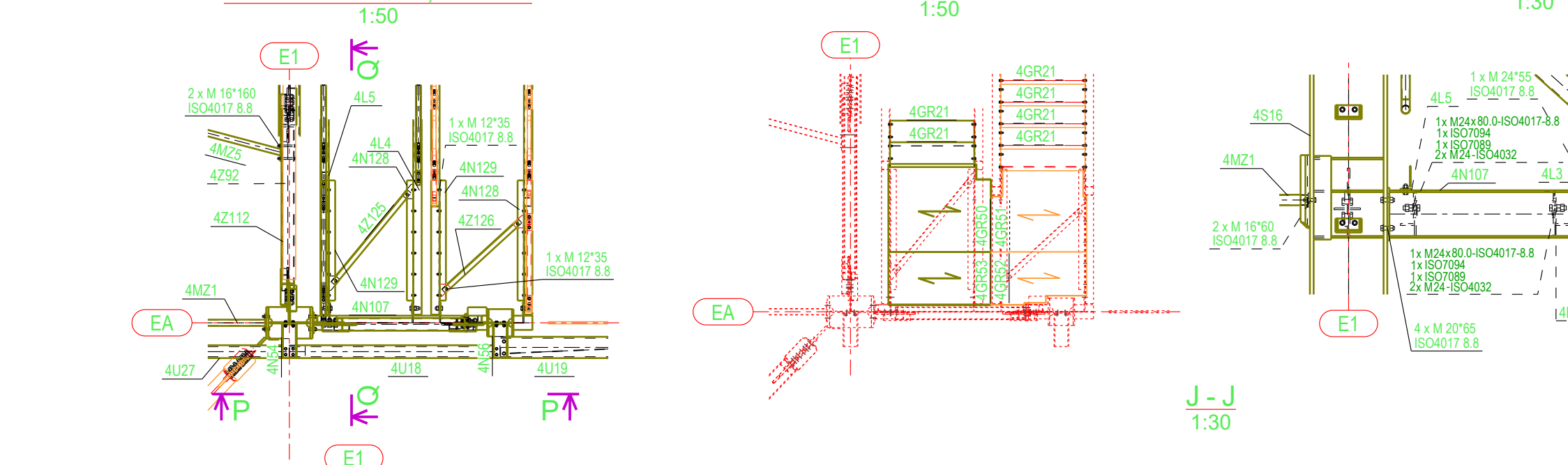
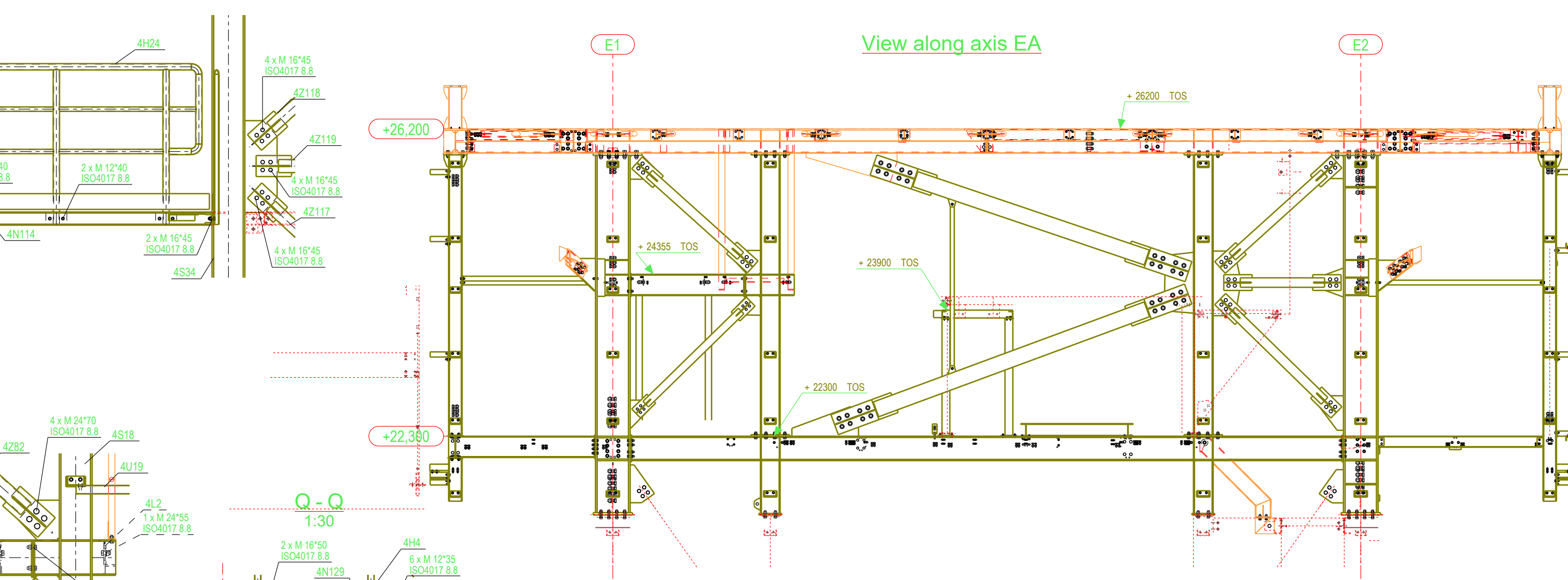
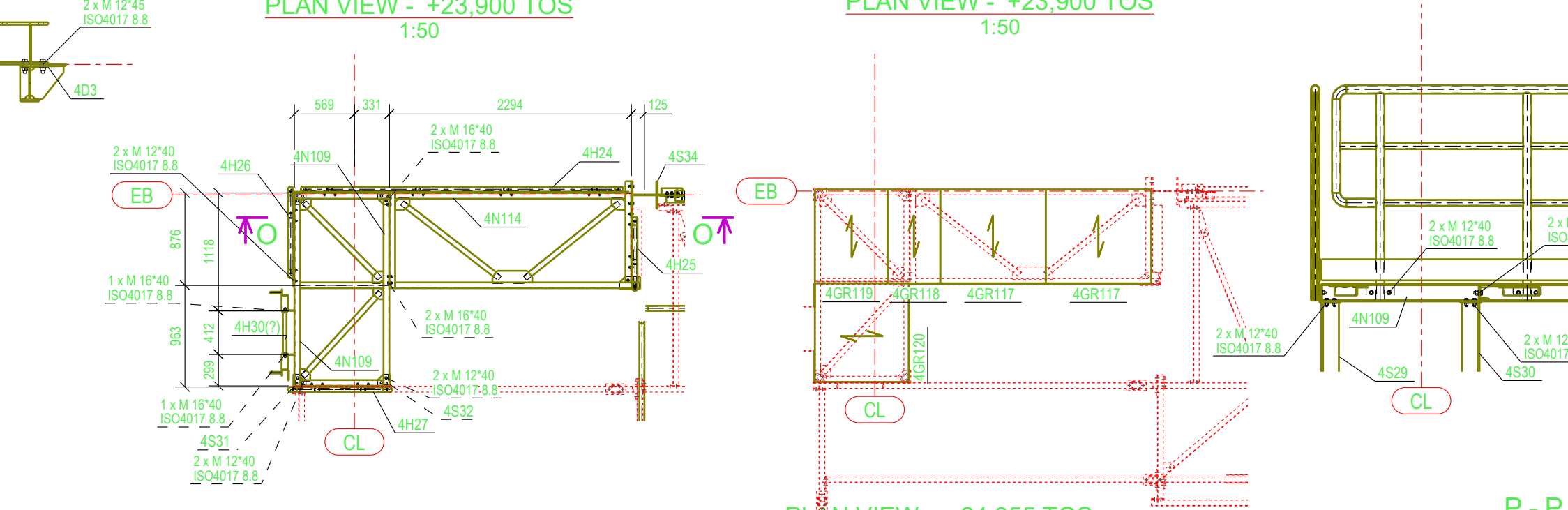
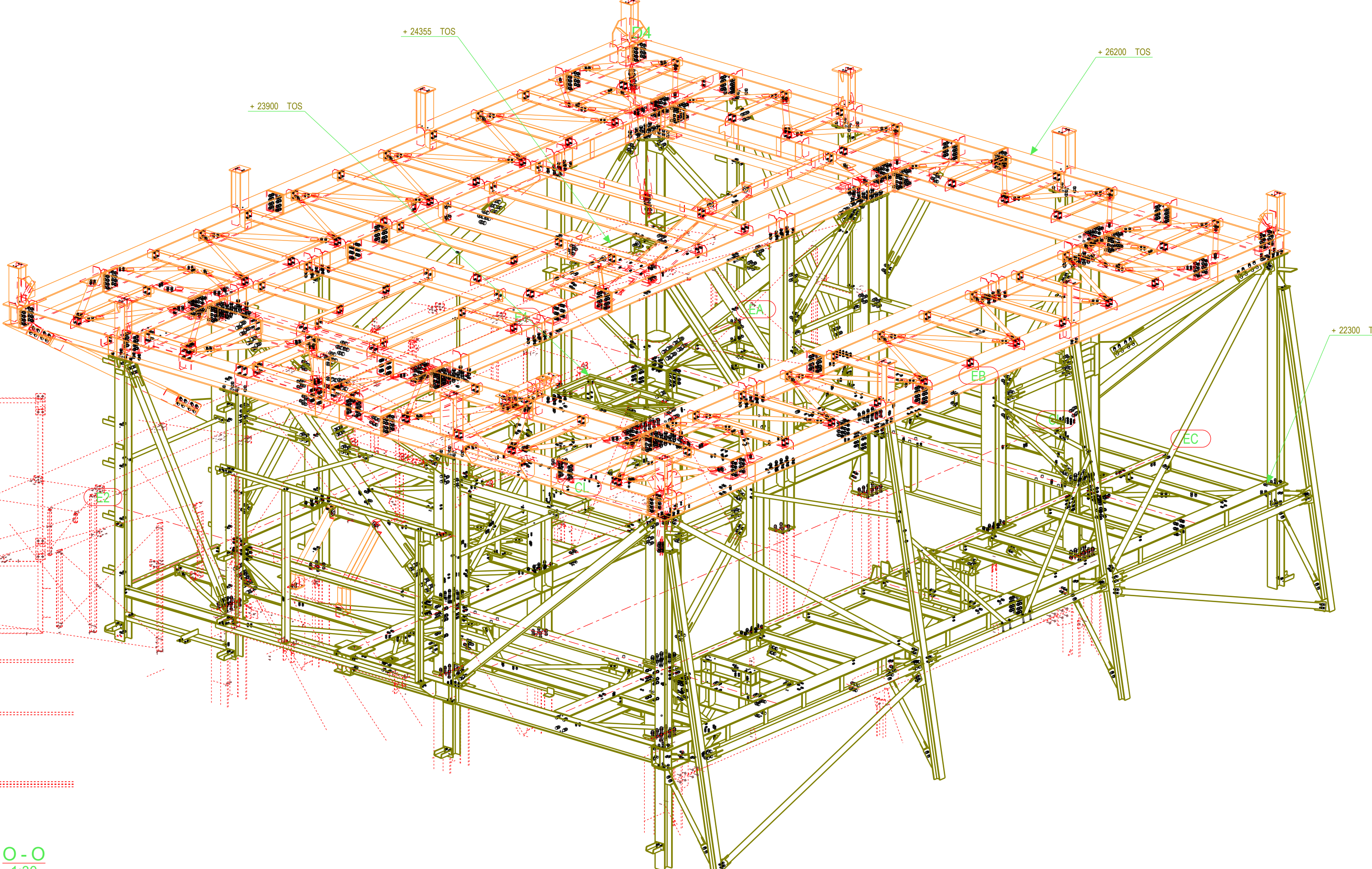
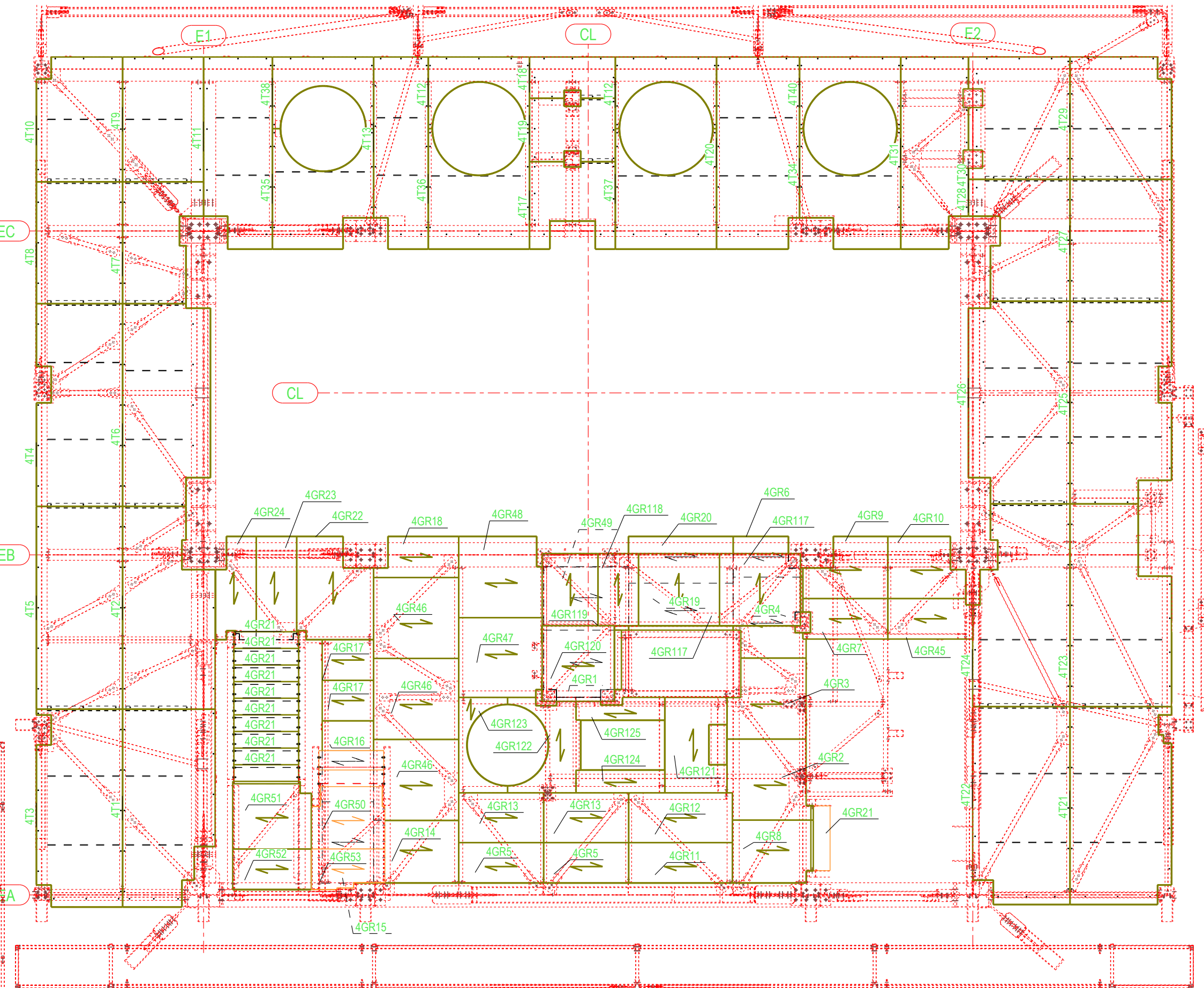
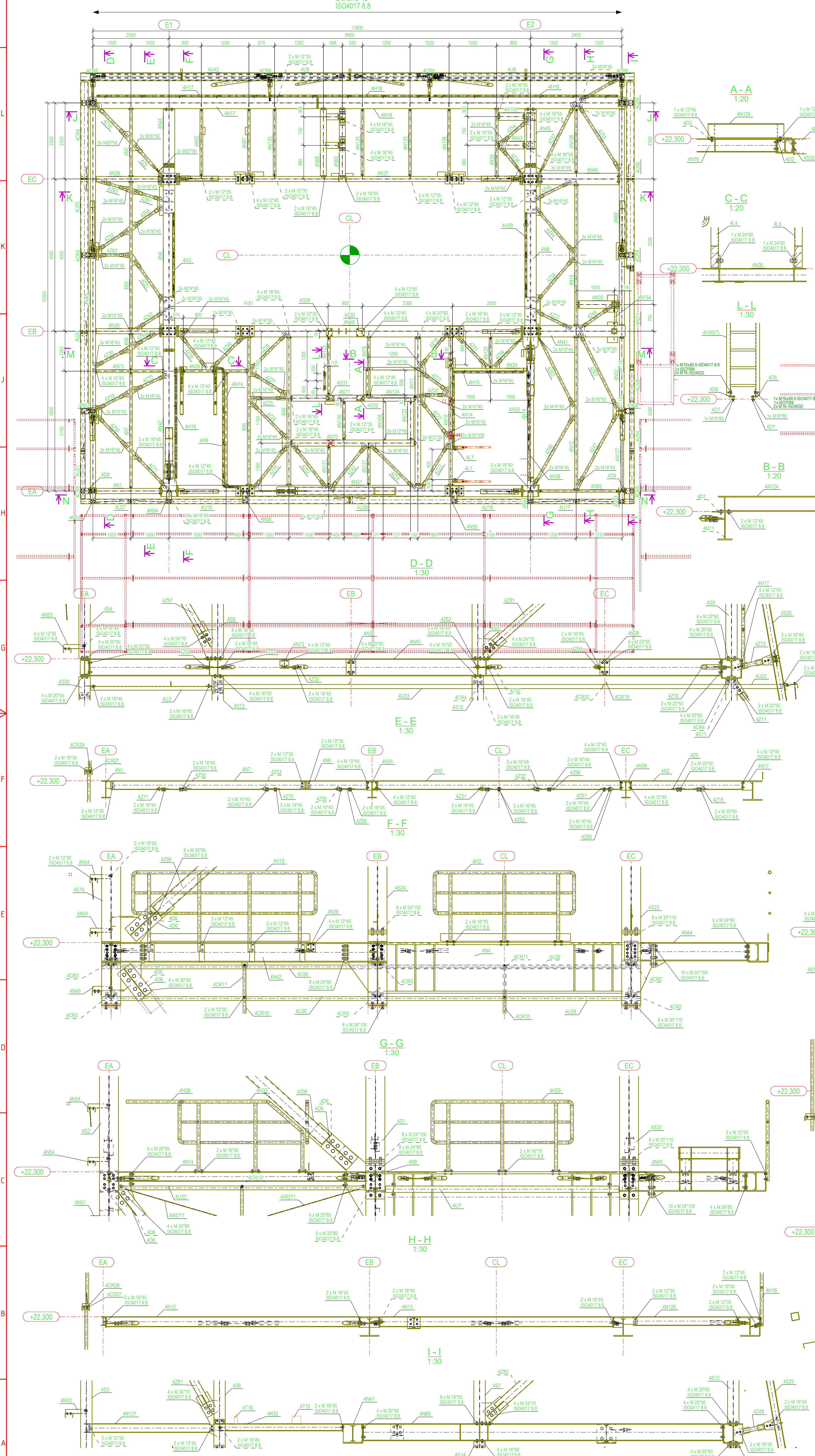

GENERAL NOTE:
1) EXECUTION CLASS EXC 2 ACCORDING TO EN 1090-2
2) SURFACE TREATMENT
- NOT DIP GALVANIZED WITH MINIMUM 80μm/min MONORAILS PAINTED RAL1023-TRAFFIC YELLOW
- HOT DIP GALVANIZED
3) ALL BOLTS CLASS 8, NOT DIP GALVANIZED
4) LIFTING LEGS ARE TO BE PAINTED IN YELLOW
5) ALL SITE WELDS ARE TO BE REPAIRED WITH ZINC REPAIR LIQUIDS
6) FOR LIFTING THE STRUCTURE FOLLOW APPROVED LIFTING PLANS
7) THERE ARE SAME BOLTS (LENGTH/DIAMETER) AT EACH END OF BRACING. BOLT CONNECTIONS ONLY DIFFER BY USED CROSS SECTION.