

MARK	QTY	DESCRIPTION	LENGTH	WEIGHT	REMARKS	GRADE
022P008	1	PLATE			P3	
022P008	1	PL5/16"X7 3/16"	9'-0 1/2"	69.2	ROLLED	A36
dba20	6	DBA 1/2	2'-0"	7.2		A706
dba33	1	DBA 1/2	0'-6 11/16"	0.3		A706
p109	1	PL5/16"X67 5/8"	5'-9 7/8"	76.2		A36
WEIGHT EACH ASSEMBLY				153.0	TOTAL WEIGHT THIS DRAWING	153.0

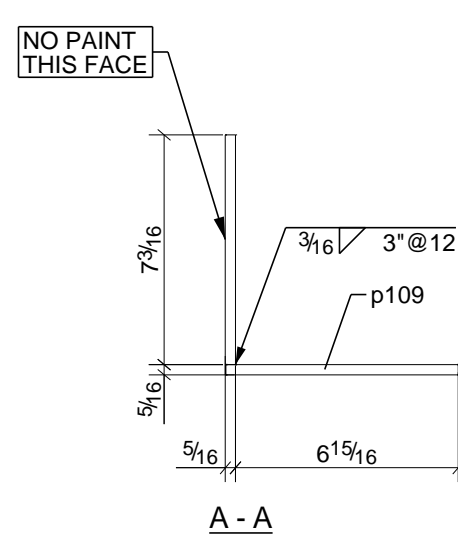
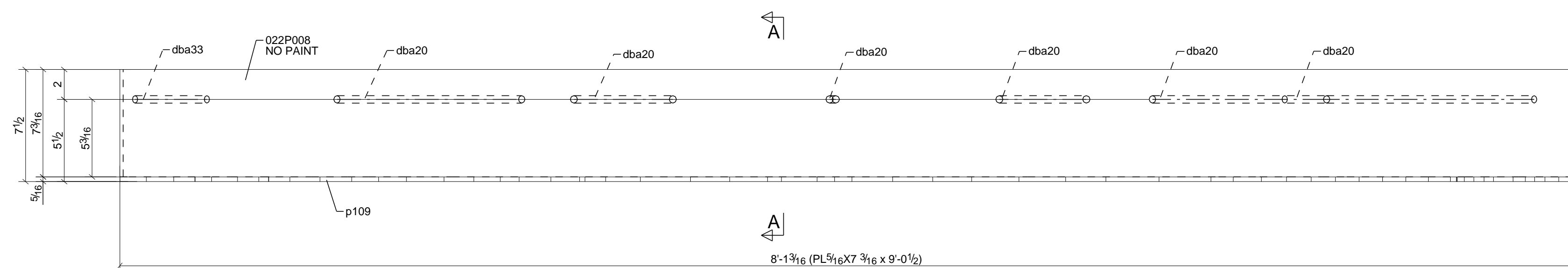
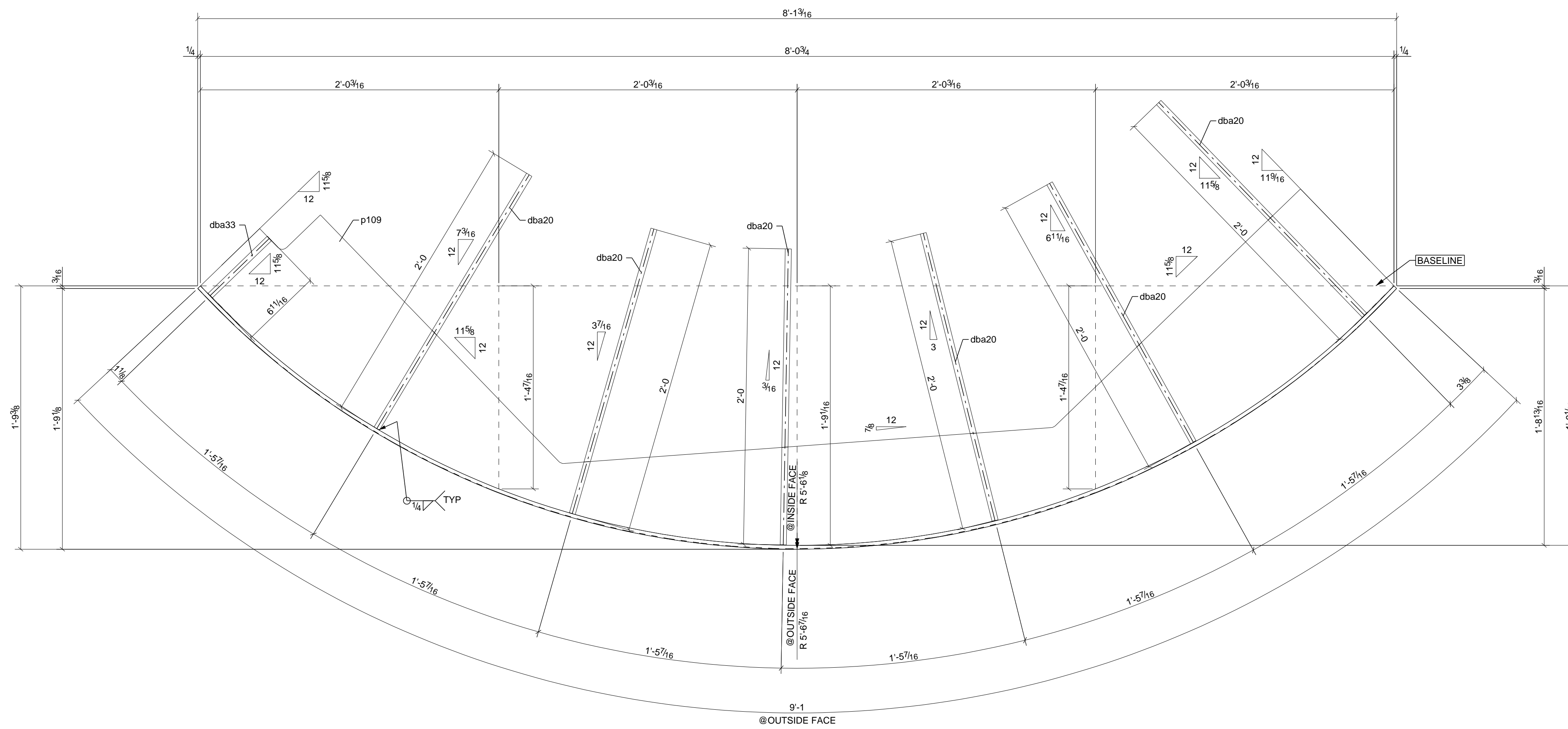

HOLE PATTERNS NOTED *SLIP CRITICAL/SC CLASS A/SC CLASS B/SC CLASS C* SHALL BE PREPARED TO SATISFY SC CONNECTIONS. THE CONTACT SURFACE (CONNECTION SIDE) SHALL BE UNCOATED WITHIN 3' OF THOSE HOLES. CONTACT SURFACE ARE TO BE FREE OF BURRS AND ALL FOREIGN MATERIAL.

0	2025/06/16	ISSUED FOR FABRICATION	KWE
A	2025/03/04	ISSUED FOR APPROVAL	KWE
REV	DATE	REMARKS	BY
		SHOP NOTCH / COPE: 1/2" RAD. U.N.	
		BOLTS: 3/4" A325N U.N.	
		HOLES: 13/16" U.N.	
		WELDS: E70XX	
		MARK STYLE: STANDARD	
		FINISH: PAINT - NA	
		PRIMER: S.W. B50AY1022 (GRAY PRIMER) (2.0-3.0 MILS DFT) U.N.	
		SURF. PREP: SSFC-SP2 (Hand Tool Cleaning) U.N.	

Fargo, ND
 West Fargo, ND
 Mandan, ND
 Rapid City, SD
 Ellings, MI
 Lubbock, TX

TrueNorthSteel
 TrueNorthSteel.com

FOR ERECTION

BACK CHARGES WILL NOT BE HONORED WITHOUT PRIOR AUTHORIZATION. These drawings have been prepared in accordance with the AISC Code of Standard Practice.

PLB0031
 Job No.
 DVP
 Drawn By
 APC
 Checked By
 022P008
 Sheet No.

Ector County Middle School
 34 Block 43, Ector County, TX 79763