

A10

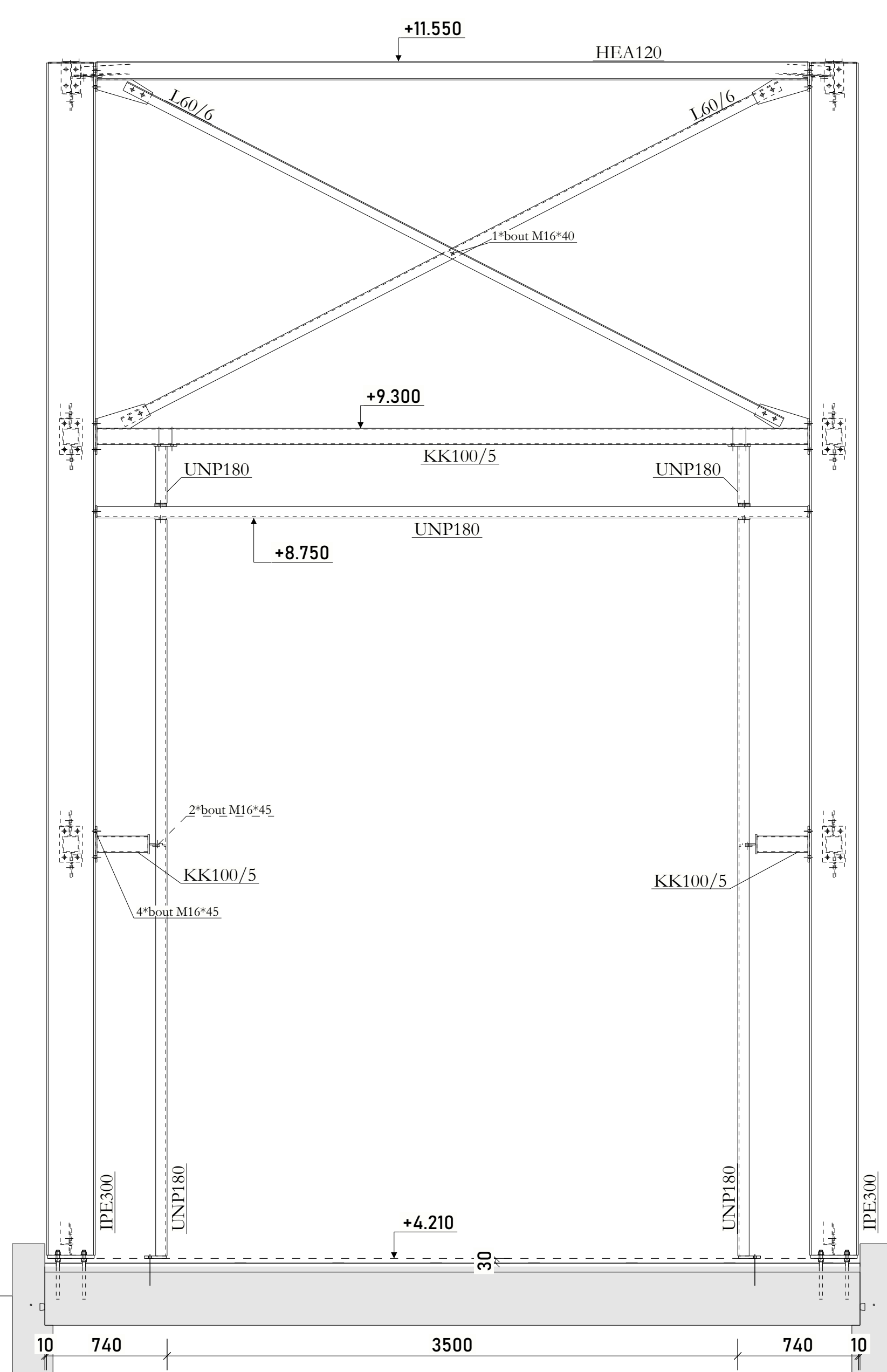

D - D
1:25

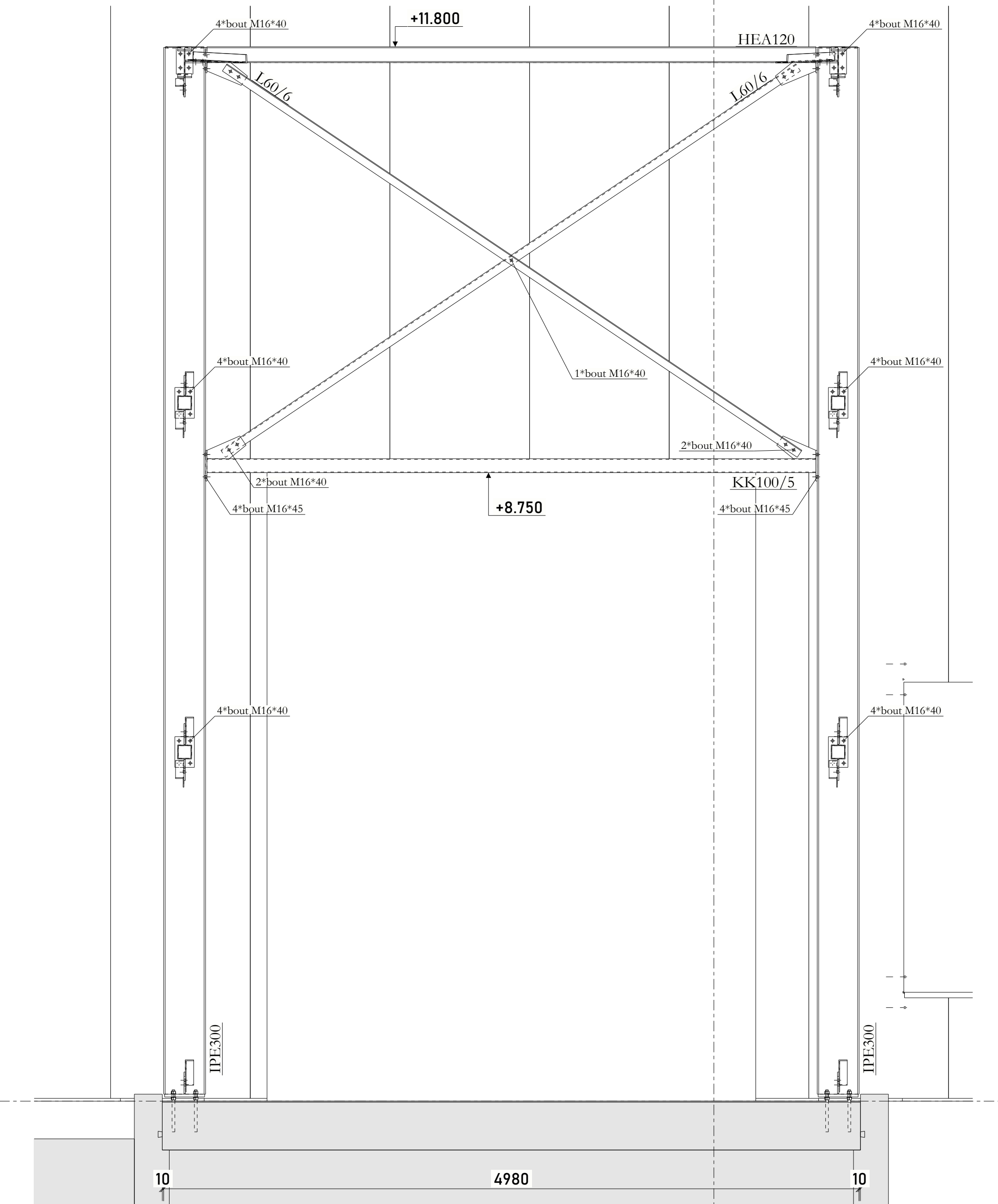

C - C
1:25

A10

A10

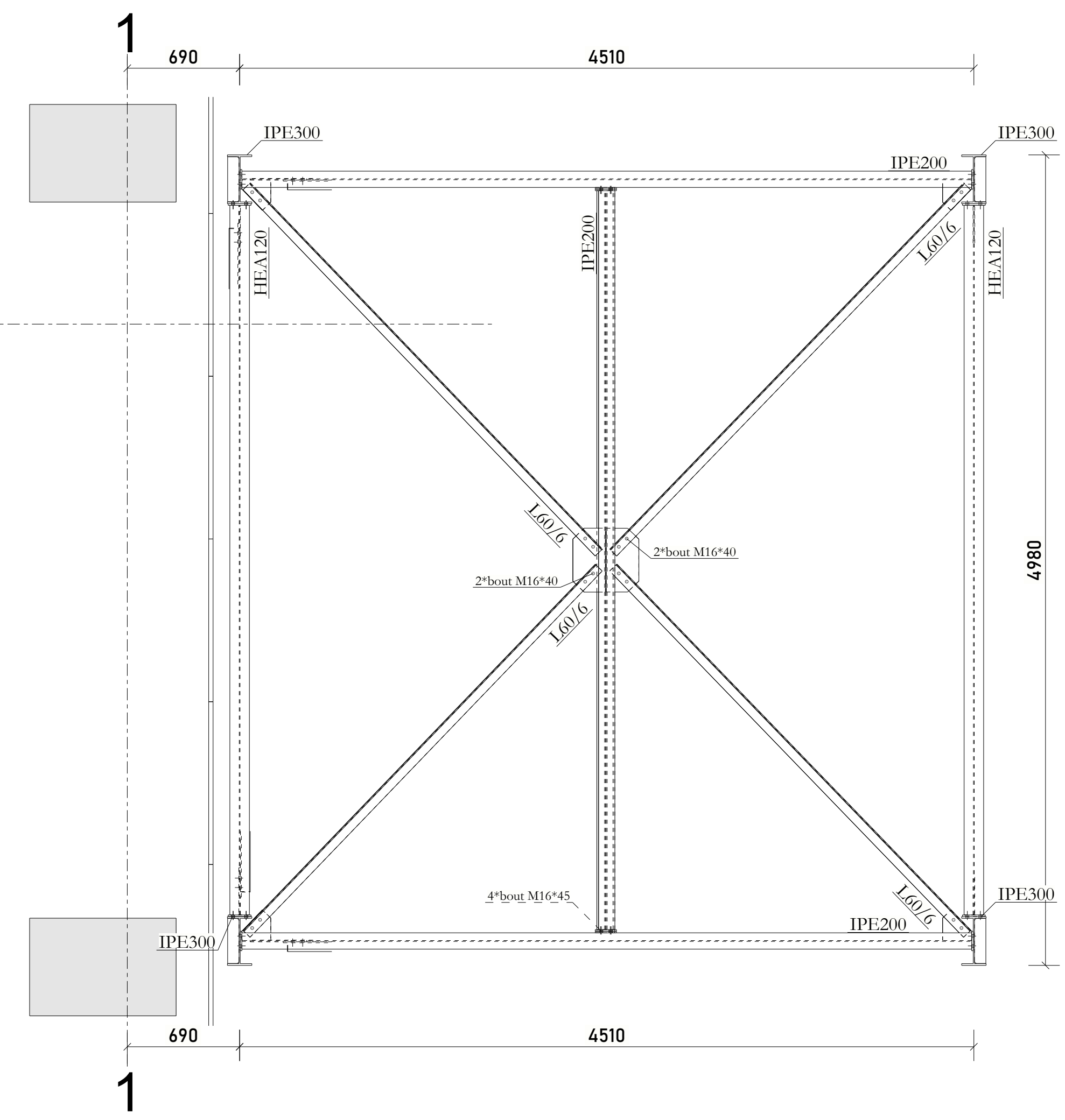

F - F
1:25

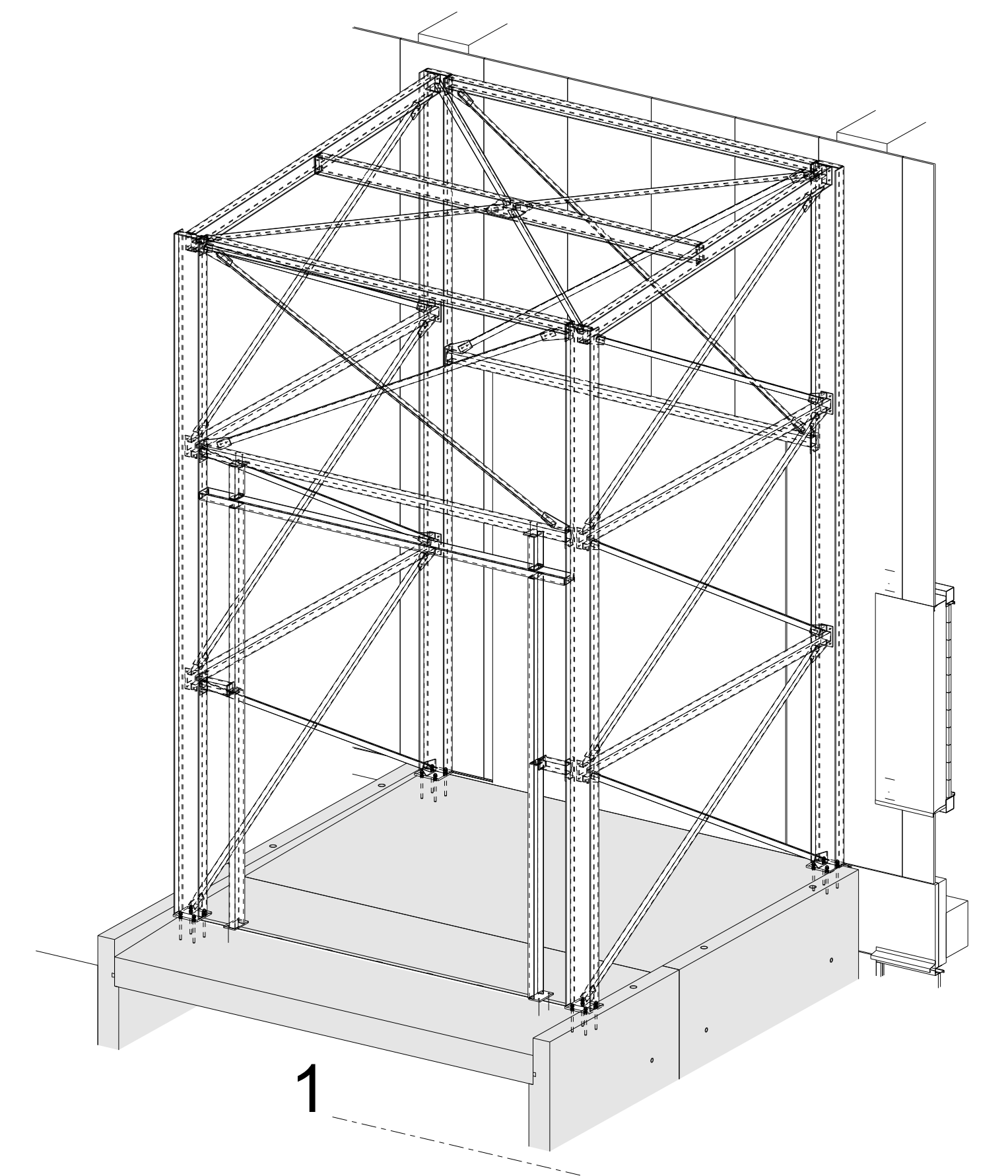

3D

A10

A10

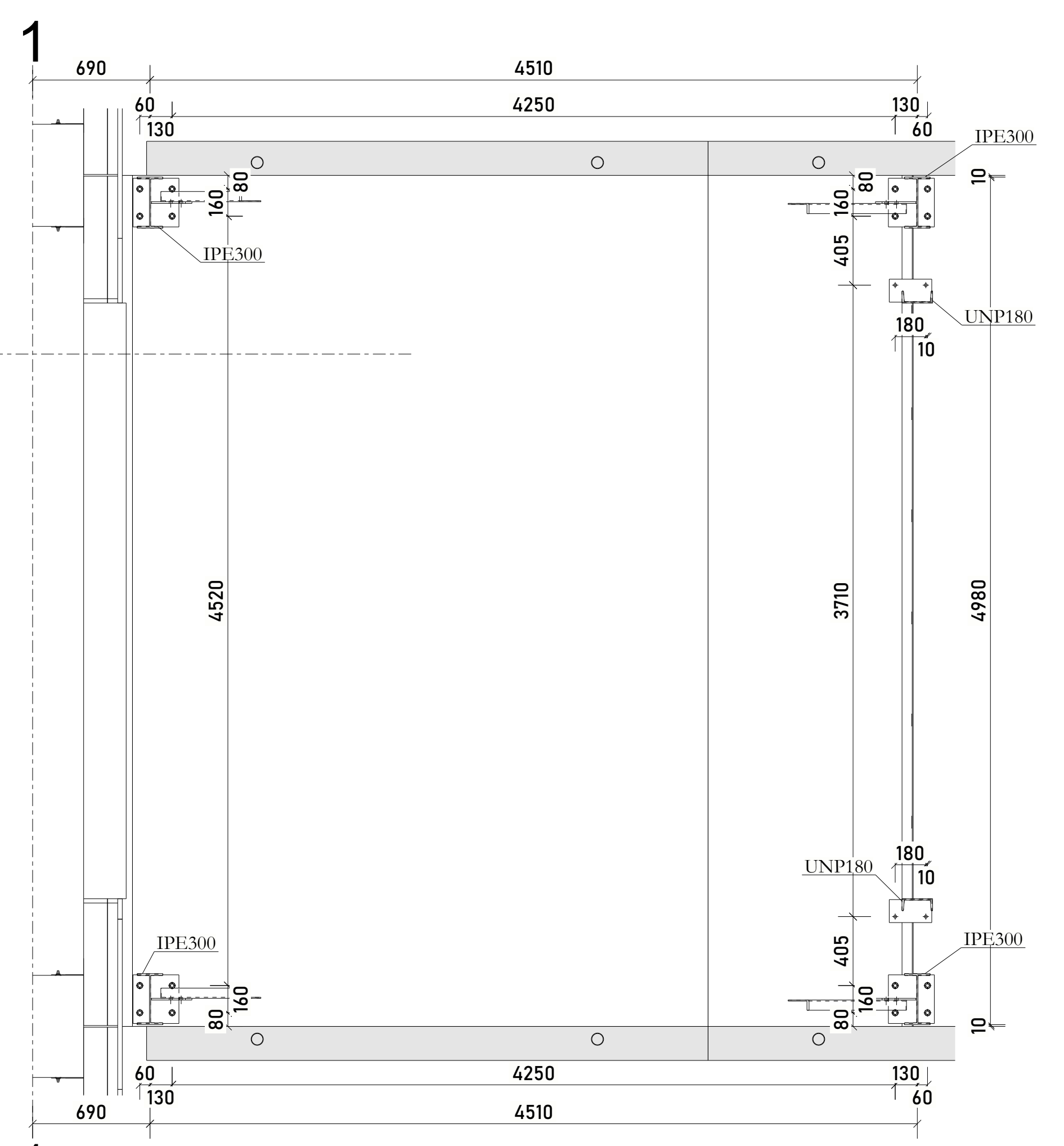

E - E
1:25

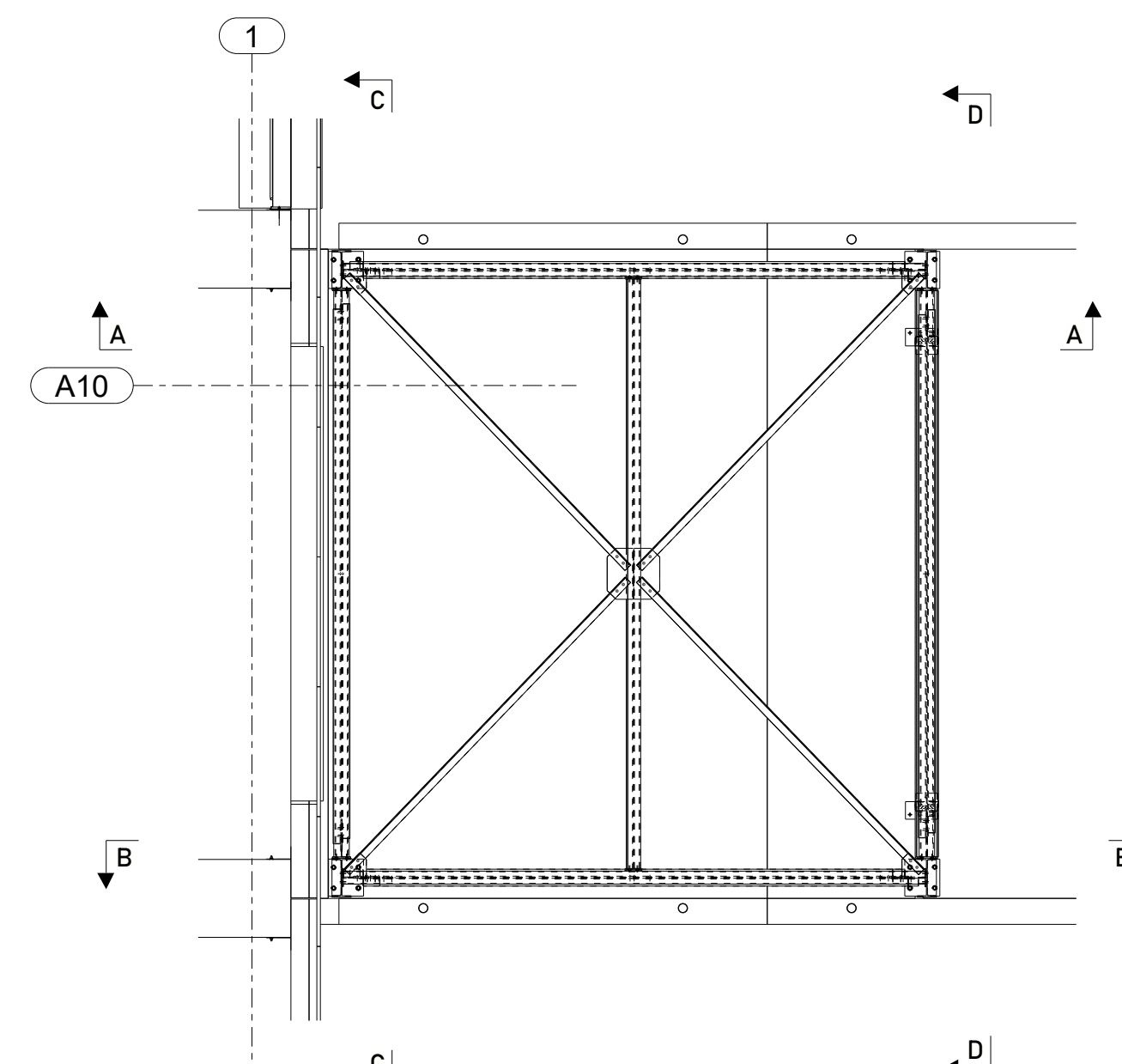

GROUND FLOOR

Notes:
 Classifications
 Performance class 1
 Functional tolerance class PI
 Preprocessing grade
 Material qualities, unless noted otherwise
 Rolled sections NBN-EN 10025 : S235JH
 Plates T > 10 mm NBN-EN 10025 : S355J2
 Cold formed sections NBN-EN 10219 : S235JRH
 Bolts, anchors and threaded ends, unless noted otherwise
 Bolts ISO 4014 - class 8.8
 Anchors (hot dip galvanized) Class 4.6 (bended) / class 8.8 (straight)
 Threaded ends (hot dip galvanized) Class 8.8
 Welds a=4 mm (unless noted otherwise)
 Surface treatments

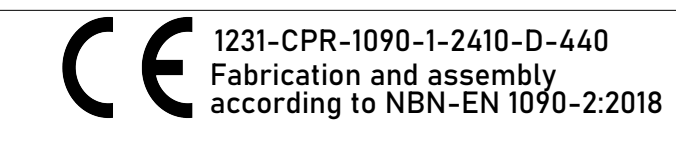

R00	30/03/26	GV	For approval
Index	Date	Drawn by	Modifications

STADSBADER

Project owner

Site

Architect

ACCESS RAMP
Steel Construction

For approval

IN	OUT
Date	30/03/26

Plan number: **0056**

Index: **R00** 30/03/26

Date: **27/03/26**

Scale: **1:25 1:50**

File number:

N.V. STADSBADER S.A.
 Kanaalstraat 1, B-8530 Harelbeke
 T +32 56 28 04 44
 info@stadsbader.com • www.stadsbader.com

Drawn by: GV
 Project engineer: HM