

ROOF OVERVIEW +1290  
1:150

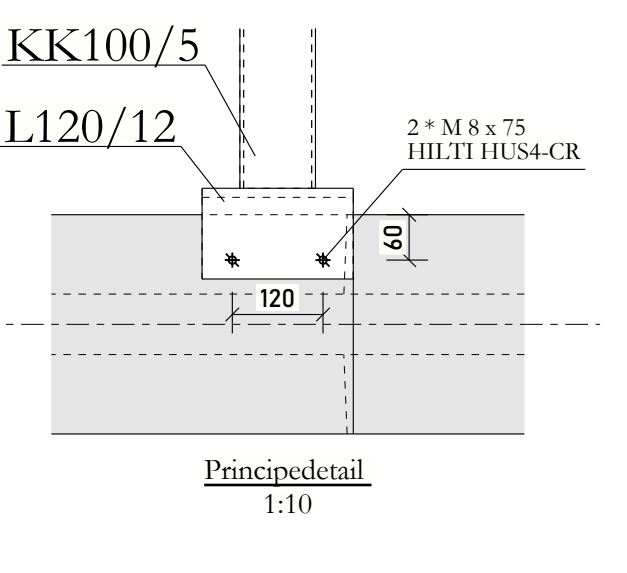
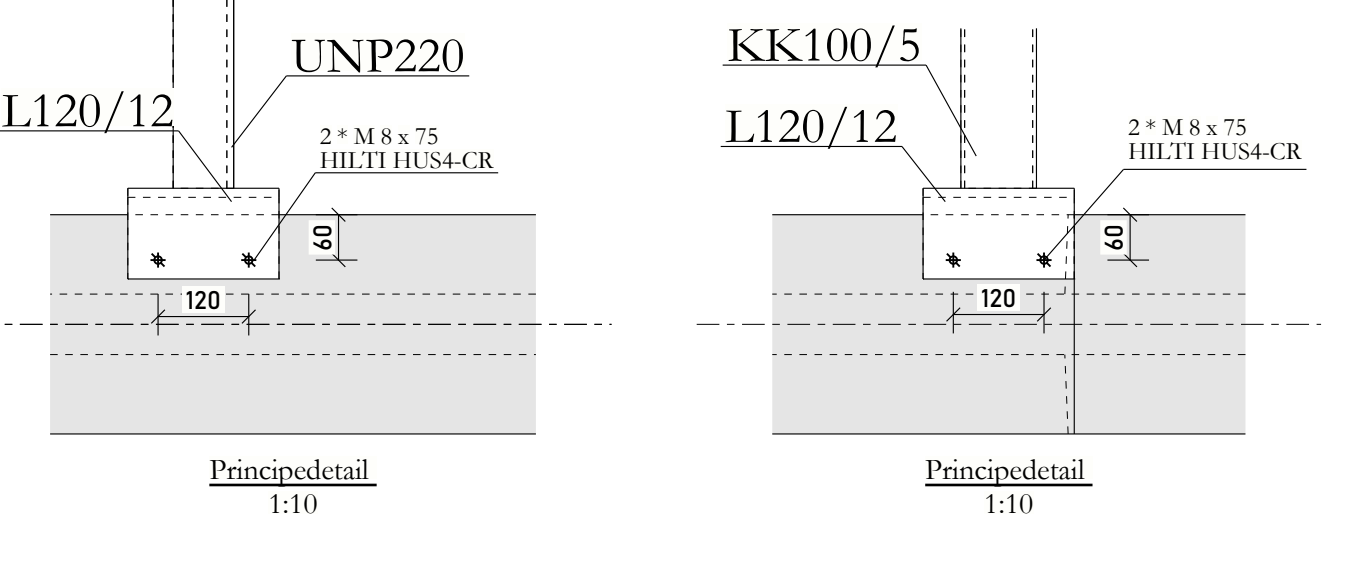
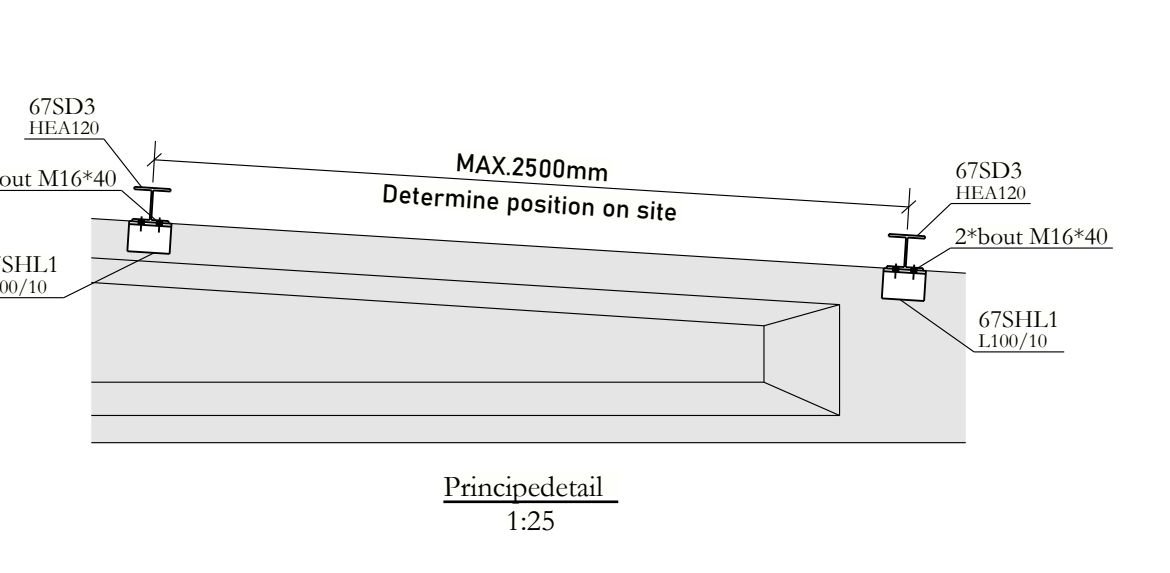
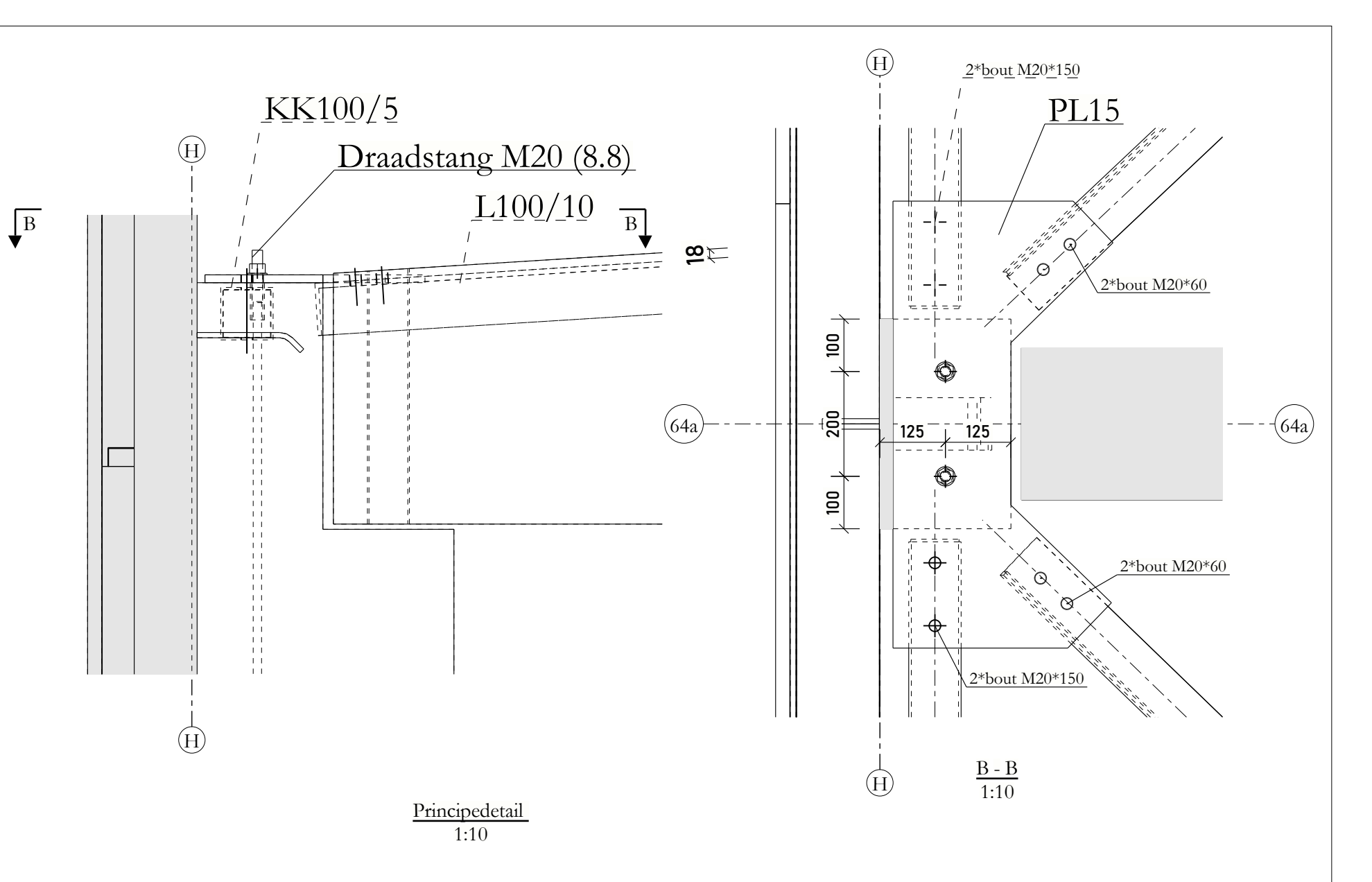
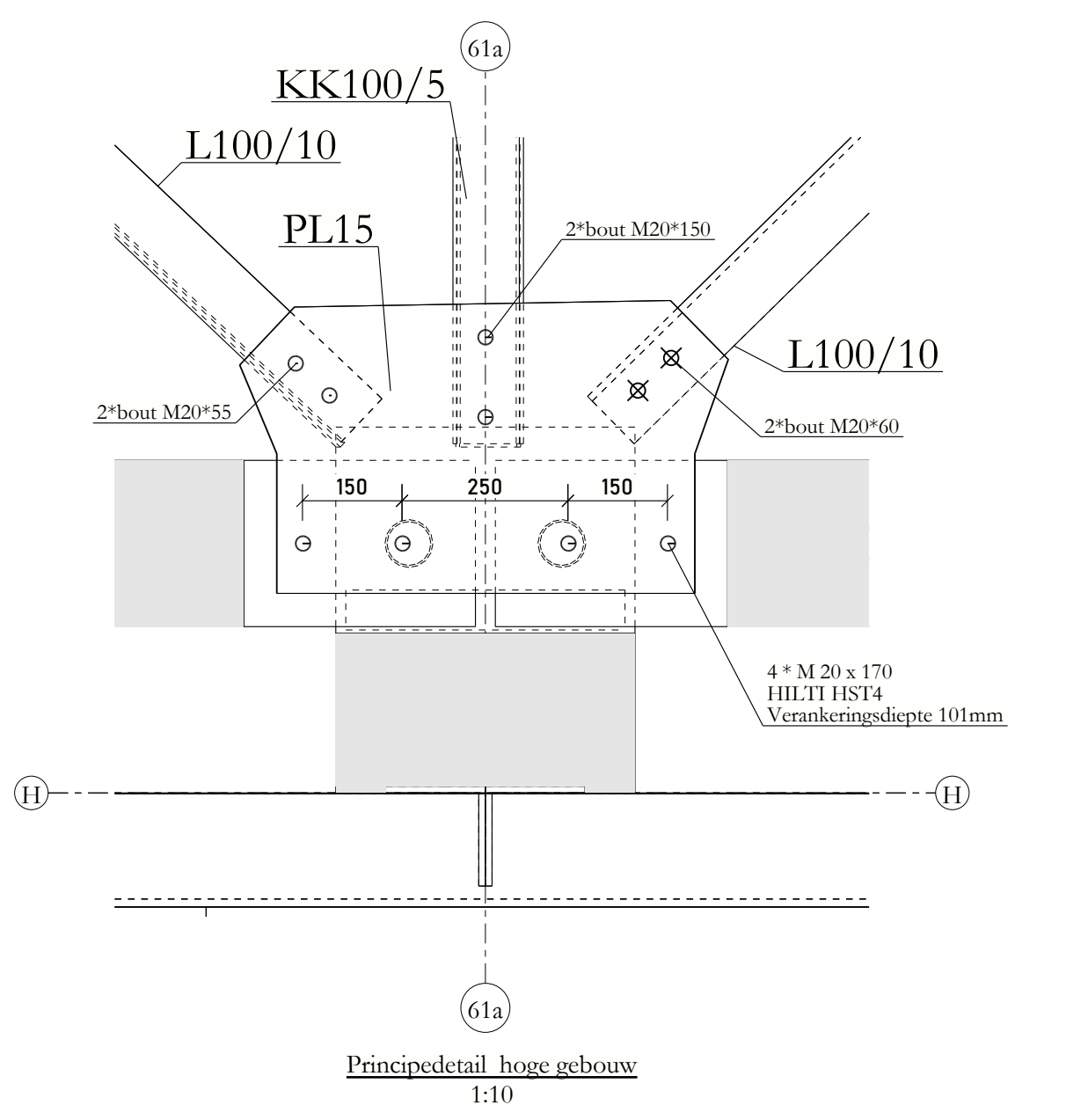
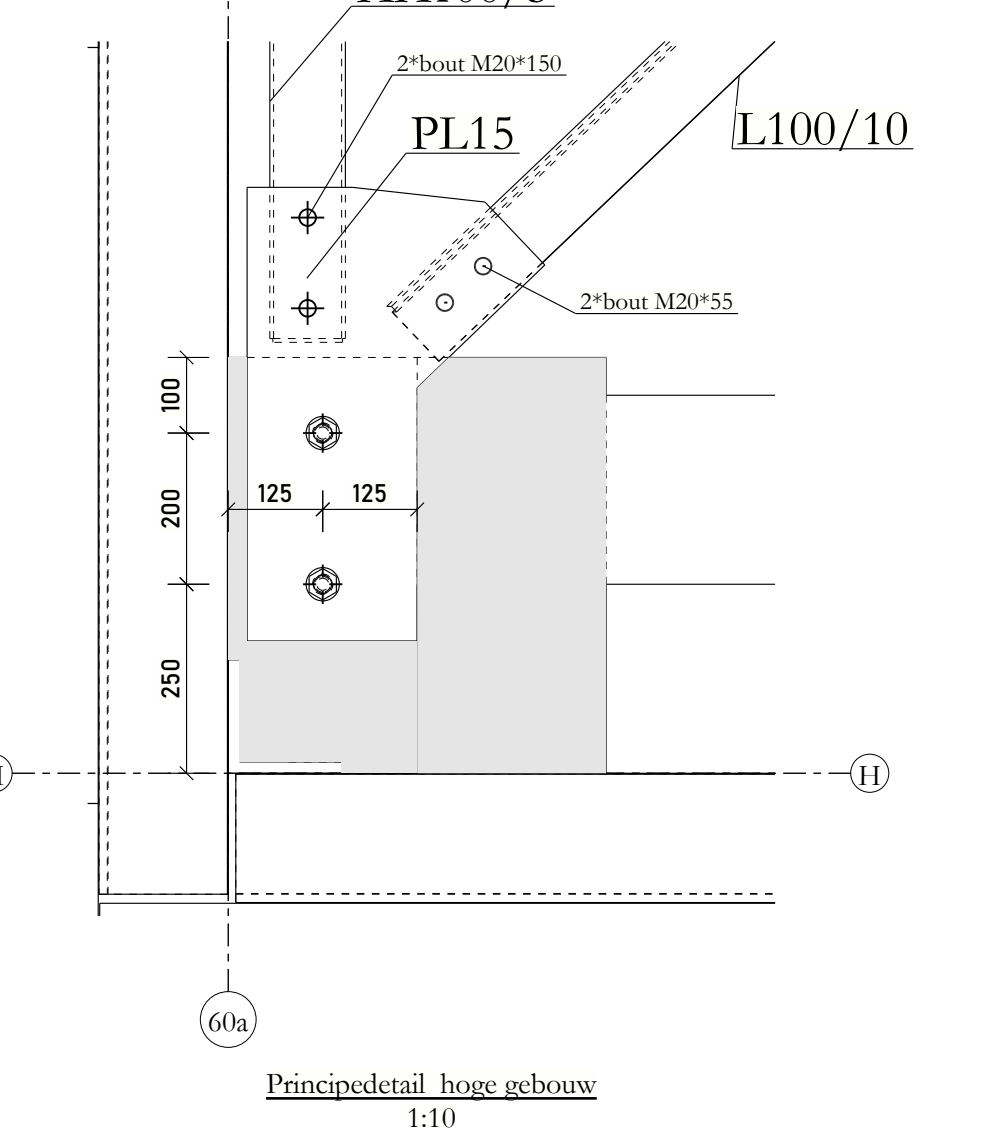
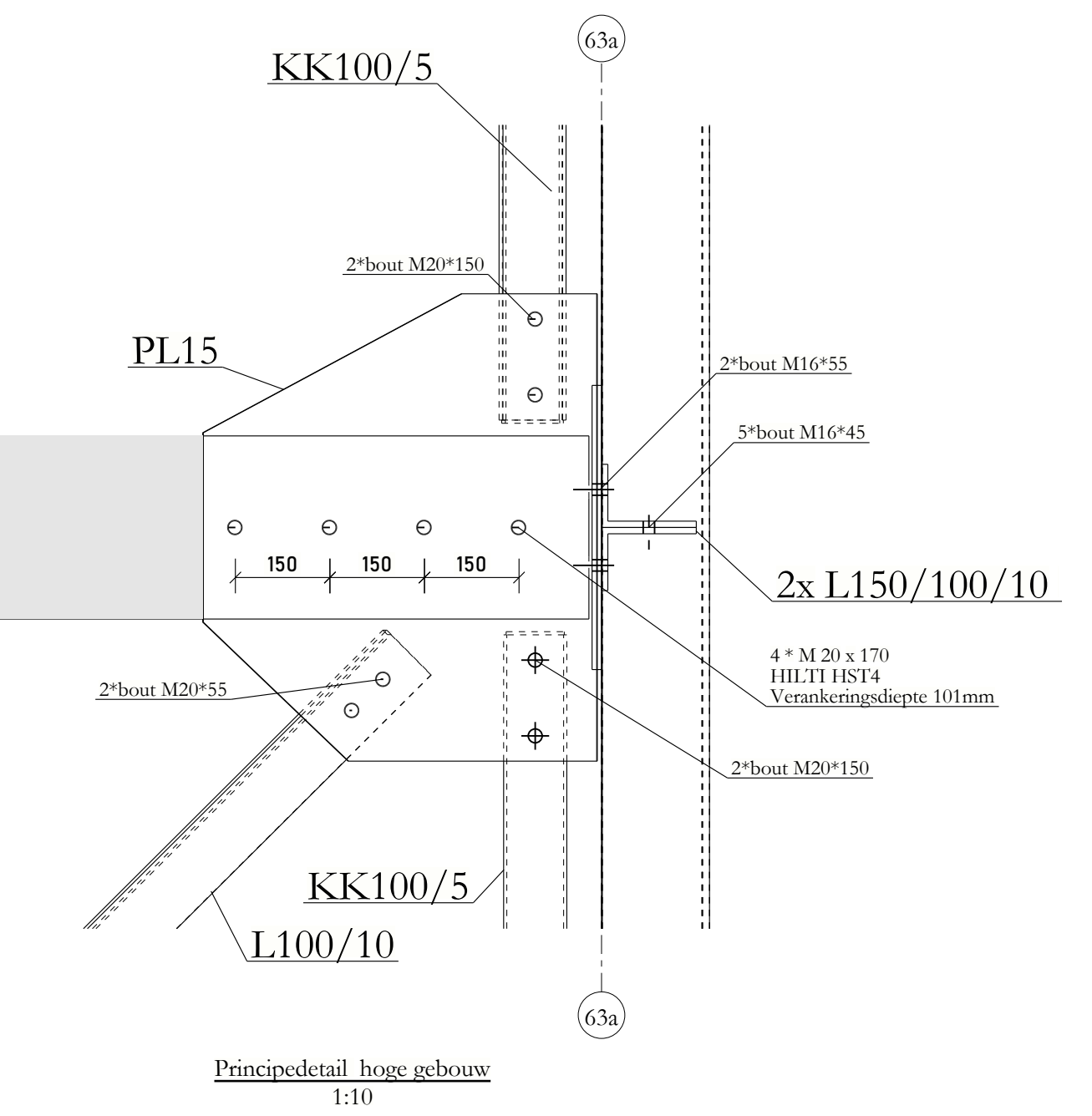
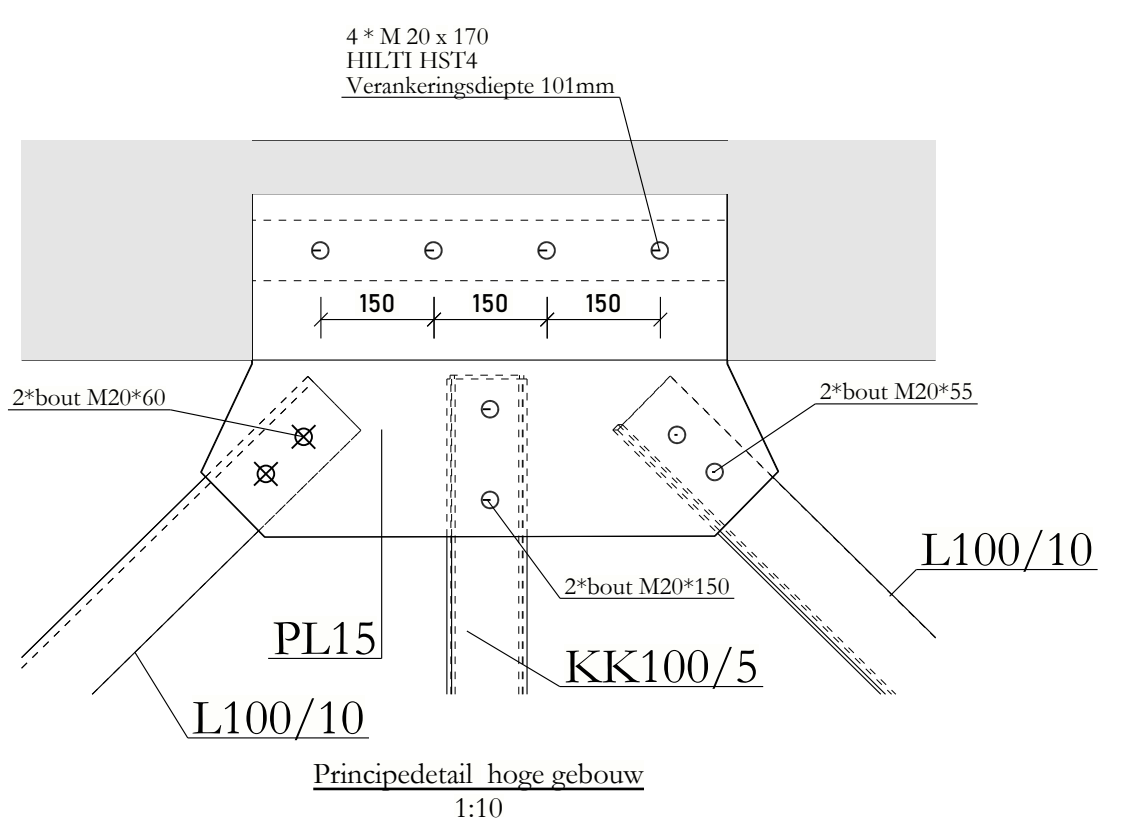
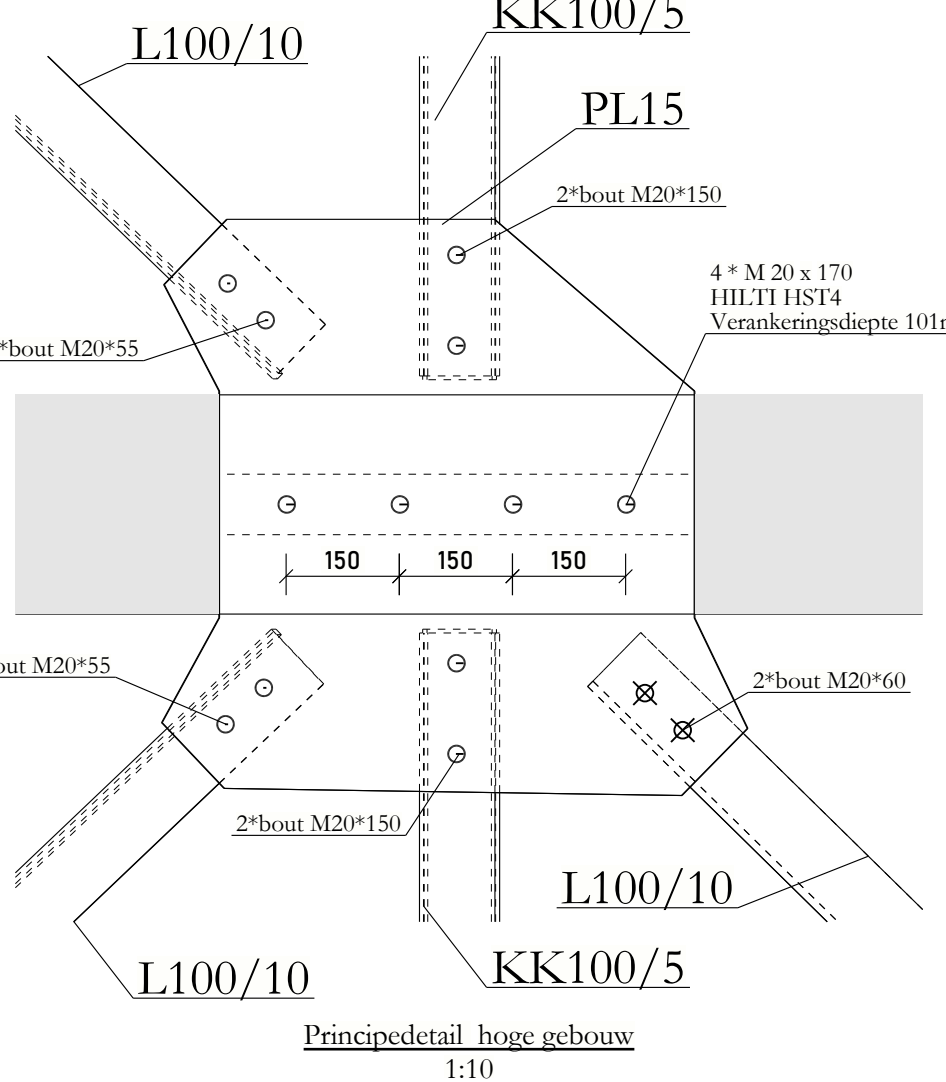
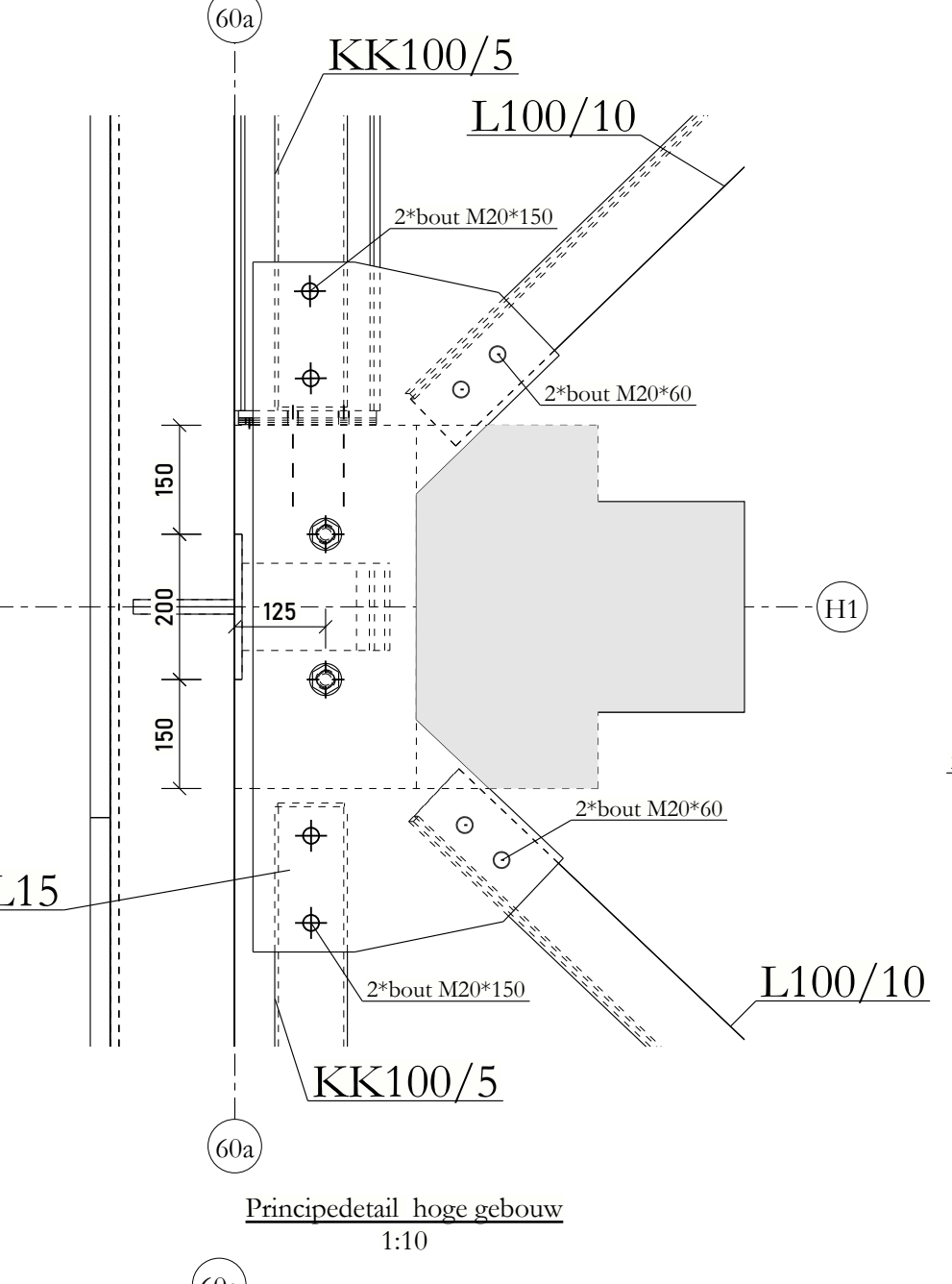
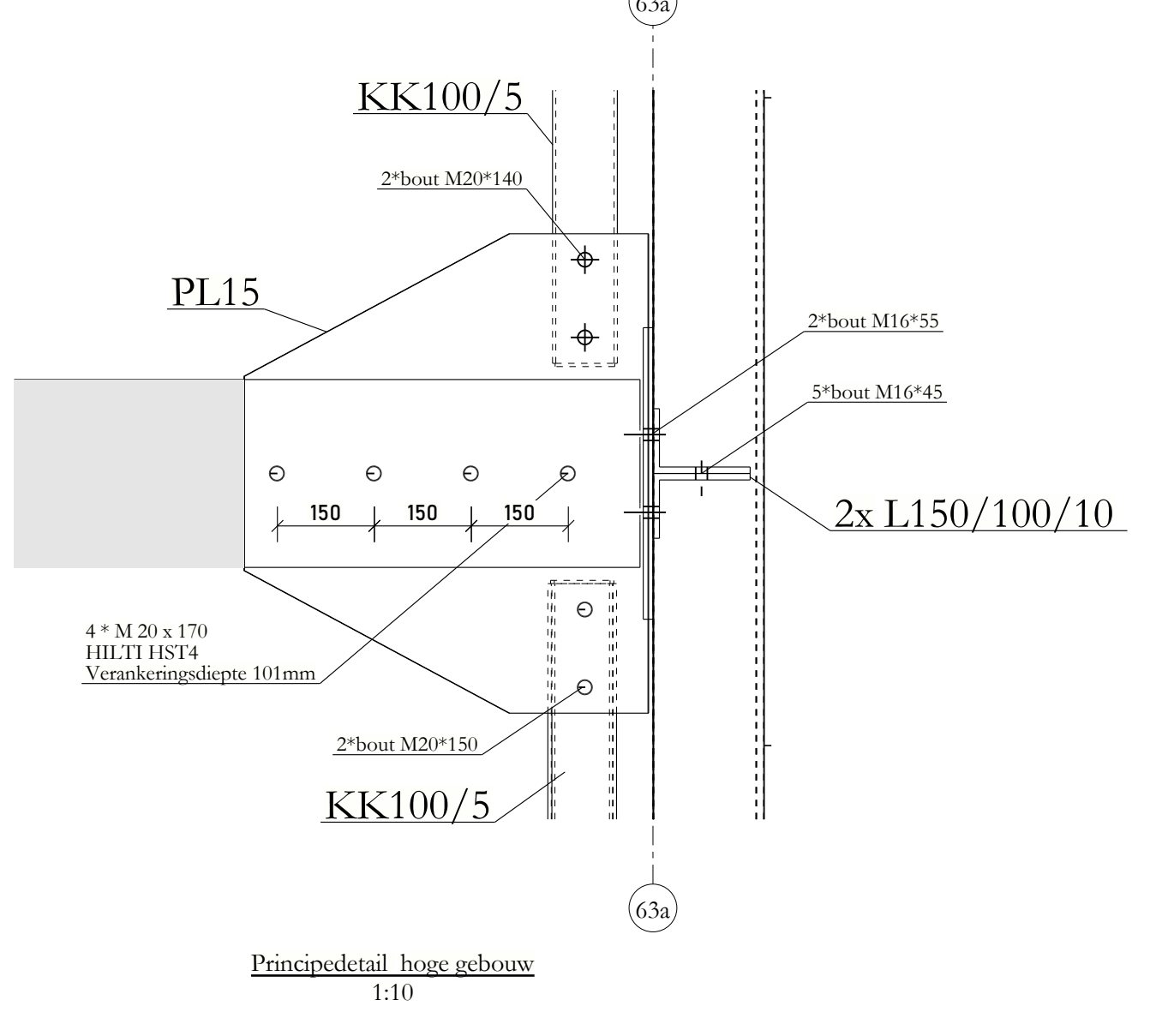
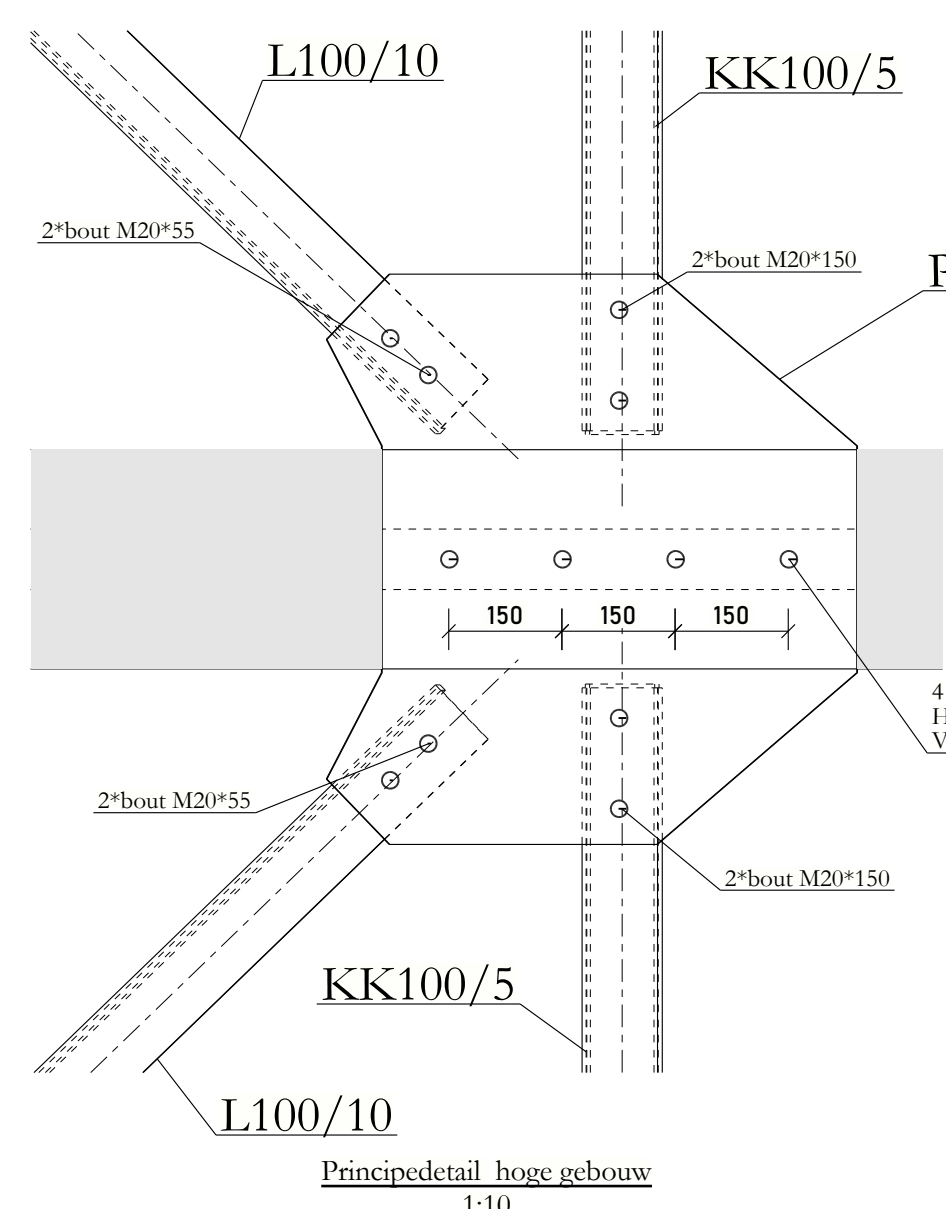
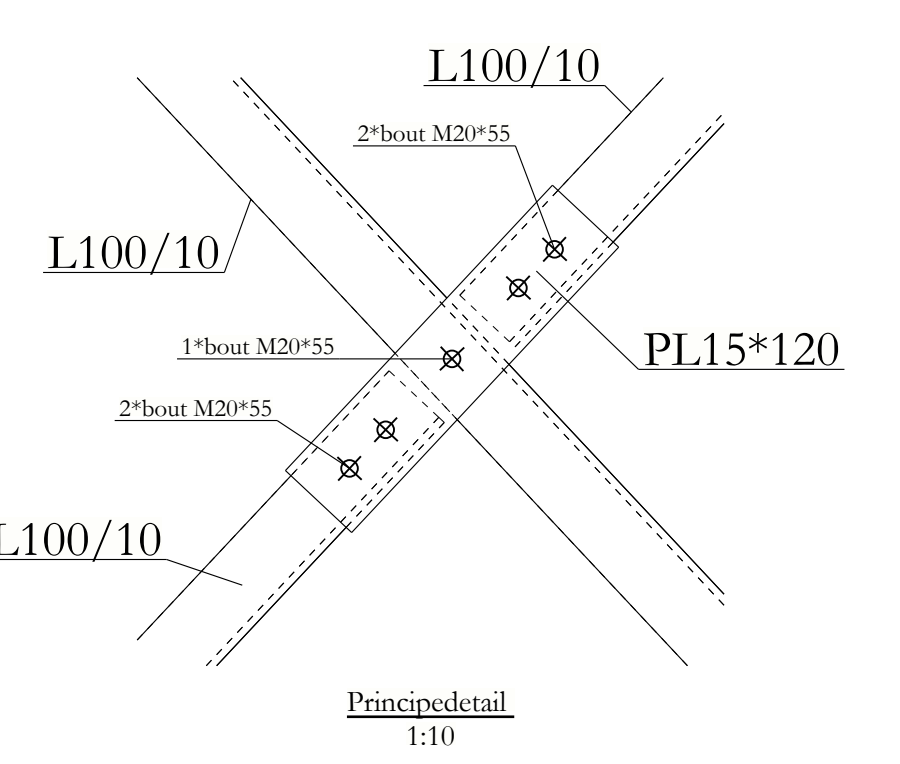
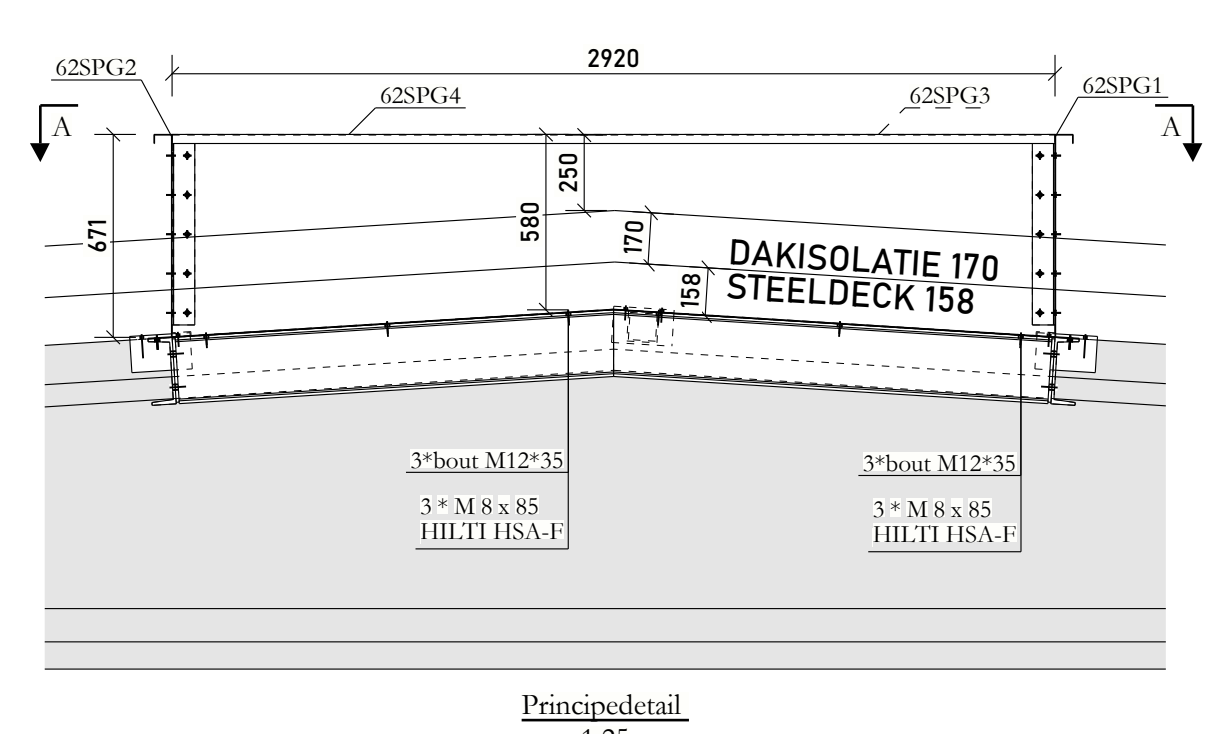
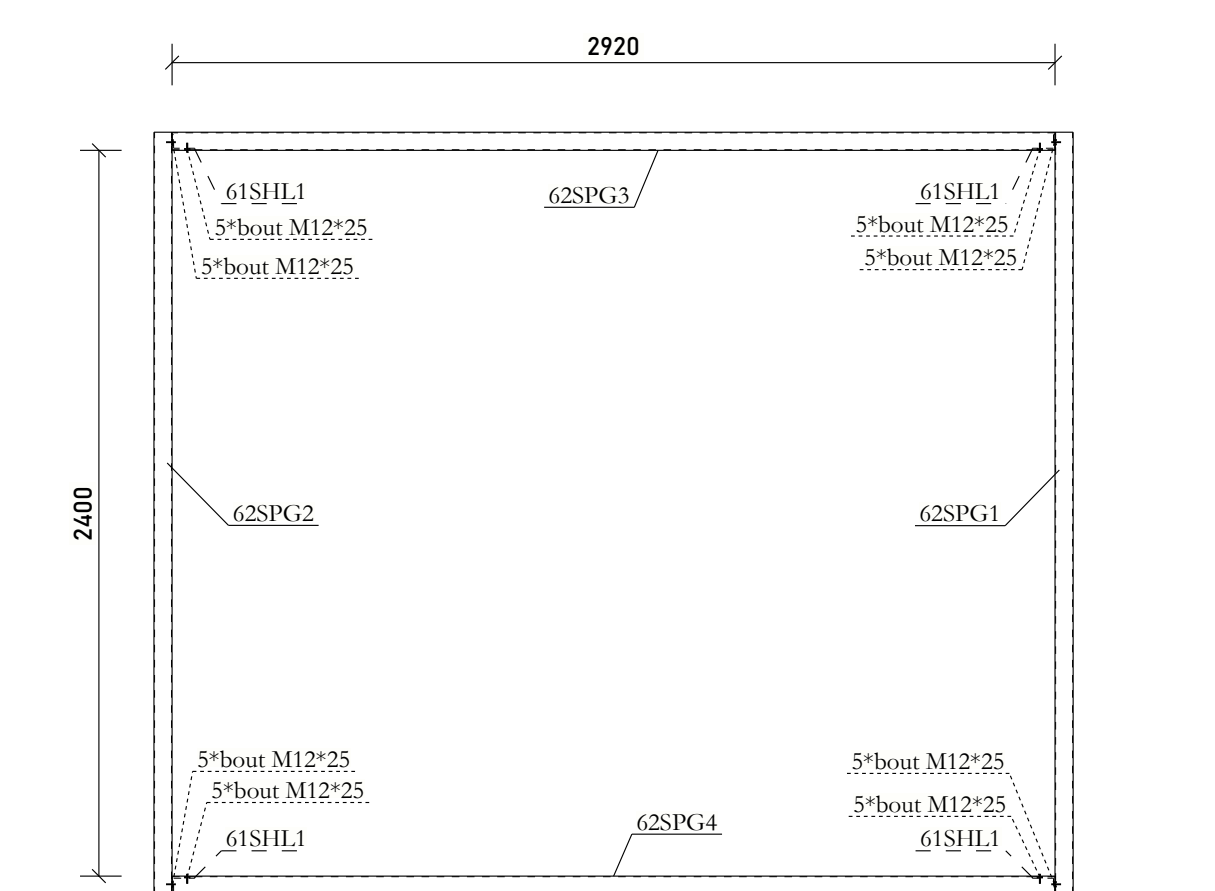
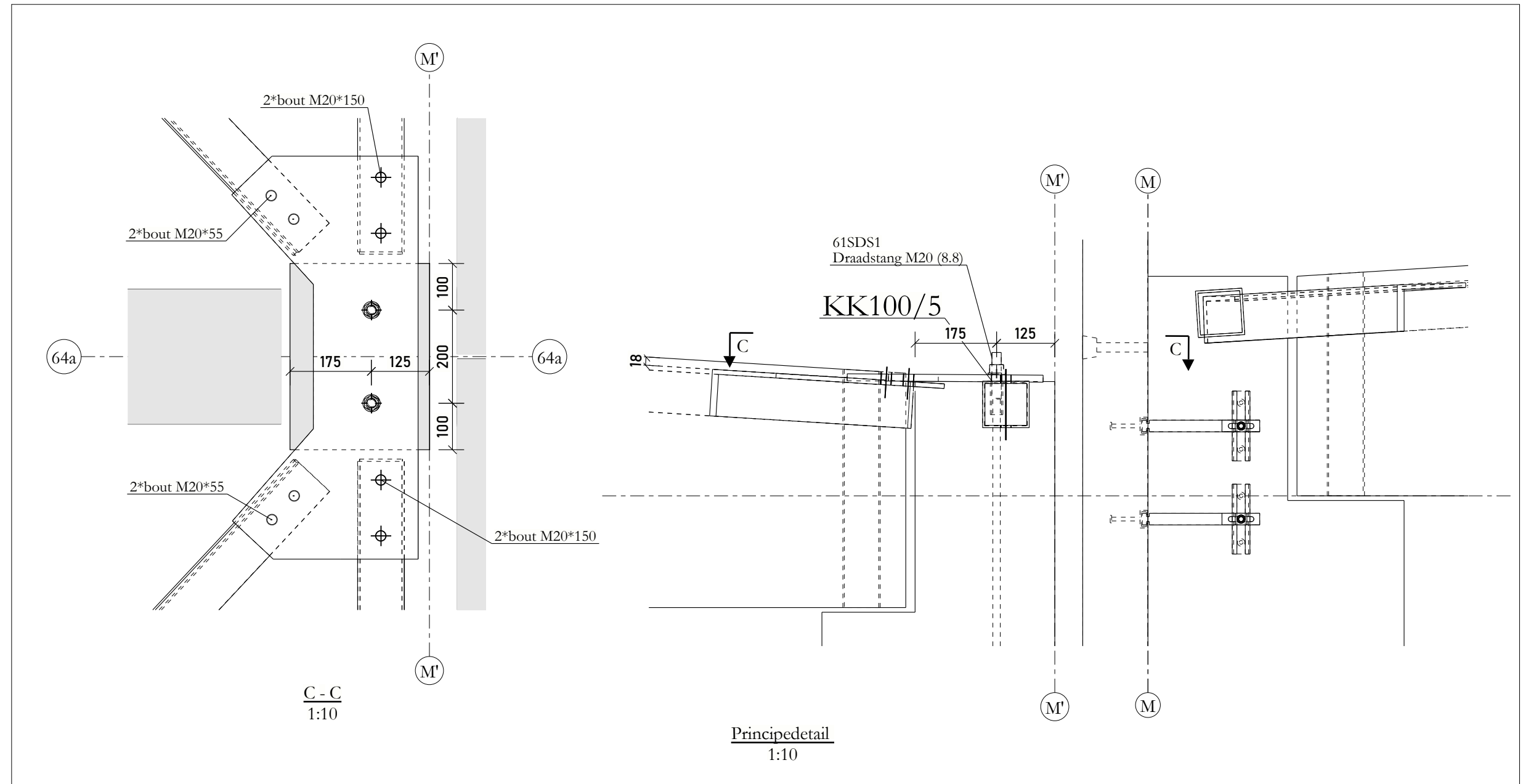
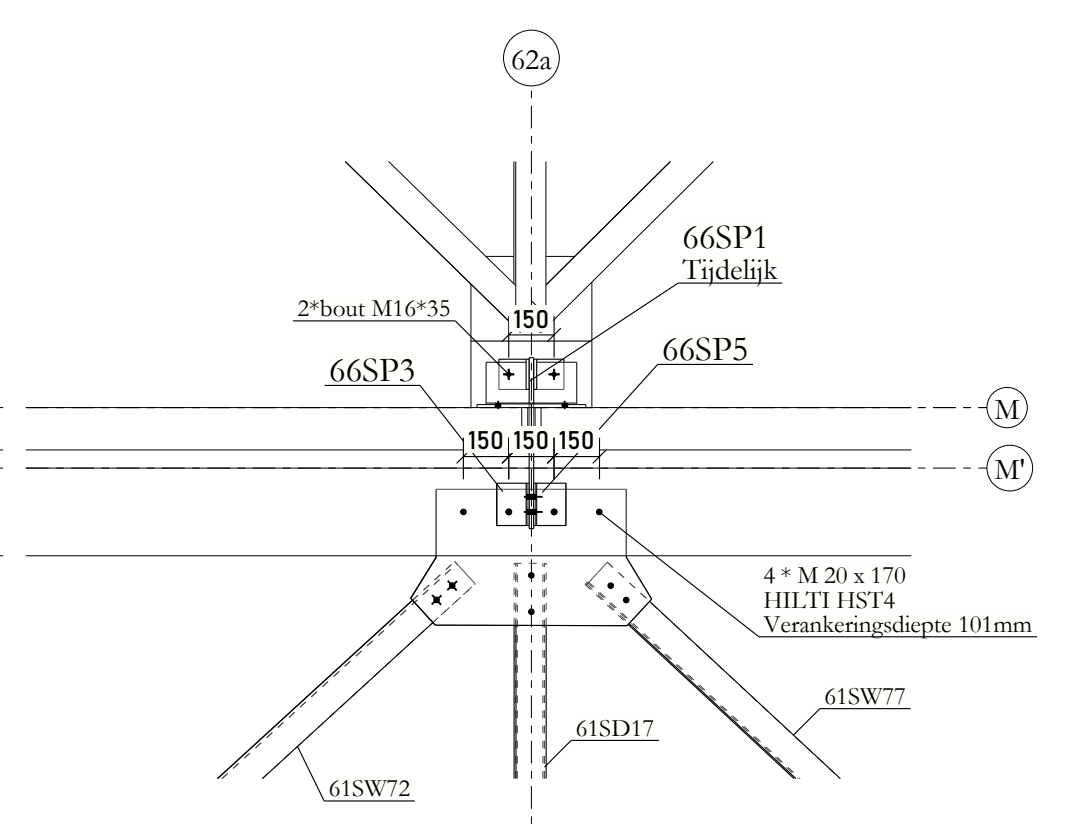
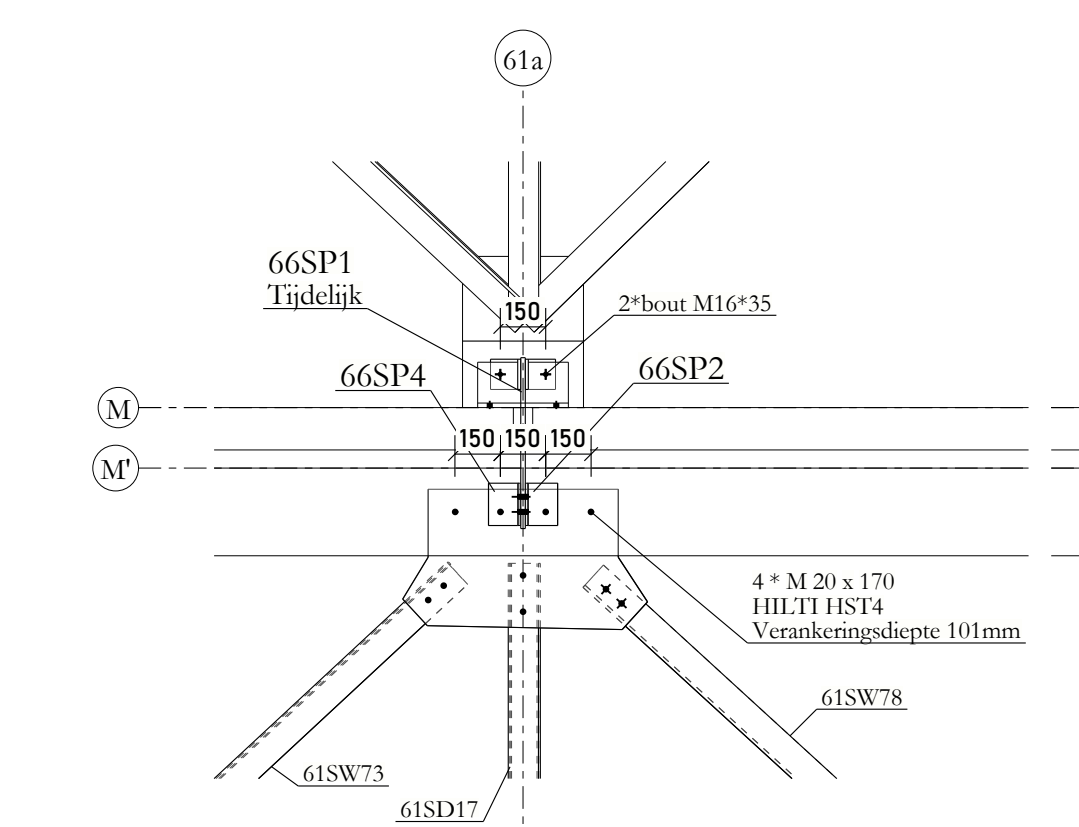

**Notes:**

Classifications	Performance class 1	CE 1231-CPR-1090-4-2410-0-440 Fabrication and assembly according to NBN-EN 1090-2:2018
Preprocessing grade	P1	
Material qualities, unless noted otherwise		
Rolled sections	NBN-EN 10025 : S235JH	
Plates T > 10 mm	NBN-EN 10025 : S355J2	
Cold formed sections	NBN-EN 10219 : S235JRH	
Bolts, anchors and threaded ends, unless noted otherwise		
Bolts	ISO 4014 - class 8.8	
Anchors (hot dip galvanized)	Class 4.6 (bended) / class 8.8 (straight)	
Threaded ends (hot dip galvanized)	Class 8.8	
Welds	a=4mm (unless noted otherwise)	
Surface treatments	Conserving	

R02	13/03/26	GV	UPDATE: For construction
R01	16/10/25	GV	UPDATE
R00	26/09/25	GV	For construction
Index	Date	Drawn by	Modifications

# STADSBADER

---

**Project owner**

**Site**

**Architect**

---

<p><b>Steel: ROOF OVERVIEW</b> axis 64a to axis 60a</p>	<p>For approval</p> <table border="1" style="margin-left: auto; margin-right: auto;"> <tr> <td>IN</td> <td>OUT</td> </tr> <tr> <td></td> <td>13/03/26</td> </tr> </table> <p>Plan number: <b>0107</b></p> <p>Index: <b>R02</b> 13/03/26</p> <p>Date: <b>25/09/25</b></p> <p>Scale: <b>1:10 1:25 1:150</b></p> <p>File number:</p>	IN	OUT		13/03/26
IN	OUT				
	13/03/26				

---

N.V. STADSBADER S.A.  
Kanaalstraat 1, B-8530 Harelbeke  
T +32 56 28 04 44  
info@stadsbader.com • www.stadsbader.com

Drawn by: GV  
Project engineer: AS