

V. SUPERIOR
1:10

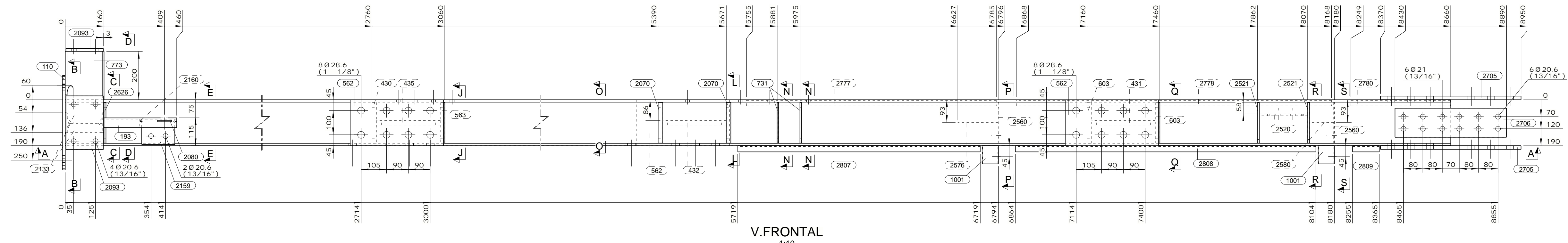

V. FRONTAL
1:10

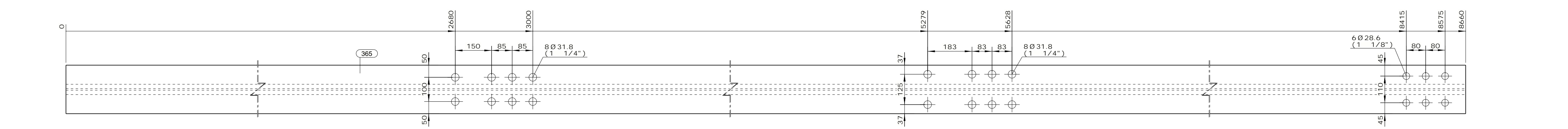

SECCION A - A
1:10

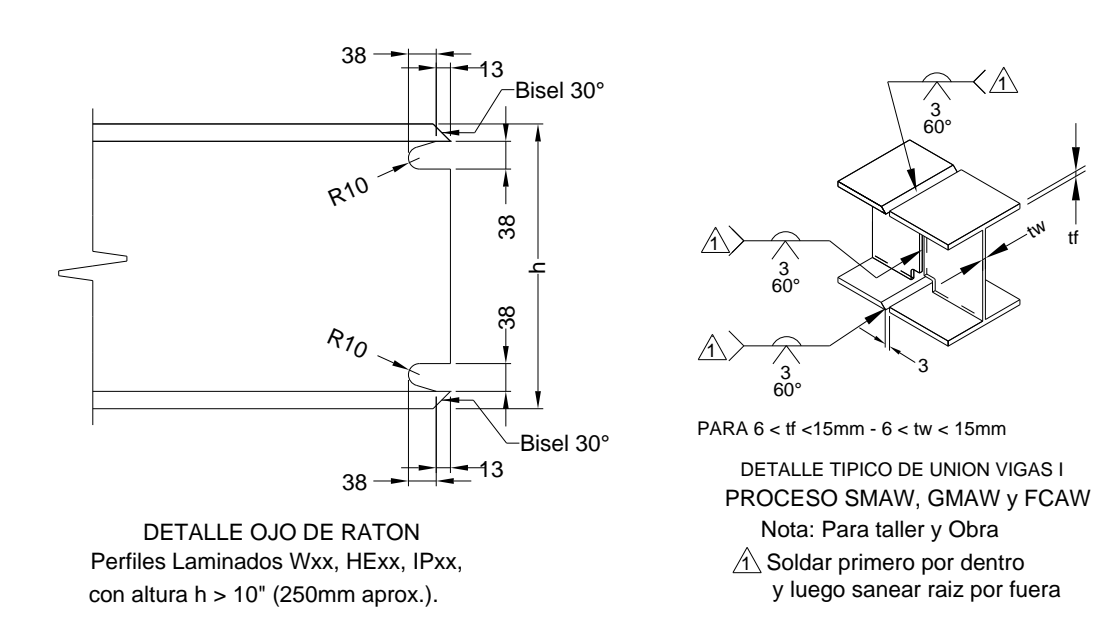

LISTA PARTES DE CONJUNTO									
Conjunto: K-87		Cantidad: 1	Long. (mm): 8962						
Descripción: ENSAMBLE DE COLUMNA									
PARTE	CUNT	CANT	DESCRIPCION	LONG	P. UNIT	P. TOTAL	A. TOTAL	MATERIAL	
110	1	1	PL12*360	390	13.23	13.23	0.291	ASTM A572 Gr.50	
125	1	1	IPE160	277	4.36	4.36	0.172	ASTM A572 Gr.50	
193	1	1	CHX5.4	300	2.43	2.43	0.104	ASTM A36 Gr.36	
365	1	1	HEA200	8660	365.94	365.94	9.838	ASTM A572 Gr.50	
430	3	3	PL19*244	168	6.11	18.32	0.283	ASTM A572 Gr.50	
431	1	1	PL19*197	262	7.69	7.69	0.118	ASTM A572 Gr.50	
432	1	1	PL19*247	262	9.64	9.64	0.146	ASTM A572 Gr.50	
435	2	2	PL19*247	262	9.64	19.28	0.292	ASTM A572 Gr.50	
562	4	4	PL25*190	385	14.36	57.45	0.706	ASTM A572 Gr.50	
563	2	2	PL19*247	168	6.18	12.37	0.196	ASTM A572 Gr.50	
565	1	1	PL19*247	168	6.18	6.18	0.097	ASTM A572 Gr.50	
603	2	2	PL19*97	168	2.42	4.85	0.083	ASTM A572 Gr.50	
731	4	4	PL6*97	168	0.77	3.06	0.139	ASTM A36 Gr.36	
752	1	1	PL19*197	168	4.93	4.93	0.079	ASTM A572 Gr.50	
753	1	1	PL19*194	168	4.85	4.85	0.076	ASTM A572 Gr.50	
773	1	1	IPE160	200	3.15	3.15	0.125	ASTM A572 Gr.50	
1001	2	2	PHR-C 203X67X2.0	75	0.42	0.84	0.108	ASTM A1011 Gr.50	
2070	2	2	PL19*97	168	2.42	4.85	0.083	ASTM A572 Gr.50	
2080	1	1	PL6*60	70	0.20	0.20	0.010	ASTM A36 Gr.36	
2093	3	3	PL12*222	154	3.22	9.66	0.232	ASTM A572 Gr.50	
2130	1	1	IPE160	277	4.36	4.36	0.172	ASTM A572 Gr.50	
2133	4	4	PL6*38	143	0.26	1.03	0.050	ASTM A36 Gr.36	
2159	1	1	PL8*105	136	0.90	0.90	0.032	ASTM A36 Gr.36	
2160	2	2	PL8*35	91	0.20	0.41	0.015	ASTM A36 Gr.36	
2520	1	1	PL8*172	200	2.15	2.15	0.086	ASTM A36 Gr.36	
2521	4	4	PL8*97	168	1.02	4.08	0.145	ASTM A36 Gr.36	
2560	2	2	PL3*167	168	0.66	1.32	0.114	ASTM A36 Gr.36	
2576	1	1	PL3*166	167	0.65	0.65	0.029	ASTM A36 Gr.36	
2580	1	1	PL3*99	167	0.39	0.39	0.017	ASTM A36 Gr.36	
2626	2	2	PL8*97	168	1.02	2.04	0.072	ASTM A572 Gr.50	
2705	2	2	PL15*200	580	13.66	27.32	0.511	ASTM A572 Gr.50	
2706	2	2	PL15*120	460	6.50	13.00	0.256	ASTM A572 Gr.50	
2777	1	1	LX1X/8	1030	1.22	1.22	0.101	ASTM A36 Gr.36	
2778	1	1	LX1X/8	1300	1.54	1.54	0.127	ASTM A36 Gr.36	
2780	1	1	LX1X/8	410	0.49	0.49	0.040	ASTM A36 Gr.36	
2807	1	1	LX1X/8	1000	1.19	1.19	0.098	ASTM A36 Gr.36	
2808	1	1	LX1X/8	1240	1.47	1.47	0.122	ASTM A36 Gr.36	
2809	1	1	LX1X/8	110	0.13	0.13	0.011	ASTM A36 Gr.36	
Taller	12	12	TORNILLO A325 1"X2 1/2	64	7.08	7.08	N.A.	A325	
Taller	6	6	TORNILLO A325 3/4"X2 1/2	64	1.76	1.76	N.A.	A325	

PESO TOTAL DEL PLANO = 625.82 kg + 3 % DE SOLDADURAS = 644.59 kg AREA TOTAL DEL PLANO = 15.15 m2

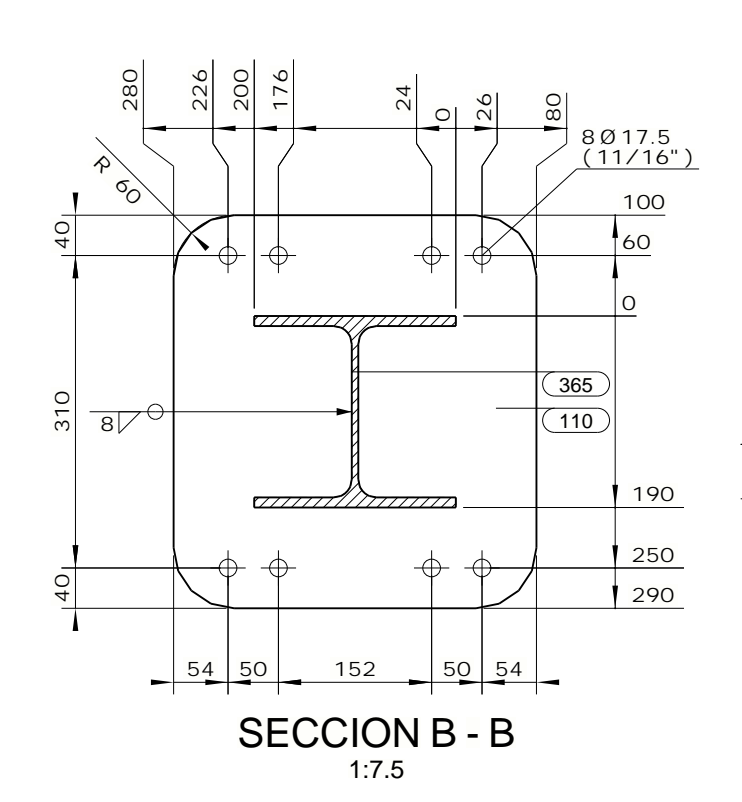

SECCION B - B
1:7.5

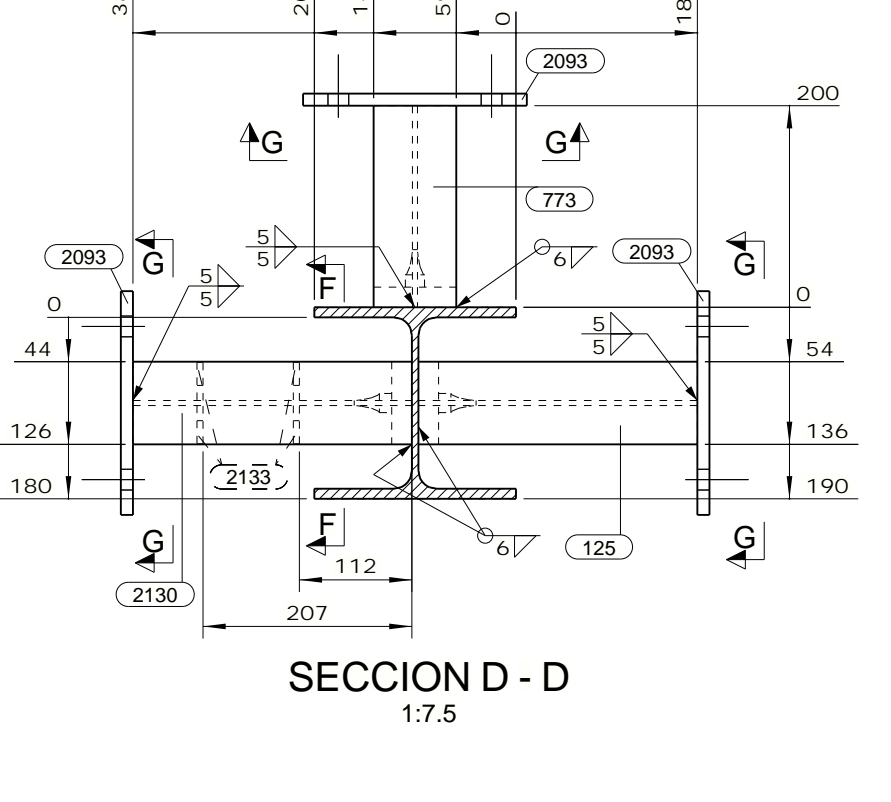

SECCION D - D
1:7.5

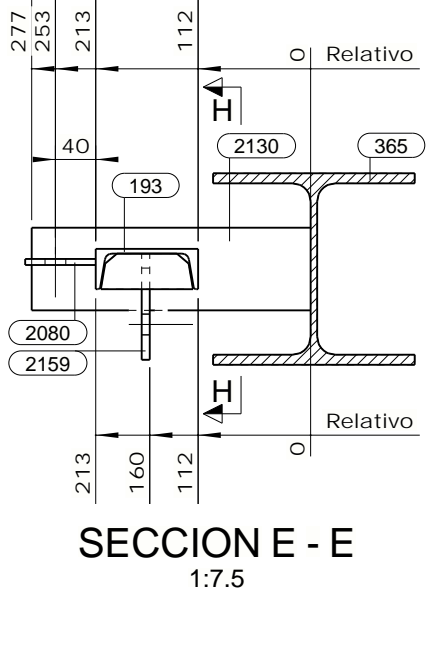

SECCION E - E
1:7.5

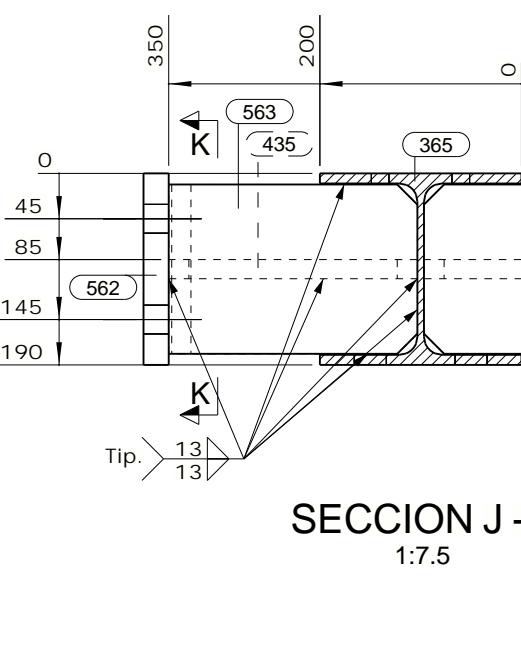

SECCION J - J
1:7.5

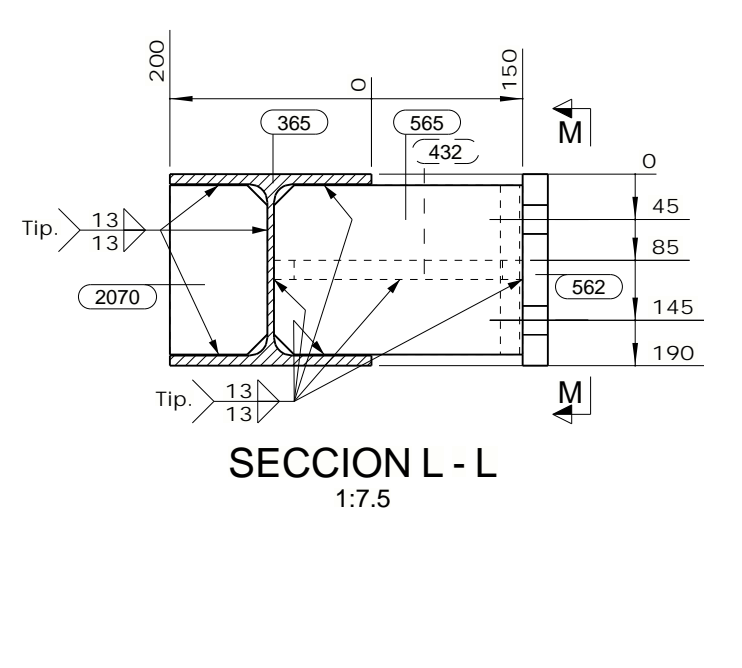

SECCION L - L
1:7.5

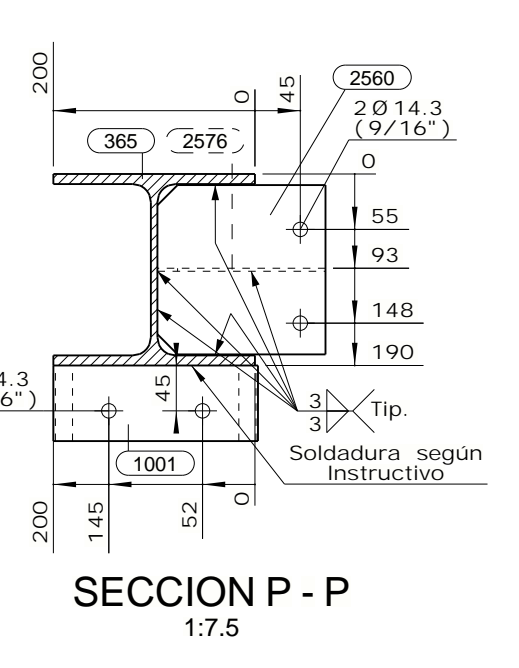

SECCION P - P
1:7.5

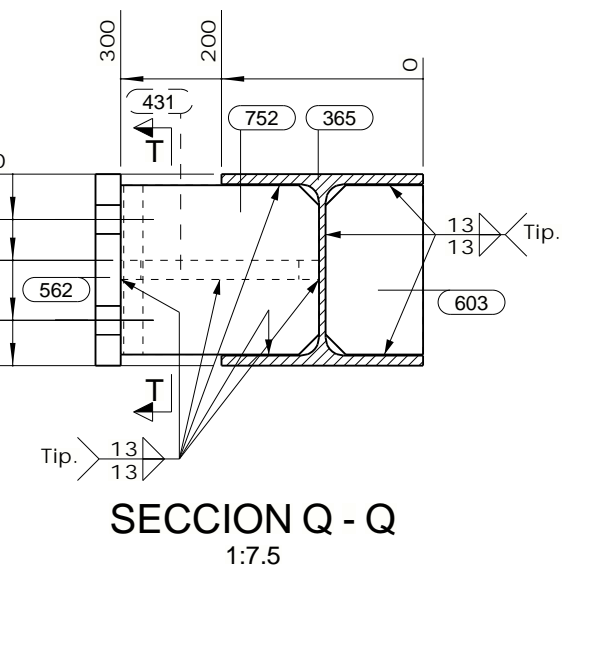

SECCION Q - Q
1:7.5

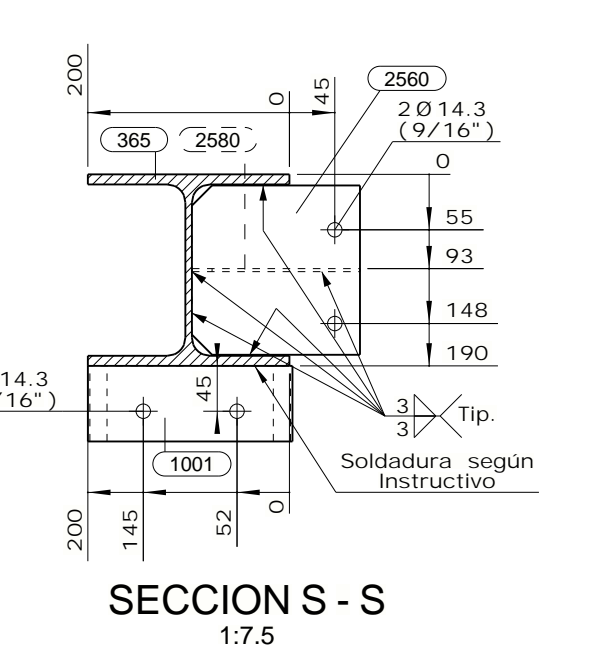

SECCION S - S
1:7.5

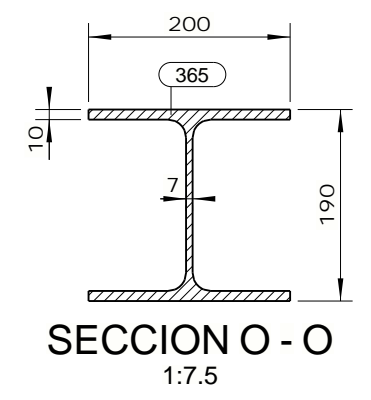

SECCION O - O
1:7.5

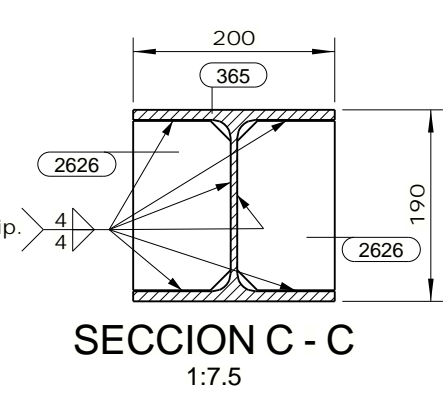

SECCION C - C
1:7.5

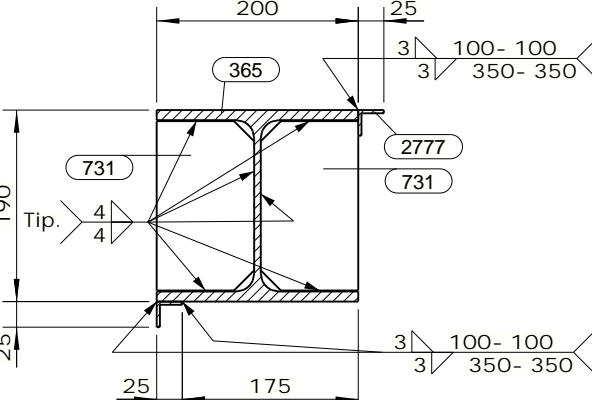

SECCION N - N
1:7.5

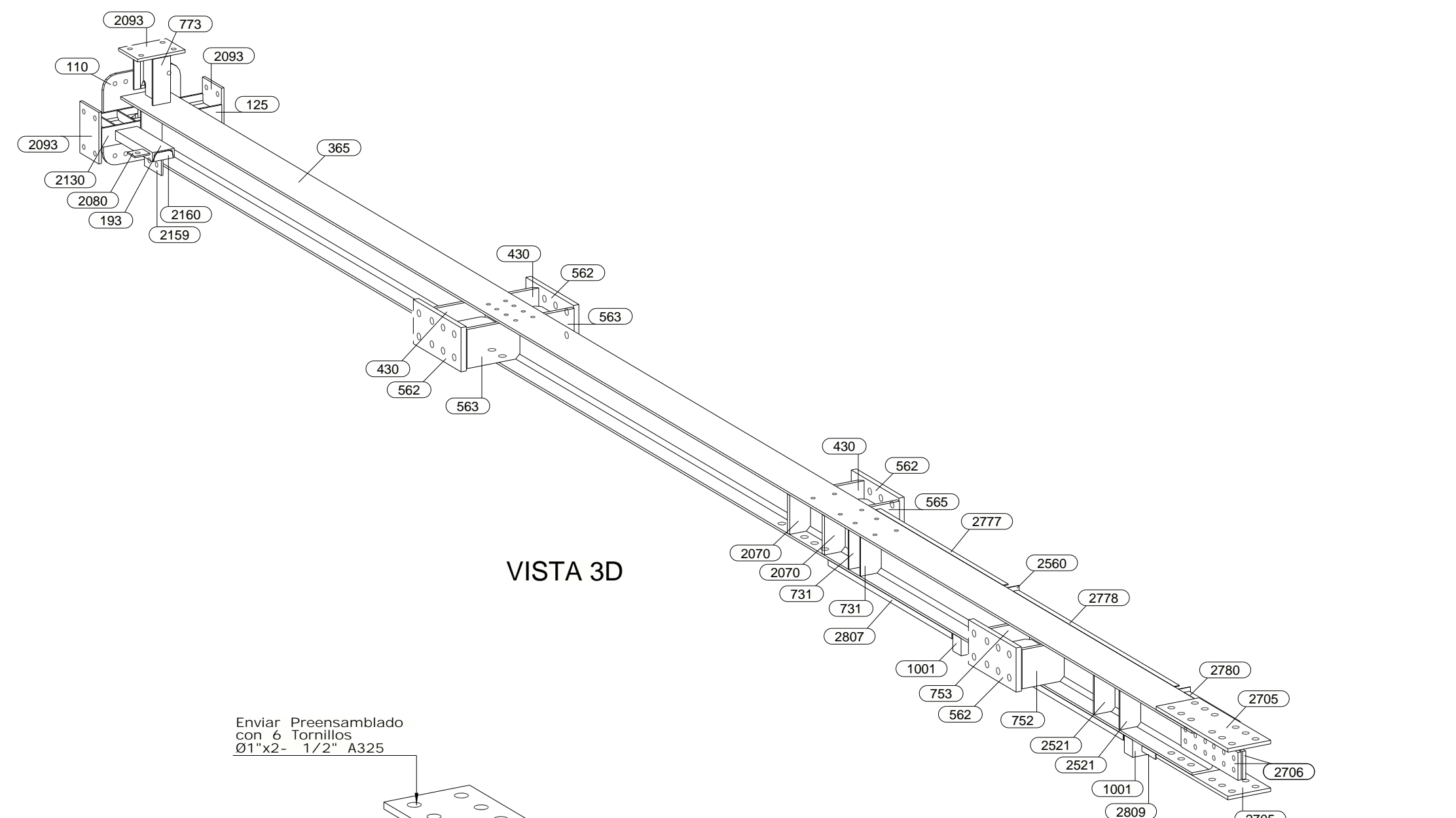

VISTA 3D

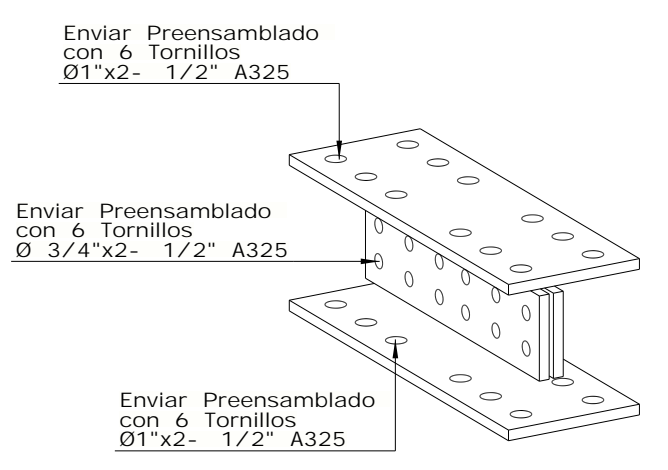

VISTA 3D

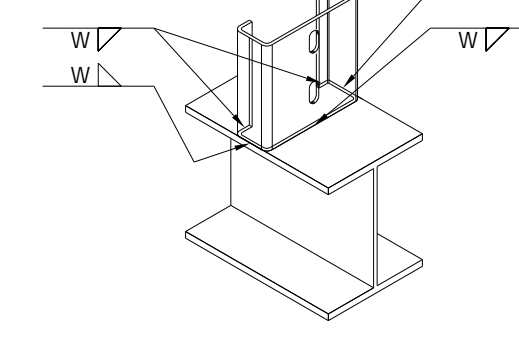
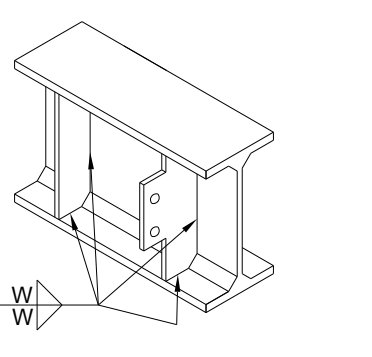

SECCION O - O 1:7.5

SECCION C - C 1:7.5

SECCION N - N 1:7.5

SECCION L - L 1:7.5

SECCION P - P 1:7.5

SECCION Q - Q 1:7.5

SECCION S - S 1:7.5

Detalle UNION PLATINA CORTANTE Y ATIESADOR
PROCESO SMAW, GMAW y FCAW
Nota: W=Ver tabla anexa

Detalle UNION VIGA LAMINADA CON PORTAPERLIN EN PERFIL TIPO PHR
PROCESO SMAW, GMAW y FCAW
Nota: W=Ver tabla anexa

Detalle JUNTA RESTRICION DE EMPATE EN COLUMNAS I EJE DEBIL + ENPLATE

TAMANOS DE FILETE				
(r)	W=0.49(r)	W=0.68(r)		
3 (1/8")	Gr.36	Gr.50	2	3
4.5 (3/16")			3	4
6 (1/4")			4	5
8 (5/16")			4	6
9 (3/8")			5	7
12 (1/2")			7	9
15 (5/8")			8	11
19 (3/4")			10	13
25 (1")			13	16
32 (1-1/4")			16	22
38 (1-1/2")			19	26
50 (2")			25	35

Acabado / Pintura / Ensayo (SRS)				
Anticorrosivo / Esponsor		Primer Epoxifundido de zinc Grts RAL 7035 P /75m		
Barrera / Esponsor		Barrera Epoxica Grts P /150m		
Esmalte / Esponsor		Esmalte Poliuretano Azul Trafico Ral 5017 P /150m		
Tratamiento Superficial		SSPC-SP6		
Pertenece al Sistema de Resistencia Sismica (SRS)				
# Rev.	Descripcion de Revision	Tip	Fecha	Revis

OBRA :24062D
Planta Draga 21 Mineros
CONTIENE : ENSAMBLE DE COLUMNA

CALCULO	Santiago Ramirez	FECHA	17.02.2025
DETALLADO	Juan Diego Piedrahita	MEASAS EN	mm
MODELO	Julio C. Ospina R	ESCALA	INDICADAS
DIBUJO	Jhon Jairo O.	REVISO	REV. NÚM.

PLANO Nº: 24062DF389 K-87