

| Mark | Profil | Aantal | Lengte (m) | Gewicht (kg) |
|---------------|--------|-----------|--------------|---------------|
| SW1 | L80/8 | 1 | 7399 | 40,9 |
| SW2 | L80/8 | 3 | 8609 | 29,2 |
| SW3 | L80/8 | 1 | 7035 | 36,9 |
| SW10 | L80/8 | 1 | 7105 | 36,9 |
| SW22 | L80/8 | 1 | 7410 | 40,9 |
| SW23 | L80/8 | 1 | 3670 | 20,3 |
| SW1 | L80/8 | 2 | 2760 | 20,8 |
| SW8 | L80/8 | 1 | 7601 | 42,0 |
| SW10 | L80/8 | 1 | 3545 | 20,1 |
| SW11 | L80/8 | 1 | 1785 | 40,8 |
| SW12 | L80/8 | 1 | 3660 | 20,2 |
| SW1 | L80/8 | 2 | 4748 | 46,5 |
| SW2 | L80/8 | 1 | 1459 | 6,0 |
| SW3 | L80/8 | 1 | 1724 | 9,5 |
| SW6 | L80/8 | 2 | 5776 | 51,7 |
| SW7 | L80/8 | 1 | 1864 | 10,4 |
| SW8 | L80/8 | 2 | 4684 | 45,9 |
| SW9 | L80/8 | 2 | 3096 | 32,3 |
| SW10 | L80/8 | 1 | 2243 | 12,4 |
| SW12 | L80/8 | 1 | 1026 | 16,1 |
| SW13 | L80/8 | 1 | 4628 | 25,6 |
| SW14 | L80/8 | 1 | 4777 | 26,4 |
| SW15 | L80/8 | 1 | 7123 | 41,5 |
| SW16 | L80/8 | 1 | 7641 | 42,2 |
| SW17 | L80/8 | 2 | 1121 | 11,0 |
| SW18 | L80/8 | 2 | 2356 | 32,9 |
| SW19 | L80/8 | 1 | 4846 | 27,3 |
| SW20 | L80/8 | 1 | 8346 | 46,1 |
| SW21 | L80/8 | 1 | 8340 | 46,1 |
| SW22 | L80/8 | 1 | 5133 | 28,3 |
| SW24 | L80/8 | 2 | 2578 | 25,3 |
| SW25 | L80/8 | 1 | 1031 | 10,1 |
| SW1 | L80/8 | 2 | 6993 | 36,6 |
| SW2 | L80/8 | 2 | 2849 | 32,9 |
| Totaal | | 46 | 21046 | 1383,3 |

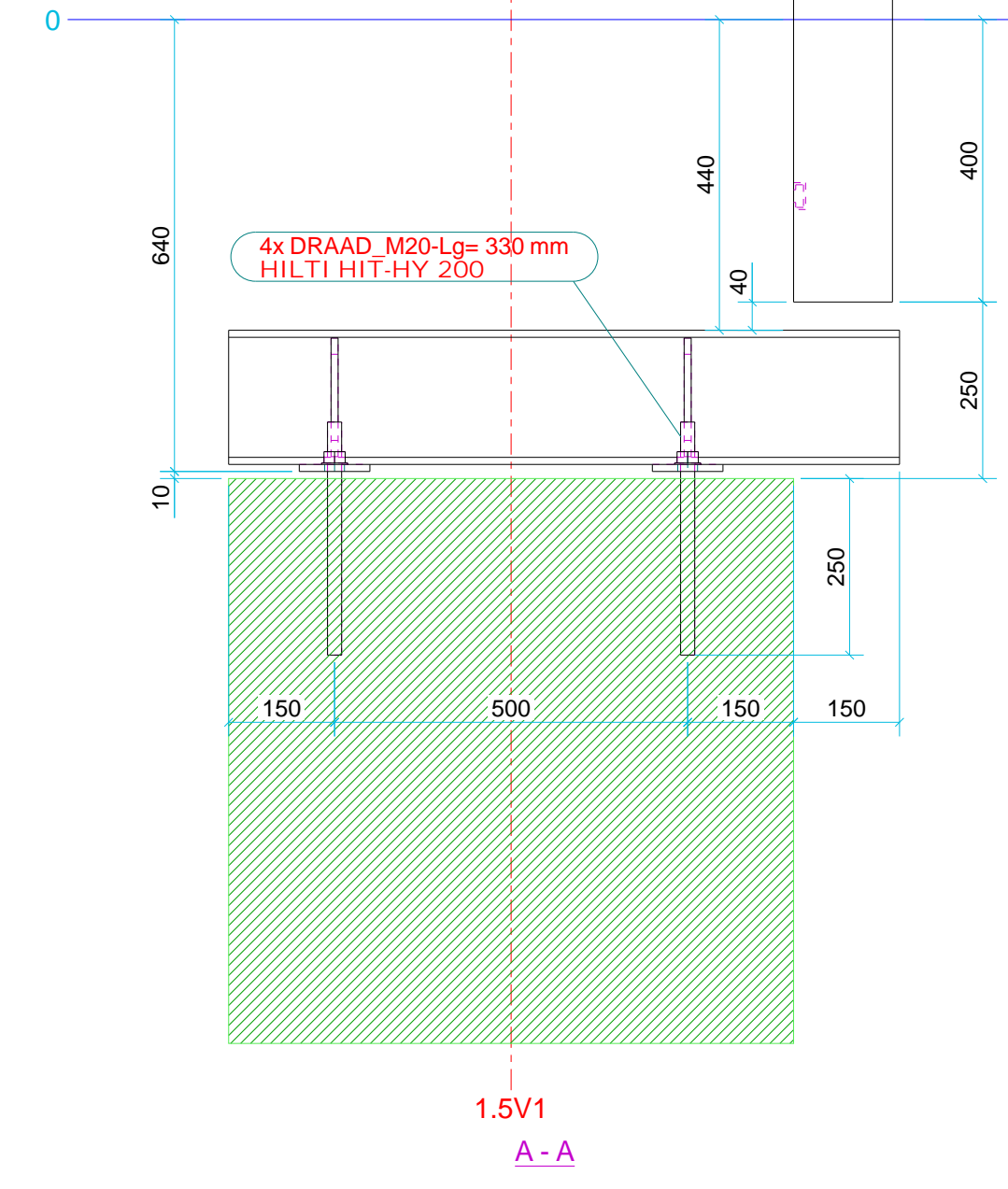

| Mark | Profil | Aantal | Lengte (m) | Gewicht (kg) |
|---------------|---------------------|-----------|---------------|-----------------|
| BK2 | 80/700 | 1 | 4730 | 5719,2 |
| BK3 | 80/700 | 1 | 4380 | 5143,0 |
| BK4 | 80/700 | 1 | 4980 | 5146,6 |
| BK5 | 80/700 | 1 | 4980 | 5860,8 |
| BK6 | 80/700 | 1 | 4980 | 5860,8 |
| BK7 | 80/700 | 1 | 4980 | 5860,8 |
| BK8 | 80/700 | 1 | 4980 | 5860,8 |
| BK9 | 80/700 | 1 | 4980 | 2943,7 |
| BK10 | 80/700 | 1 | 4980 | 4866,3 |
| BK11 | 80/700 | 1 | 4980 | 5860,8 |
| BK12 | 80/700 | 1 | 4980 | 5860,8 |
| BK13 | 80/700 | 1 | 4980 | 5860,8 |
| BK14 | 80/700 | 1 | 4980 | 4966,3 |
| BK15 | 80/700 | 1 | 4980 | 2943,7 |
| BK16 | 80/700 | 1 | 4980 | 5860,8 |
| BK17 | 80/700 | 1 | 4980 | 5860,8 |
| BK18 | 80/700 | 1 | 4980 | 5860,8 |
| BK19 | 80/700 | 1 | 5298 | 9280,6 |
| BK20 | 80/700 | 1 | 5298 | 9280,6 |
| BK21 | 80/700 | 1 | 5398 | 5794,6 |
| BK22 | 350/350 | 1 | 5548 | 1611,9 |
| BK24 | 80/700 | 1 | 5548 | 8545,6 |
| BK25 | 80/700 | 1 | 5548 | 6413,6 |
| BK26 | 80/700 | 1 | 5548 | 6413,6 |
| BK27 | 80/700 | 1 | 5548 | 6805,1 |
| BK28 | 550/550 | 1 | 3368 | 2476,2 |
| BK29 | 550/550 | 1 | 3368 | 2476,2 |
| BK30 | 550/550 | 1 | 3368 | 2476,2 |
| BK31 | 550/550 | 1 | 3368 | 2626,2 |
| BK32 | 550/550 | 1 | 3768 | 2776,4 |
| BK33 | 550/550 | 1 | 3768 | 2776,4 |
| BK34 | 550/550 | 1 | 3768 | 2776,4 |
| BB1(7) | 800/800 | 1 | 13620 | 16338,8 |
| BB2(7) | BL_800-1400-200-320 | 1 | 7810 | 19054,1 |
| BB3(7) | BL_800-1400-200-320 | 1 | 7760 | 18841,2 |
| BB4(7) | BL_800-1400-200-320 | 1 | 14215 | 30423,0 |
| BB5(7) | BL_800-1400-200-320 | 1 | 10160 | 14850,9 |
| BB6(7) | BL_800-1400-200-320 | 1 | 6420 | 12116,5 |
| BB7(7) | BL_800-1400-200-320 | 1 | 8520 | 12420,1 |
| BB8(7) | BL_800-1400-200-320 | 1 | 9970 | 14226,3 |
| BB9(7) | BL_800-1400-200-320 | 1 | 8340 | 13425,9 |
| BB10(7) | 550/550 | 1 | 7110 | 6267,7 |
| BB11(7) | 550/550 | 1 | 6356 | 5651,6 |
| BB12(7) | 350/350 | 1 | 6045 | 2637,9 |
| BB13(7) | 580/580 | 1 | 4690 | 3066,5 |
| BB14(7) | 580/580 | 1 | 4672 | 3066,2 |
| BB15(7) | 580/580 | 1 | 4610 | 3321,1 |
| BB16(7) | 580/580 | 1 | 5445 | 7096,4 |
| BB17(7) | 550/550 | 1 | 7080 | 7060,2 |
| BB18(7) | 550/550 | 1 | 6395 | 6363,0 |
| BB19(7) | 550/550 | 1 | 6865 | 4959,4 |
| BB20(7) | 550/550 | 1 | 4610 | 3713,6 |
| BB21(7) | BL_450-1420-250-620 | 1 | 6925 | 7410,8 |
| Totaal | | 32 | 152120 | 156861,4 |

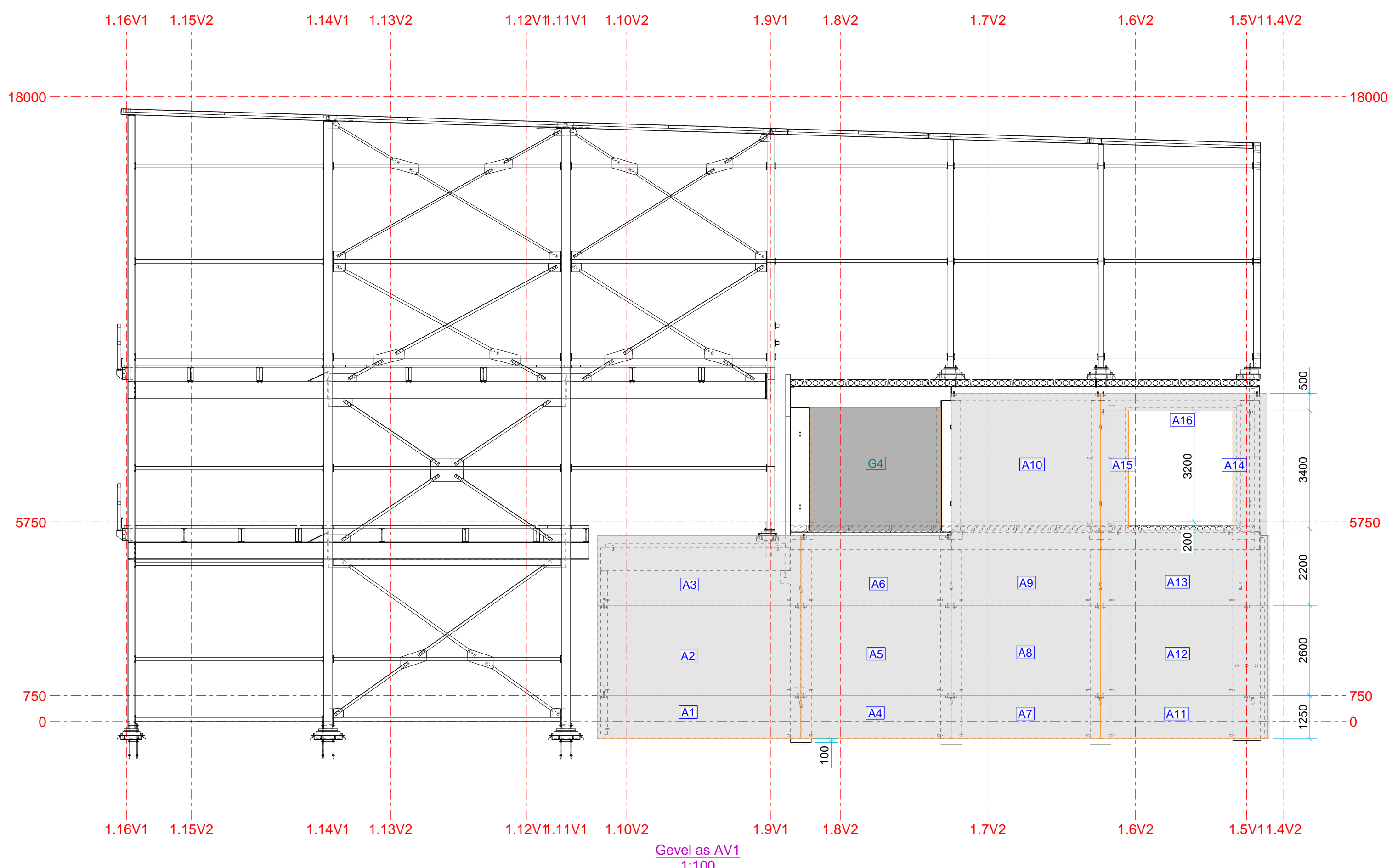
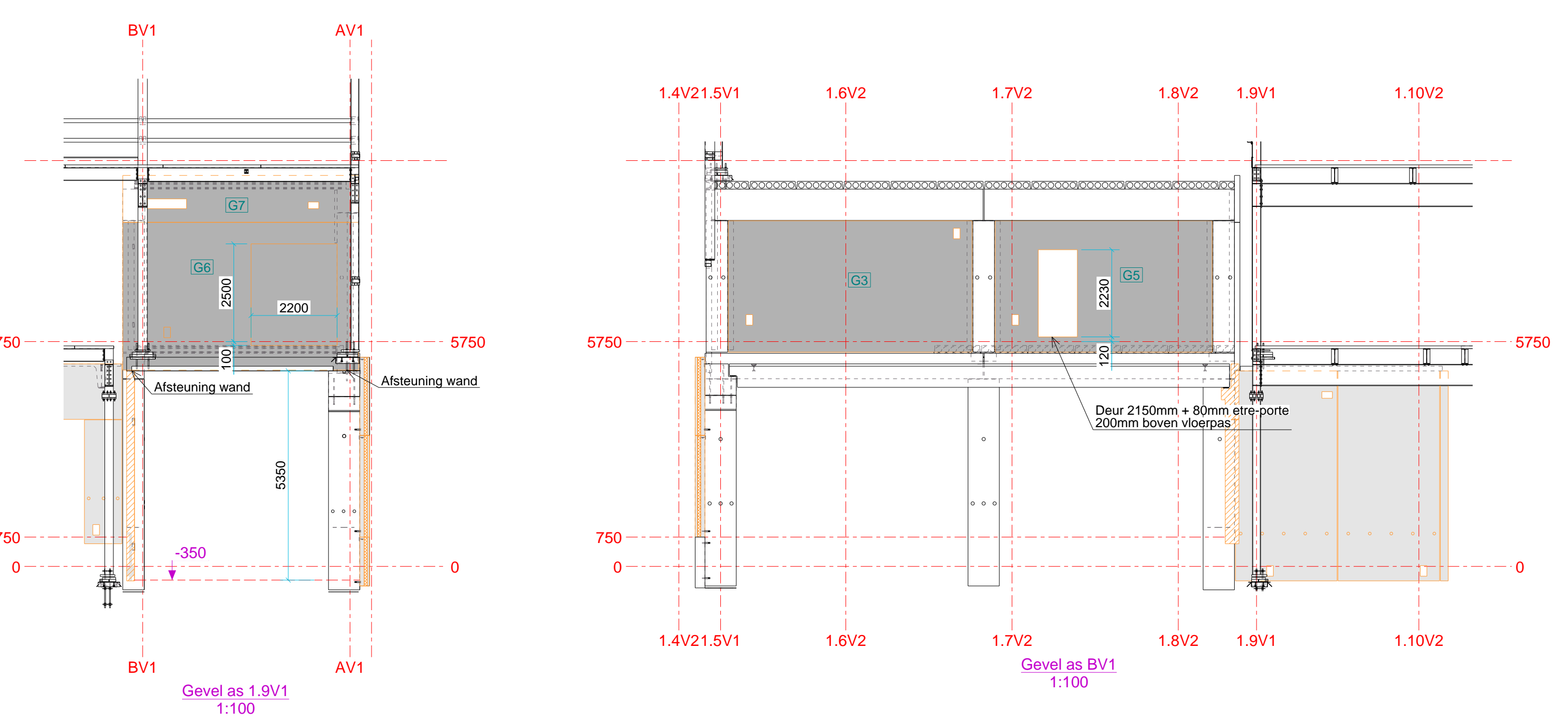

**BEEUWSAERT
CONSTRUCT**

Nijverheidslaan 3, 8880 Ledegem
Tel: +32(0)56143.18.43 - Fax: +32(0)56141.28.48
e-mail: info@beeuwsaert-construct.be

Tekenaar alg. plan: Twiggij Verbeke
Mail: twiggij@beeuwsaert-construct.be
Tekenaar structuur: Twiggij Verbeke
Mail: twiggij@beeuwsaert-construct.be

Werfleider: Kevin Syryn
Mail: kevin@beeuwsaert-construct.be
Tel: 0468 18 27 20

Gegevens:
Fundering: C30/37
Structuur: Beton
- Galva: Nee
- Gevelrd: Ja
- RAL kleur: 7035
- RI vert: - RI door Beeuwsaert:
- RI door klant:
Staaldeck: nvt
Poneren:
Schriftpwark:

BOUWHEER:
A-Construct
Tel.: GSM:
Fax:
Mail:

BOUWPLAATS:
Nijverheidslaan 6
8560 Wevelgem

DOSSIERNUMMER:
25-2865A Highfrost

Gegevens architect:

Tel.: GSM:
Fax:
Mail:

Voor akkoord bouwheer:
Datum:
Handtekening:

| WIJZIGINGEN: | DATUM: |
|----------------------------------|------------|
| A. Toevoegen brandwand zone ATLS | 27.10.2025 |
| | |
| | |
| | |
| | |

| GEVEL LAADKADE + GEVELS ZONE ATLS | DATUM: |
|-----------------------------------|------------|
| | 27.10.2025 |
| | |
| | |
| | |
| | |

Deze tekening blijft onze eigendom en mag zonder onze schriftelijke toestemming niet worden gepubliceerd, of aan derden ter inzage worden gegeven, noch voor gebruik in andere dan de bestaande situaties die op het plan vermeld staan. Bij onderekeningen van dit plan vertaalt de klant zich akkoord met het uitvoeringsplan.

27.10.2025 10:54:19